



CODA
- ESTATES -

OFFERS OVER

£190,000

15 VILLAGE GREEN, LENNOXTOWN G66 7BD

Beautifully maintained and presented throughout this property is located with a quiet residential estate, overlooking the village green. The mid-terraced property benefits from 3 bedrooms, modern kitchen, stylish bathroom and additional downstairs w/c.

The garden ground has been professional landscaped providing an enviable outdoor space. EER - C

- *** Pristine Family Home ***
- Immaculately Presented Throughout
- Idyllic Residential Location
- Spacious Lounge



FULL DESCRIPTION

Nestled within this prestigious, modern development, this three bedroom terraced property has been lovingly maintained and presented by the current owners. The attractive home forms part of a small development by McTaggart Meikle (2009) and as the address suggests, enjoying a beautiful outlook across a central village green taking in a wide spectrum of the Campsie Fells beyond.

Accommodation is presented over two levels. The ground floor comprises welcoming reception hall and staircase to the upper landing, downstairs W/C, contemporary kitchen with oven, gas hob and extractor hood and a bright and spacious lounge with glazed door to the magnificent rear garden. Upstairs, there are two generous double bedrooms, one with in-built wardrobes and a further well-proportioned bedroom. A stylish bathroom with three piece suite, quality sanitary ware and tiling completes the home. The property further benefits from gas central heating, double glazing and generous storage throughout. The current owners have professionally landscaped the rear garden, providing an ideal area for relaxing or entertaining.



Room Dimensions

Lounge - 5.00m x 3.80m

Kitchen - 3.70m x 2.70m

w/c - 2.00m x 0.90m

Master Bedroom - 3.90m x 2.70m

Bedroom 2 - 3.00m x 2.20m



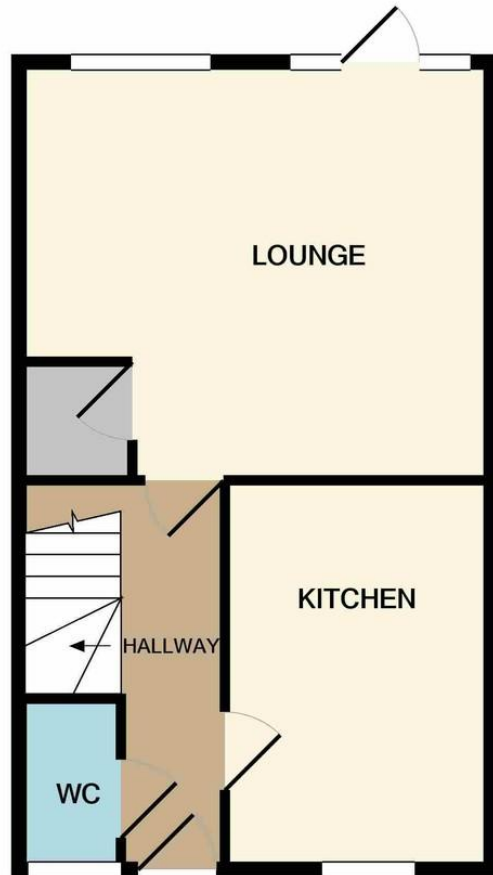

GROUND FLOOR

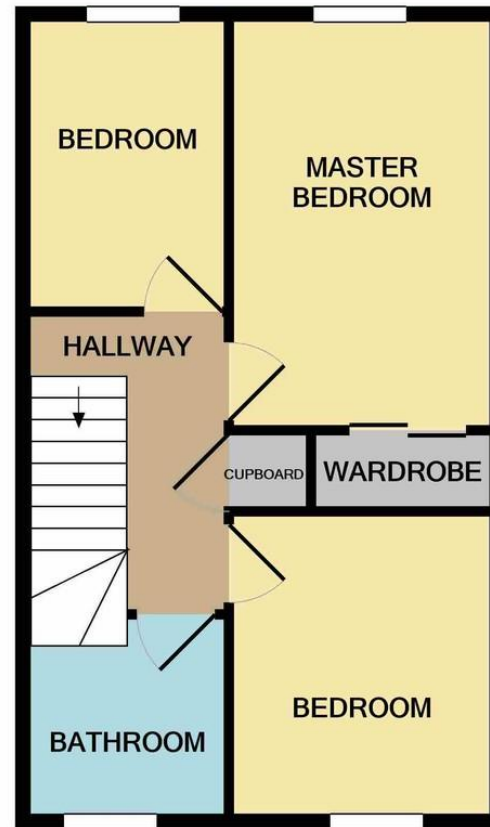

1ST FLOOR

Whilst every attempt has been made to ensure the accuracy of the floor plan contained here, measurements