

CODA
- ESTATES -

OFFERS OVER

£159,995

56 FARM WYND, WOODILEE VILLAGE G66 3RE

Fabulous second floor apartment within a small development of similar properties. Finished and presented to an exceptional standard throughout this property will appeal to a number of buyers. Contemporary accommodation with residence parking, loft space, spectacular views and secure door entry. Early viewing is strongly recommended. EER - C

- *** Stylish Second Floor Luxury Apartment ***
- Well Maintained and Presented Throughout
- Spacious Lounge and Well Appointed Kitchen



FULL DESCRIPTION

Immaculate, two bedroom second floor apartment within a small block of similar properties, situated in the extremely popular and sought-after Woodilee Village.

This well-appointed and tastefully presented apartment, will undoubtedly have wide appeal, ranging from the first time buyer to those considering down-sizing or an investor looking for a buy-to-let opportunity. With a top floor position, the property boasts a stunning open outlook and benefits from generous loft space. Located within a quiet pocket, early viewing is recommended for full appreciation of the apartment

Accommodation comprises: Entrance hall with two built-in storage cupboards and door intercom entry hand set. Spacious lounge/dining room with large window to the front providing spectacular views towards the Campsie Fells. Contemporary kitchen with a number of built in appliances, ample base and wall mounted units and two spacious double bedrooms, both situated to the rear, Completing the apartment is the stylish bathroom with three piece white suite including bath with thermostatic shower over. This attractive apartment is further enhanced by gas central heating, PVC double glazed window frames, allocated residents parking space, communal visitor parking and well maintained communal areas and grounds.

Presented in true walk in condition, located on the outskirts of Lenzie; Farm Wynd is a residential area within easy reach of all local amenities. Lenzie





Location

%full_location%

Home Report Available on Request

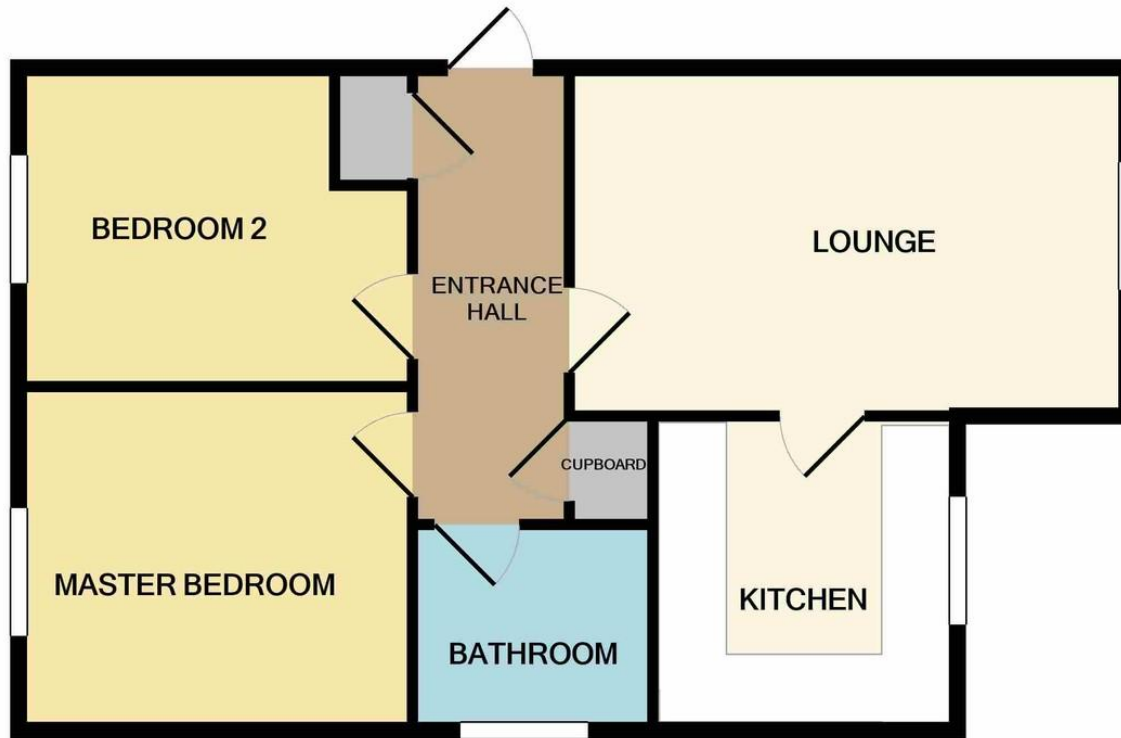

TOTAL APPROX. FLOOR AREA 575 SQ.FT. (53.4 SQ.M.)

Whilst every attempt has been made to ensure the accuracy of the floor plan contained here, measurements of doors, windows, rooms and any other items are approximate and no responsibility is taken for any error, omission, or mis-statement. This plan is for illustrative purposes only and should be used as such by any prospective purchaser. The services, systems and appliances shown have not been tested and no guarantee as to their operability or efficiency can be given

Made with Metropix ©2021