



Silver Mists Park

Ringwood, Dorset, BH24



0800 954 1288

sales@sellmygroup.co.uk



£290,000

Ringwood, Dorset, BH24

This Pemberton park home is perfect for those looking for a detached, easy to maintain, bungalow style retirement property. The home has a spacious living area which is wonderfully light and airy thanks to the homes large windows.

Set in stunning surroundings, ideal for making the most of the New Forest and Moors Valley Country Park which both offer wonderful walking trails. You will also find it incredibly convenient to enjoy award winning beaches and the stunning Dorset and neighbouring Hampshire countryside. Walk in the footsteps of your Neolithic ancestors at Stonehenge, one of the wonders of the world and the best-known prehistoric monument in Europe.

Nearby amenities:

Doctors Surgery - 3 miles

Nearest Shop - 1.1 miles

Post Office - 2.5 miles

Nearest Supermarket - 5 miles

Nearest Train Station - 4 miles

Nearest Hospital - 5.5 miles

- Brand new home
- Community Living
- Home Exchange scheme
- Fully Fitted Kitchen
- Fully Furnished
- Luxury 2 Bed Park Bungalow
- Outstanding Location
- Over 45's
- Pet-friendly

2 x  2 x 

**100% Market Value Part
Exchange with
Quickmove Properties**

Home exchange example:

Value of your existing home....£300,000

Price of new park home.....£225,000

Cash for you to enjoy.....£75,000

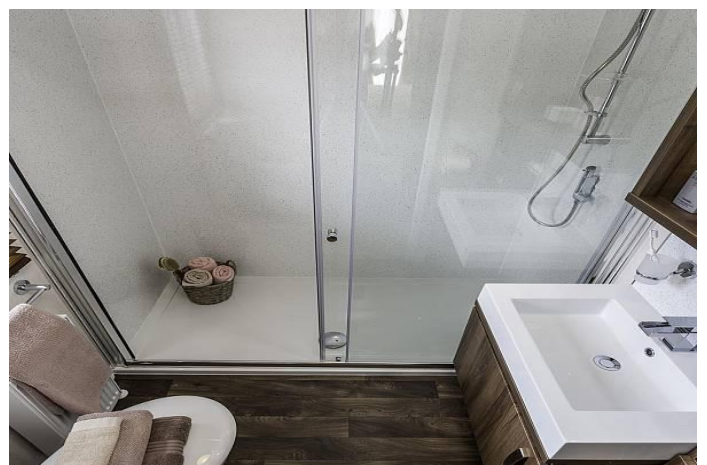

Please note: Stock images have been used, the home on site may vary.

Floor Plan

Glendale Lodge 44ft x 22ft • 2 bedroom

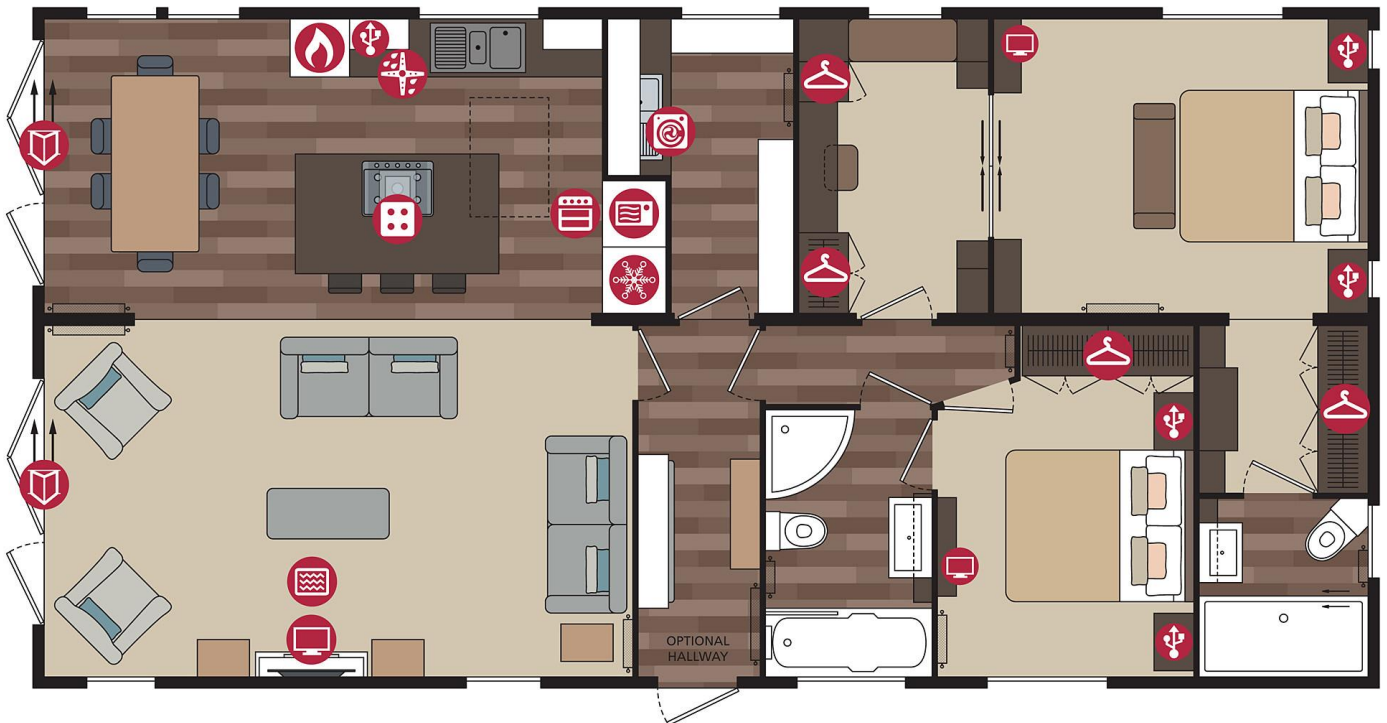

CONTACT DETAILS

0800 954 1288

sales@sellmygroup.co.uk

