

Windermere

£650 pcm

17 Alexandra Court
Ellerthwaite Road
Windermere
LA23 2PR

Unfurnished 1 bedroom first floor apartment recently refurbished to a high standard within a quite residential block for over 50's

- 1 Double Bedroom
- Modern Kitchen
- Modern shower room
- Unfurnished
- Recently upgraded
- Available for residents over 50
- Laundry room on site
- Guest room available for family and friend visits
- Council Tax Band B
- Available Now

Property Ref: WR854





Kitchen

Location: Situated approximately half a mile from Windermere village, therefore convenient for all amenities. To find Alexandra Court follow Lake Road out of Windermere towards Bowness, turn left into Ellerthwaite Road, then turn right at the fire station. Alexandra Court is the first turning on the left-hand side. No parking available in the grounds.

Services: Mains Electric and water supply

Viewings: Strictly by appointment with Hackney & Leigh

Applying for a Tenancy: Tenancy Application Forms are available from any Hackney & Leigh office. Each application must be accompanied by payment of a Holding Deposit (one weeks rent) payable either by debit or credit card. This is paid to reserve the property and will be held by us for a period of 15 days unless we agree otherwise. All adults of 18yrs and over who will be living at the property will be asked to provide evidence of nationality and identity to validate their "Right to Rent" under the Immigration Act 2014.

Referencing: All applicants will be required to provide satisfactory references eg: employer, current landlord and two-character references. For the self-employed, a reference from your accountant or solicitor will be required. A credit reference will be obtained for each applicant. Acceptance of references and the offer of a tenancy is at our discretion.

The Tenancy: The property will be let on a fixed term Assured Shorthold Tenancy for a minimum period of 6 months. There is no automatic provision within the lease for early termination and the tenant is responsible for rent for the whole term.

The tenant is responsible for Council Tax for the tenancy period and for all charges for water and sewerage, gas, electricity, telephone or other utility/service providers' charges supplied to the tenant during the tenancy.

Deposit & Rent: The successful Tenant will be required to pay a deposit (equal to a maximum of 5 weeks rent depending on the property). This will be held in accordance with the Tenancy Deposit Scheme Regulations and will be re-fundable at the end of the tenancy, subject to the property being left in a satisfactory condition. Rent is payable on or by each rent day and is payable by standing order. One month's rent in advance PLUS the deposit, is required at the time of signing the agreement. Please Note: It is NOT possible to use the deposit as rent for the final month.

Insurance: It is the Tenants' responsibility to insure their own possessions. Tenants are strongly advised to take out accidental damage cover in respect of the Landlord's property and contents.

Energy Performance Certificate: The full Energy Performance Certificate is available on our website www.hackney-leigh.co.uk and also at any of our offices.

How to rent: Prospective tenants are advised to read the government's leaflet which is available here:

For a Viewing Call 015394 40060



Lounge



Bedroom

Alexandra Court, Ellerthwaite Road, Windermere, LA23

Approximate Area = 462 sq ft / 43 sq m

For identification only - Not to scale

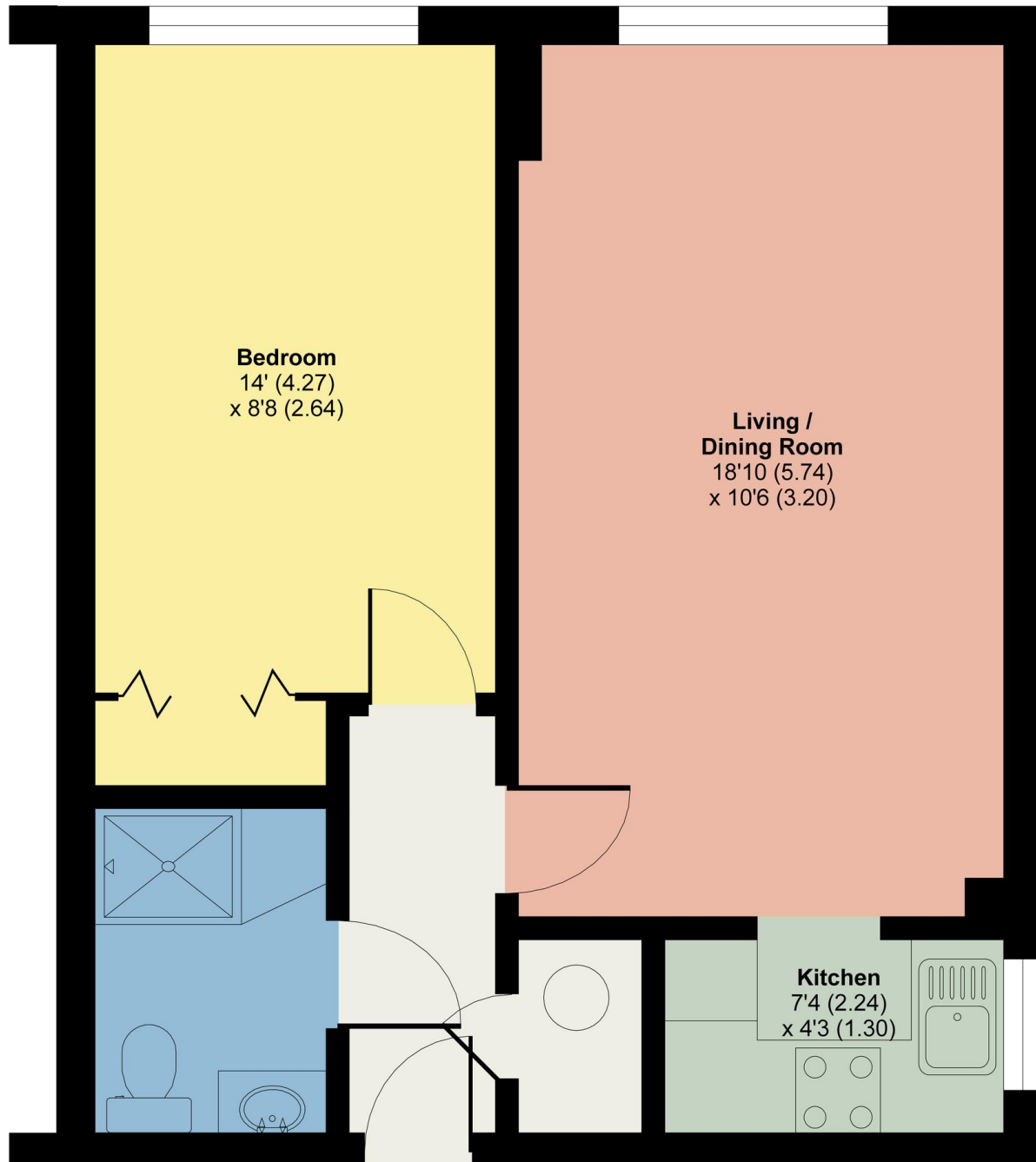

Ellerthwaite Road Windermere - Ref: WR854

Property particulars and appointments to view are provided on the understanding that all negotiations are conducted through Hackney and Leigh Ltd. This information is provided for general guidance only. It does not form part of any contract or agreement and no guarantee of accuracy is given. Prospective tenants should make their own enquiries as to the suitability or otherwise of the property. No responsibility can be accepted for any loss or expense incurred in viewing or in the event of a property being let or withdrawn. Please contact us to confirm the property's availability, especially if travelling some distance.