



 2
Bedrooms

 1
Bathroom





****75% SHARED OWNERSHIP****

*****OVER 55's*****

GROUND FLOOR TWO BEDROOM RETIREMENT APARTMENT SITUATED ON A QUIET LOCATION!!

Conveniently located to all local amenities, Stretford Shopping Mall with new food hall and Urmston Town Centre, with an array of cafes and shops and easily accessible on a reliable bus route. This well-presented two bedroom flat briefly comprising: - Entrance Hall with stairs leading to the spacious lounge, fitted kitchen, Master bedroom and second bedroom (currently used as a dining room) and a bathroom. The property is double glazed and warmed by gas central heating.

Communal gardens and car parking.

Entrance hall 5.58m x 2.38m

Front door opening to a light and airy hallway with storage cupboard and single panel radiator.

Lounge 4.1m x 3.5m

Double glazed square bay window to rear elevation. Feature fireplace. TV Point, Ceiling coving. Double panel radiator. Open to: -

Kitchen 3.89m x 1.65m

Double glazed window to rear elevation. Fitted with a range of wall and base units with contrasting worktops. Space for gas cooker, undercounter fridge/freezer and plumbed for washing machine. Single drainer stainless steel sink unit. Wall mounted boiler and extractor fan. Double panel radiator. Lino flooring.

Bedroom One 4.1m x 3.9m

Two double glazed windows to front and side elevation. Double panel radiator. Carpet.

Bathroom 1.8m x 1.65m

Double glazed frosted window. White bathroom suite comprising: - panel bath, pedestal wash hand basin and WC. Double panel radiator. Carpet

Bedroom Two 3.24m x 2.41m Currently used as a Dining Room

Double glazed window to front elevation. Single panel radiator. Carpet.

Externally: - Parking available and communal garden.

ENTRANCE FLOOR

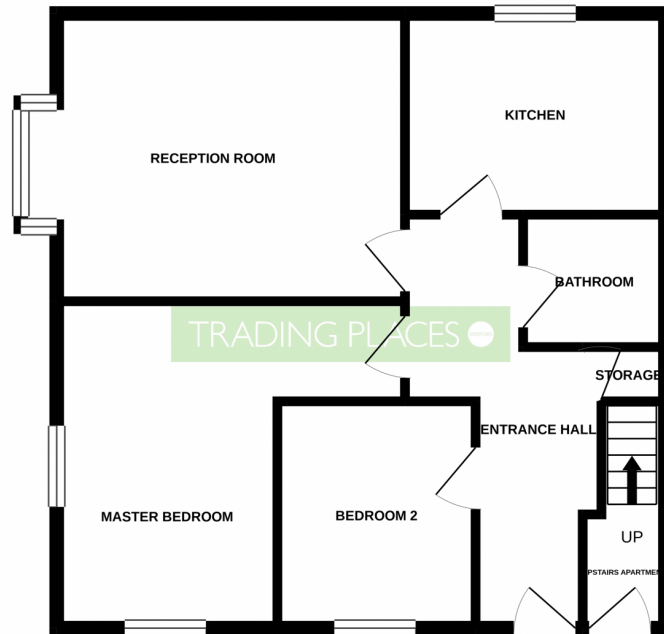

Whilst every attempt has been made to ensure the accuracy of the floorplan contained here, measurements of doors, windows, rooms and any other items are approximate and no responsibility is taken for any error, omission or mis-statement. This plan is for illustrative purposes only and should be used as such by any prospective purchaser. The services, systems and appliances shown have not been tested and no guarantee as to their operability or efficiency can be given.
Made with Metreapp 10/2021

