



35 Victoria Road  
Romford  
Essex  
RM1 2LH

**Tel:** 01708 504455

**Email:** sales@gbpestates.co.uk

**Website:** www.gbpestates.co.uk



## Sydenham Close, Romford **£625,000** Freehold



**\*\*\*CHAIN FREE\*\*\*** This four bedroom detached extended family home is located on a quiet sought after cul de sac area of Romford. With over 1600 sq ft of living space this property has many pluses which include a good size kitchen / diner, utility room / cloakroom, study / 5th bedroom and ensuite to main bedroom. There is plenty of storage space with fitted wardrobes and a good size garage. Property also has off street parking. Buses to local routes, Romford Station for Liverpool Street, Stratford and the well awaited Cross Rail to open soon. Access for A12, A127 and M25. Romford Town has a leisure centre, The Brewery has array of restaurants, cinema, bowling, shops and the famous Romford Market.

- **FOUR / FIVE BEDROOMS**
- **DETACHED**
- **CUL DE SAC LOCATION**
- **GARAGE**
- **OFF STREET PARKING**
- **CHAIN FREE**
- **GOOD SIZE PROPERTY**
- **RAPHAELS PARK AND LODGE FARM PARK**
- **ROMFORD TOWN CENTRE**
- **BUSES TO LOCAL ROUTES**



**ACCOMMODATION**

**HALLWAY**

**UTILITY ROOM / W.C.** 10' 7" x 7' 5" (3.23m x 2.26m)

**BEDROOM 3 / STUDY** 12' 6" x 7' 6" (3.81m x 2.29m)

**LOUNGE** 21' 5" x 13' 10" (6.53m x 4.22m)

**KITCHEN / DINING ROOM** 21' 8" x 9' 9" (6.6m x 2.97m)

**LANDING**

**BEDROOM ONE** 13' 0" x 11' 1" (3.96m x 3.38m)

**ENSUITE**

**BEDROOM TWO** 10' 9" x 9' 8" (3.28m x 2.95m)

**BEDROOM FOUR** 10' 2" x 8' 4" (3.1m x 2.54m)

**BEDROOM FIVE** 8' 6" x 7' 6" (2.59m x 2.29m)

**BATHROOM**

**GARDEN** 34'9" x 22'2" (10.58m x 6.75m)

**GARAGE** 17'3" x 16'1" (5.27m x 4.90m)

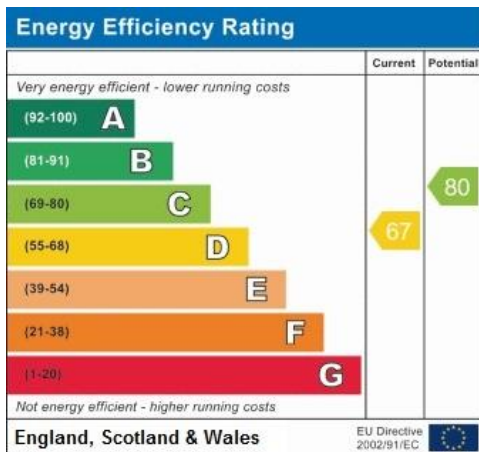
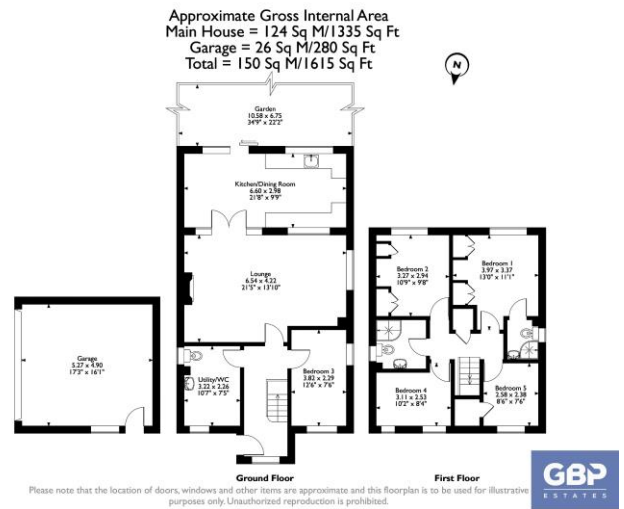

DISCLAIMER: These particulars, whilst believed to be accurate are set out as a general outline only for guidance and do not constitute any part of an offer or contract. Intending purchasers should not rely on them as statements or representation of fact, but must satisfy themselves by inspection or otherwise as to their accuracy. We have not carried out a detailed survey nor tested the services, appliances and specific fittings. Room sizes should not be relied upon for carpets and furnishings. The measurements given are approximate. No person in this firm's employment has the authority to make or give any representation or warranty in respect of the property.