



Withany,

Heath Rise, Virginia Water, Surrey, GU25 4AX.

BARTON · WYATT

Withany,

Heath Rise, Virginia Water, Surrey. GU25 4AX.

Set in a quiet location on the Wentworth Estate, this modern seven-bedroom home offers a wonderful layout and ultimate privacy.

- ◇ Located on the private Wentworth Estate
- ◇ Over 6000sqft of accommodation set behind a private gate
- ◇ Gardens more than half an acre
- ◇ Open plan modern layout with luxury fittings
- ◇ Long driveway leading up to the property
- ◇ Manicured gardens to the front and rear of the property
- ◇ Six-bedroom suites and annexe bedroom
- ◇ Quiet location with good privacy
- ◇ Triple garage with plentiful parking
- ◇ Offered with no onward chain

Situation

The Wentworth Golf Club and the picturesque shopping parades of Virginia Water, with its excellent shops for day-to-day needs, restaurants and mainline railway station with a fast service of trains to Waterloo in 42 minutes are within easy walking distance. For the weekly household shop there is an excellent Waitrose in Sunningdale and for more extensive shopping facilities, the towns of Windsor, Guildford and Kingston are all close at hand. Junction 13 of the M25 is just 3.5 miles away giving access to London, Heathrow, and the motorway network.

Other than the world-renowned Wentworth Club, country clubs abound the area such as Foxhills, Queenwood, Sunningdale and the Royal Berkshire. Delightful walks can be enjoyed around Virginia Water Lake which leads up to the Polo at Smiths Lawn, adjacent to Savill Gardens and Windsor Great Park beyond for riding. The area is also very well catered for by a huge choice of private prep schools, as well as two international schools, ACS in Egham and TAS IS in Thorpe.

Fixtures and Fittings

Carpets, curtains and light fittings available by separate negotiation.

Services

The property has mains gas, electricity, water and mains drainage.

Local Authority

Runnymede Borough Council – 01932 828383

Energy Rating

B83





Heath Rise, Virginia Water, GU25

Approximate Area = 5899 sq ft / 548.0 sq m (includes garage)

Limited Use Area(s) = 134 sq ft / 12.4 sq m

Outbuilding = 37 sq ft / 3.4 sq m

Total = 6070 sq ft / 563.9 sq m

For identification only - Not to scale

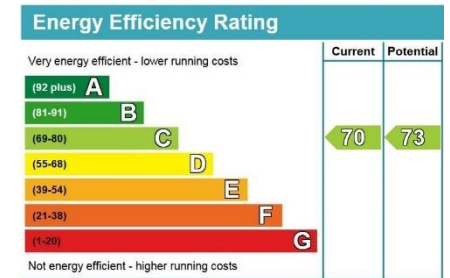
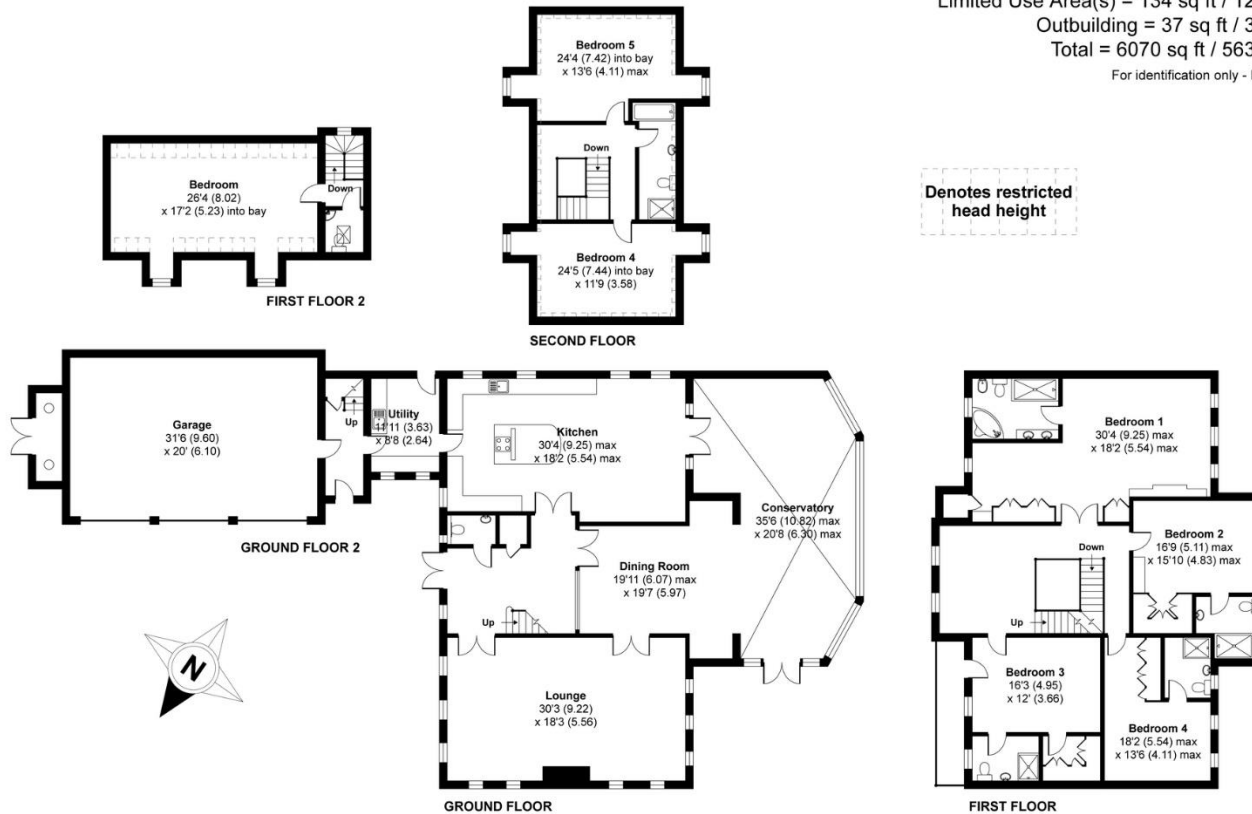

RICS Certified Property Measurer
 Floor plan produced in accordance with RICS Property Measurement Standards incorporating International Property Measurement Standards (IPMS2 Residential). © n\che.com 2021
 Produced for Barton Wyatt Ltd. REF: 738722



The Estate Office, 2 Station Approach,
 Virginia Water, Surrey, GU25 4DL
 Tel: 01344 843000
 Email: homes@bartonwyatt.co.uk
 www.bartonwyatt.co.uk



Important Information: These particulars are for guidance only. They are prepared and issued in good faith and are intended to give a fair summary of the property. Any description or information should not be relied on as a statement or representation of fact of that the property or its services are in good condition. The photographs show only certain parts of the property at the time they were taken. Any areas, measurements or distances given are approximate only. Any reference to alterations to or us of, any part of the property is not a statement that any necessary planning, building regulations or other consent has been obtained. These matters must be verified by an intending purchaser. All statement contained in these particulars in relation to the property are made without responsibility of Barton Wyatt or its clients. Neither Barton Wyatt (nor any joint agents) nor any of their employees has any authority to make or give any representation or warranty whatsoever to the property.