



CODA
- ESTATES -

OFFERS OVER

£139,995

1 KILPATRICK COURT, STEPPS G33 6FG

Stunning ground floor 2 bedroom apartment, located within a highly desirable development close to all local amenities.

The current owners have maintained and presented to an impeccable standard throughout making early viewing essential. Home Report available on request. EER - C

- *** Immaculate Ground Floor Apartment ***
- 2 Bedrooms - Master Ensuite
- Spacious Lounge
- Dining Kitchen



FULL DESCRIPTION

CODA Estates are delighted to offer this two bedroom ground floor apartment to the open market. Located within a highly desirable pocket area of the village close to all local amenities. This property would ideally suit first time buyers looking to get onto the property ladder and also investors looking to start or add to an existing portfolio. Early viewing is strongly recommended to avoid disappointment.

The property is in pristine condition, maintained and presented to an exceptional standard by the current owners. The property comprises: Reception hall, spacious lounge, modern dining kitchen, contemporary bathroom and two double bedrooms with en-suite in the master.

The property is further enhanced with double glazing, gas central heating, door entry system, communal gardens and allocated parking.

Room Dimensions

Entrance Hallway

Lounge - 4.65m x 3.50m

Kitchen - 3.50m x 3.10m

Master Bedroom - 4.80m x 3.30m

Ensuite - 2.00m x 1.70m

Bedroom 2 - 3.00m x 3.00m

Bathroom - 2.45m x 1.70m



Location

Kilpatrick Court is a popular development, set just off Kilpatrick Drive. Stepps has an excellent range of amenities including local shops and mainline Glasgow railway station within walking distance.



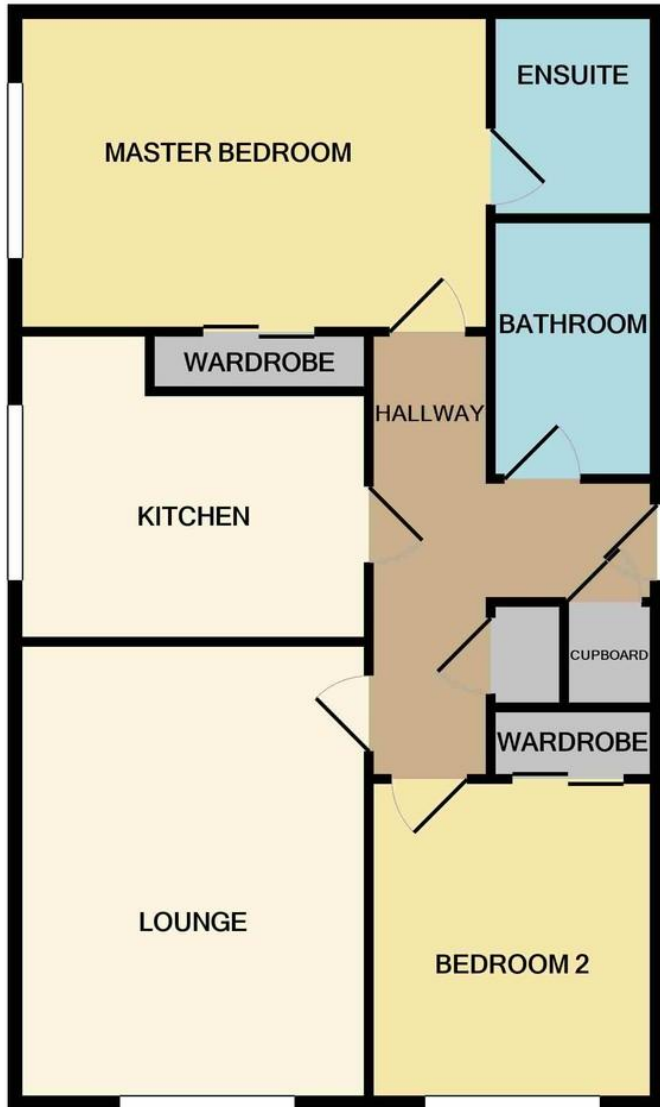

TOTAL APPROX. FLOOR AREA 766 SQ.FT. (71.2 SQ.M.)