

Meadoway

Cheltenham GL52 8NB





Meadoway, Bishops Cleeve, Cheltenham GL52 8NB

Located at the end of a quiet cul-de-sac this three bedroom, semi-detached property is located in the sought after location of Bishops Cleeve, making it the perfect family home. The accommodation comprises of:- a modern open plan kitchen / diner and living area with built in appliances, utility room with ample storage cupboards and a downstairs WC. Upstairs consists of three bedrooms and a modern family bathroom. The property further benefits from a large garden with patio area, double glazing, gas-fired central heating and a garage. On the market with no onward chain.





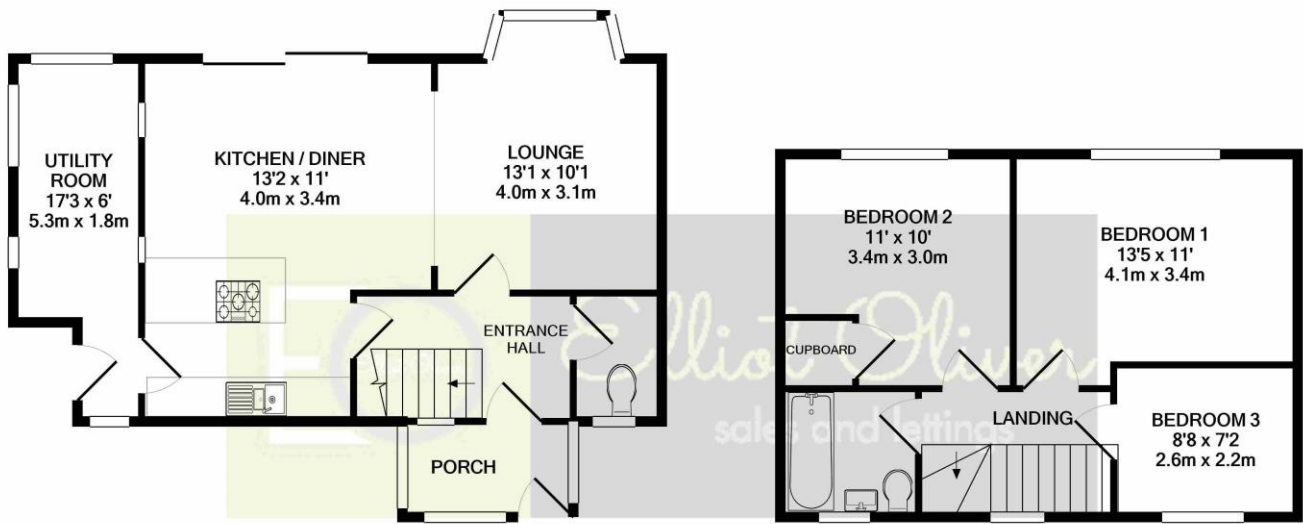

GROUND FLOOR
APPROX. FLOOR
AREA 554 SQ.FT.
(51.5 SQ.M.)

1ST FLOOR
APPROX. FLOOR
AREA 415 SQ.FT.
(38.6 SQ.M.)

TOTAL APPROX. FLOOR AREA 970 SQ.FT. (90.1 SQ.M.)

Whilst every attempt has been made to ensure the accuracy of the floor plan contained here, measurements of doors, windows, rooms and any other items are approximate and no responsibility is taken for any error, omission, or mis-statement. This plan is for illustrative purposes only and should be used as such by any prospective purchaser. The services, systems and appliances shown have not been tested and no guarantee as to their operability or efficiency can be given
Made with Metropix ©2019

Energy Efficiency Rating

	Current	Potential
Very energy efficient - lower running costs		
(92-100) A		
(81-91) B		84
(69-80) C		
(55-68) D	68	
(39-54) E		
(21-38) F		
(1-20) G		
Not energy efficient - higher running costs		
England, Scotland & Wales		EU Directive 2002/91/EC
Address: Meadowway		

Agents Note: Whilst every care has been taken to prepare these sales particulars, they are for guidance purposes only. All measurements are approximate and for general guidance purposes only and whilst every care has been taken to ensure their accuracy, they should not be relied upon and potential buyers are advised to recheck the measurements



OFFICE
101 Promenade,
Cheltenham,
Gloucestershire, GL50
1NW
info@elliottoliver.co.uk