



01263 822373
arnoldkeys.com

16 Chesterfield Cottages . Cromer . NR27 9ED



Guide £210,000

BEAUTIFULLY PRESENTED THROUGHOUT.

This charming brick and flint cottage is set in the heart of the town and dates to 1875. The property is beautifully presented with a lovely cosy cottage feel. The stable front door leads into the porch with space for coats and shoes. This leads directly into the bespoke Kitchen with a range of sage green base units with solid woodwork surfaces and inset butler sink. Built in appliances include dishwasher, washing machine, electric cooker, hob and space for fridge. There is also a range of oak and stainless-steel shelving. Stairs to the first-floor lead from the Kitchen and a sliding oak door to the Sitting/Dining room; a real cosy room with Velux roof lighting and French doors opening to the garden. The dining area has a feature brick fireplace with wood burner and two alcoves to the sides with oak shelving. There is oak engineered flooring throughout.

Cottage stairs lead to the first-floor landing with doors to the Bedroom, built in wardrobe, and into the Shower Room which offers a large cubicle with tiled surrounds, pedestal wash hand basin and low-level WC. There are two large storage cupboards to the side.

The garden is at the rear of the property and is fully enclosed with close boarded fencing and is laid mostly to lawn with a gravel bbq/seating area immediately at the rear. At the bottom of the garden is a pretty timber summer house/studio. There is a log store behind the summer house and brick store shed to the front.



Arnolds | Keys



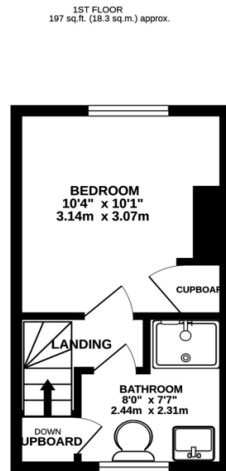
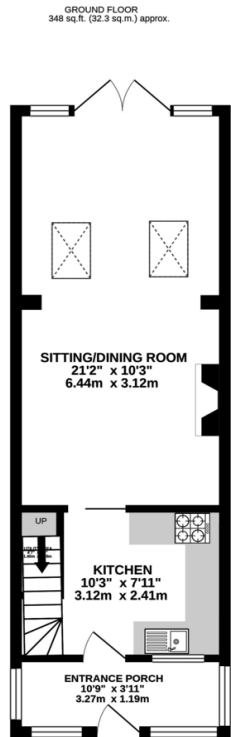

16 CHESTERFIELD COTTAGES, CROMER NR27 9ED

TOTAL FLOOR AREA: 545 sq.ft. (50.6 sq.m.) approx.
Whilst every attempt has been made to ensure the accuracy of the figures contained here, measurements of doors, windows, rooms and any other items are approximate and no responsibility is taken for any error, omission or misstatement. This plan is for illustrative purposes only and should be used as such by any prospective purchaser. The services, systems and appliances shown have not been tested and no guarantee as to their operability or efficiency can be given.
Made with Metropix 62022

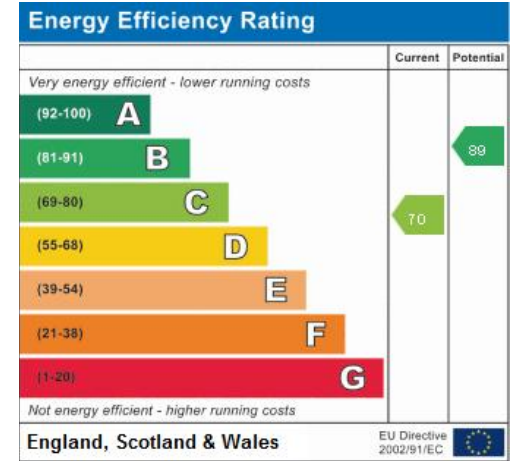

Agents Note: Whilst every care has been taken to prepare these sales particulars, they are for guidance purposes only. All measurements are approximate and for general guidance purposes only and whilst every care has been taken to ensure their accuracy, they should not be relied upon and potential buyers are advised to recheck the measurements. Arnolds Keys refer sellers and buyers to various trusted firms for services associated with the home move process, for which in some cases a referral fee is paid to Arnolds Keys by the service provider. It is your decision whether you choose to deal with those firms. Arnolds Keys from time to time, recommends conveyancing services. Should you decide to use them we could receive a referral fee of up to £125. Arnolds Keys recommend Mortgage Advice Bureau (MAB) to sellers and buyer for mortgage advice. Should you decide to use MAB we would receive a referral fee of £200. Arnolds Keys recommend Hadley and Ottaway (H&O) for removal services. Should you decide to use H&O we would receive a referral fee of 10% of the net final invoice.



01263 822373
arnoldskeys.com

coastal@arnoldskeys.com

Arnolds | Keys