



**SALES**

**LETTINGS**

**MANAGEMENT**

[chiswick@tatepartnership.co.uk](mailto:chiswick@tatepartnership.co.uk)

**020 8996 0000**

**TATEPARTNERSHIP.CO.UK**



**Gresham Mews, W4**

**£1,925 pcm**

This really is a Little Gem. A modern mews styled 2 Bedroom Cottage, located in a delightful private courtyard setting, discreetly sitting behind and unseen from, Reynolds Road. The cottage has had several upgrades, including double glazing, CH boiler, carpets, air conditioning unit etc. The accommodation comprises; downstairs (wooden flooring), entrance hall, living room, kitchen; upstairs (carpeted), stairs, landing, 2 bedrooms, bathroom. NB The small bedroom is more suited to a cot-room or ideal for work from home office. Outside, to the front is the shared courtyard, with each property having its' own designated seating area. Gresham Mews is about 10 minutes walk from Chiswick Park Station and the main Sainsbury's, with Chiswick High Road moments beyond. Available mid-late September. Unfurnished.

### Gresham Mews

Approximate Gross Internal Area = 43.0 sq m / 467 sq ft

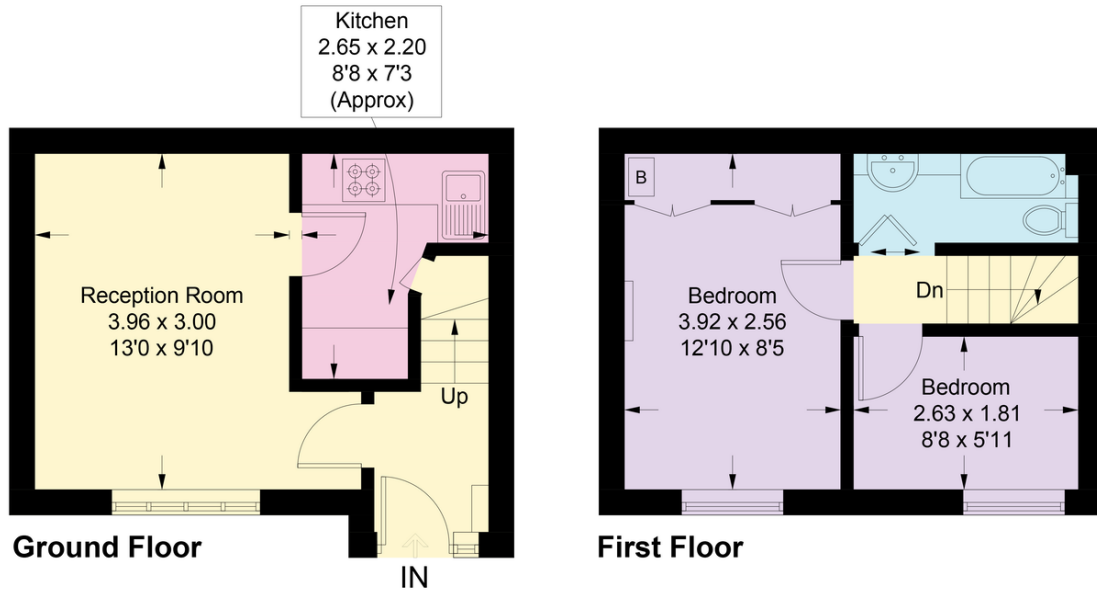

Illustration for identification purposes only, measurements are approximate, not to scale. floorplansUsketch.com © (ID964734)

## EPC

