

Julian Reid

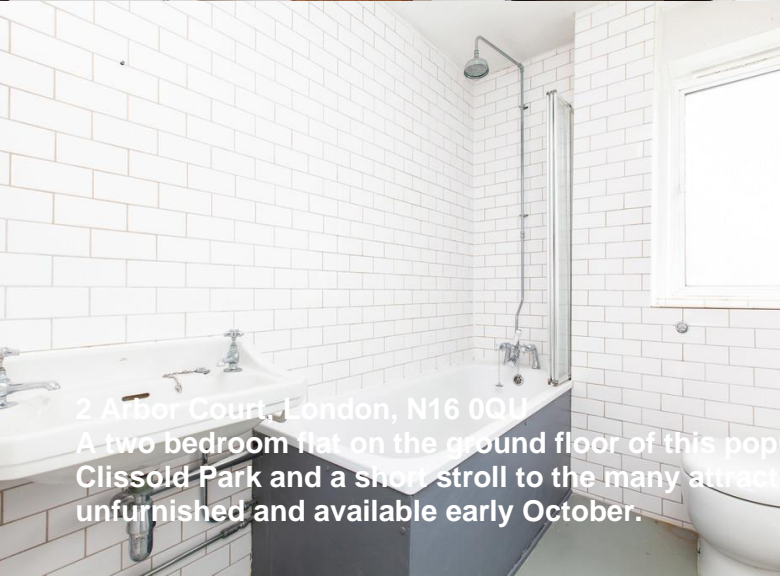

2 Arbor Court, London, N16 0QU
A two bedroom flat on the ground floor of this popular block, located on a private road moments from Clissold Park and a short stroll to the many attractions of Church St. The property is offered unfurnished and available early October.

£1,900 per calendar month

- Two bedrooms
- Council Tax Band: C
- EPC Rating: 72
- Balcony
- Light and airy

A two bedroom flat on the ground floor of this popular block, located on a private road moments from Clissold Park and a short stroll to the many attractions of Church St. The property is offered unfurnished and available beginning of October.



Julian Reid
51 Stoke Newington Church Street London N16 0AR
jreid@julianreid.co.uk Fax: 020 7923 8651
+44 (0) 20 7923 8650

Arbor Court, N16

Approximate Gross Internal Area

Ground Floor = 552 sq ft / 51.28 sq m

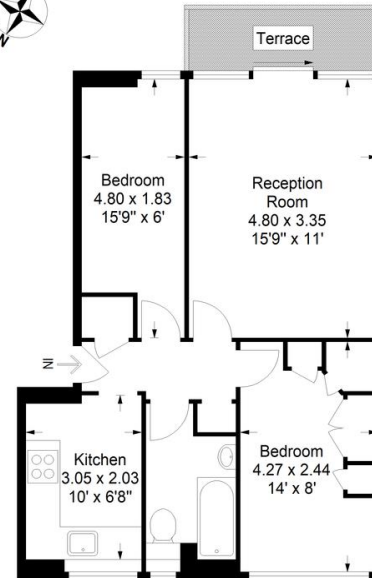

Ground Floor

JULIAN REID SPECIAL DISCLAIMER:-
For Illustration Purposes Only - Not To Scale
Floor plan For Julian Reid

Important notice: Julian Reid, their clients and any joint agents give notice that: 1: They are not authorized to make or give representations or warranties in relation to the property either here or elsewhere, either on their own behalf or on behalf of the client or otherwise. They assume no responsibility for any statement that may be made in these particulars. These particulars do not form part of any offer or contract and must not be relied upon as statements or representations of fact. 2: Any areas, measurements or distances are approximate. The text, photographs and plans are for guidance only and are not necessarily comprehensive. It should not be assumed that the property has all necessary planning, building regulation and other consents and Julian Reid have not tested any services, equipment or facilities. Purchasers must satisfy themselves by inspection or otherwise.



J352 Ravensworth 01670 713330