



2 Bedroom Apartment **Guide Price £160,000**

78 Lynmouth Road, Swindon, Wiltshire, SN2 2DH

mcfarlane
property.com

2 Bedroom Apartment

Swindon Town Centre

- TWO DOUBLE BEDROOMS
- NO ONWARD CHAIN
- GARAGE
- TOP FLOOR APARTMENT

- TWO DOUBLE BEDROOMS - TOP FLOOR APARTMENT - NO ONWARD CHAIN - GARAGE - IDEAL FIRST TIME BUY - 979 YEAR LEASE REMAINING -

Offered with NO ONWARD CHAIN is this deceptively spacious, top floor apartment situated within close proximity to various amenities including The Outlet Village & Bridgmead Retail Park. The internal living accommodation comprises of two double bedrooms, family bathroom, a spacious living room and kitchen/breakfast room. Externally, the property further benefits from a garage. We recommend viewing at your earliest convenience in order to appreciate what the property has to offer. Council tax band C.

Service Charge (EPA) £1,150
Ground Rent (EPA) £150





We 
where you
LIVE

Our team are friendly, experienced and are all local. They know it better than they do their own living rooms and can help you find what you're looking for because **we love where we live.**

We would be delighted to show you around this property.

**Because every home
needs a personal touch.**

**If you would like to view this
property then please get in touch.**

📞 01793 296600

✉ swindon@mcfarlaneproperty.com

mcfarlaneproperty.com

Agents Note: Whilst every care has been taken to prepare these sales particulars, they are for guidance purposes only. All measurements are approximate and for general guidance purposes only and whilst every care has been taken to ensure their accuracy, they should not be relied upon and potential buyers are advised to recheck the measurements

Ground Floor
Approx. 21.1 sq. metres (227.5 sq. feet)

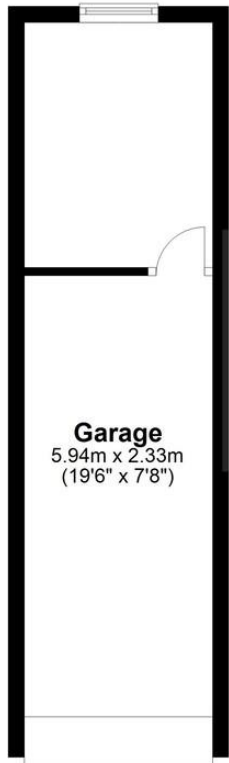

Third Floor
Approx. 58.5 sq. metres (629.6 sq. feet)

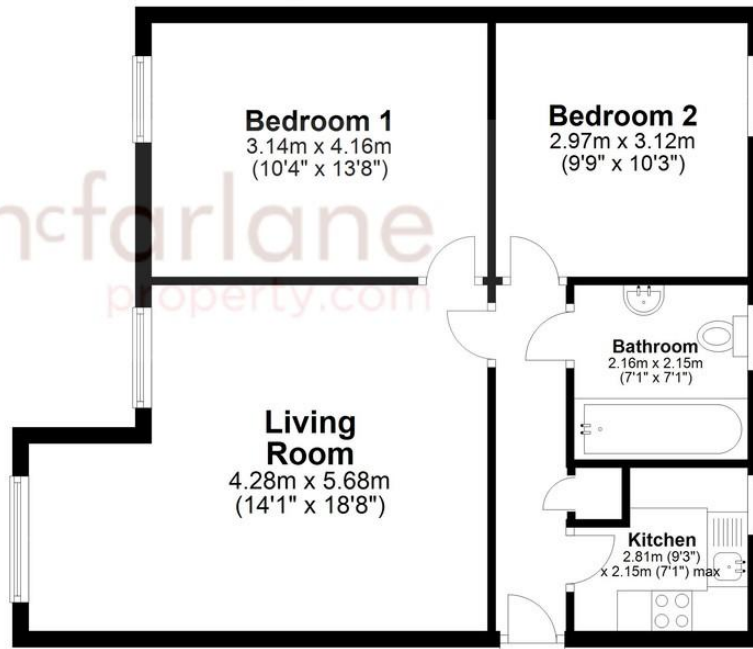

Total area: approx. 79.6 sq. metres (857.1 sq. feet)

mcfarlane
property.com

Cricklade.
102 High Street
Cricklade SN6 6AA
📞 01793 751044

Marlborough.
106 High Street
Marlborough SN8 1LT
📞 01672 514380

Old Town.
28-30 Wood Street
Swindon SN1 4AB
📞 01793 296880

Swindon.
The Village Centre,
Redhouse SN25 2FW
📞 01793 296600