

BELVOIR!

PINGLE CLOSE, GREAT OAKLEY, CORBY, NN18 8FT

OFFERS OVER £280,000 FREEHOLD COUNCIL TAX D





This immaculately presented town house is ready to move into & provides versatile living over three floors perfect for any investor or home mover alike.

The ground floor provides a spacious breakfast kitchen with high gloss units & access onto the low maintenance garden along with an integral garage & downstairs cloakroom.

The lounge is to the first floor of this bright & airy home which benefits from a Juliette balcony overlooking the garden.

The well-proportioned bedrooms are located on the first & second floor with the third bedroom on the first floor with a cloakroom to service both the bedroom & the lounge. Open views to the front are enjoyed by the master bedroom which also offers fitted wardrobes & an en-suite shower room.

Two further bedrooms are located on the top floor of this impressive family residence which are completed by the family bathroom & additional storage.

The front provides off road parking & a small lawn frontage with a low maintenance, fully enclosed garden to the rear which offers a patio & raised decking.

Viewing is advised to fully appreciate the size & space the property has to offer. EPC Rating C.



ENTRANCE HALL Door to front, tiled to flooring, radiator, access to integral garage, carpeted stairs rising to first floor.

KITCHEN/DINER 14' 11" x 12' 6" (4.55m x 3.82m) Double glazed door to rear, double glazed window to rear, kitchen comprising of wall and base wood effect high gloss units, granite effect work surfaces over, halogen four ring hob, electric oven, cooker hood over, stainless steel sink with drainer, radiator, tiled flooring.

GARAGE 16' 8" x 8' 2" (5.09m x 2.49m) Up and over door, power, lighting, part plaster walls.

FIRST FLOOR LANDING Double glazed window to side, airing cupboard, grey laminate to flooring, radiator, carpeted stairs rising to second floor, carpeted stairs descending to ground floor.

LOUNGE 14' 11" x 13' 1" (4.55m x 4m) Double glazed Juliette balcony, double glazed fully length windows to rear, electric fireplace, grey laminate to flooring, radiator, TV point. internet point.

BEDROOM THREE 12' 7" x 8' 1" (3.86m x 2.48m) Double glazed window to rear, radiator, grey laminate to flooring.

SECOND FLOOR LANDING Double glazed window to side, storage cupboard, grey laminate to flooring, loft access, radiator, carpeted stairs descending to first floor.



BEDROOM ONE 12' 9" x 11' 3" (3.89m x 3.45m) Double glazed window to front, fitted wardrobes, TV point, radiator, grey laminate to flooring.

EN-SUITE 6' 0" x 6' 0" (1.83m x 1.83m) Single tiled shower cubicle, wash hand basin mounted into work surface, low level WC, radiator, extractor fan, tiled splashbacks, vinyl to flooring.

BEDROOM TWO 13' 1" x 8' 8" (4.0m x 2.66m) Double glazed window to rear, radiator, grey laminate to flooring.

BEDROOM FOUR 10' 0" x 5' 11" (3.05m x 1.81m) Double glazed window to rear, radiator, grey laminate to flooring.

BATHROOM Panelled bath, telephone attachment, pedestal sink, low level WC, extractor fan, shave point, radiator, part tiled walls, vinyl to flooring.

EXTERNAL Front - Off road parking to front, small lawned frontage.

Rear - Extended patio, raised decking, fully enclosed.
Outside tap and electric point.



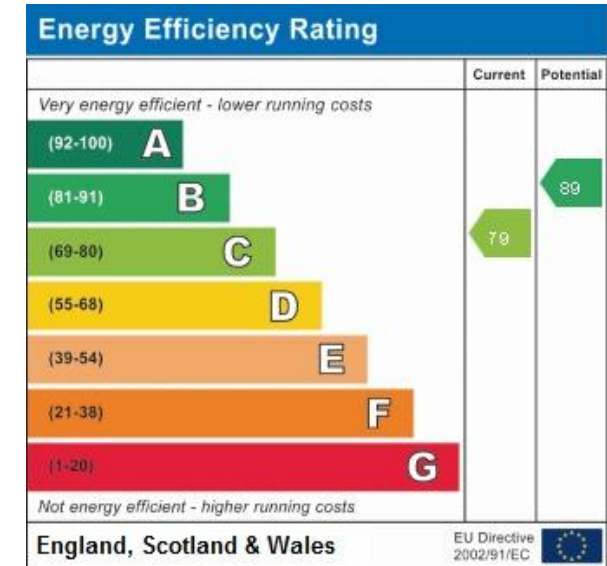
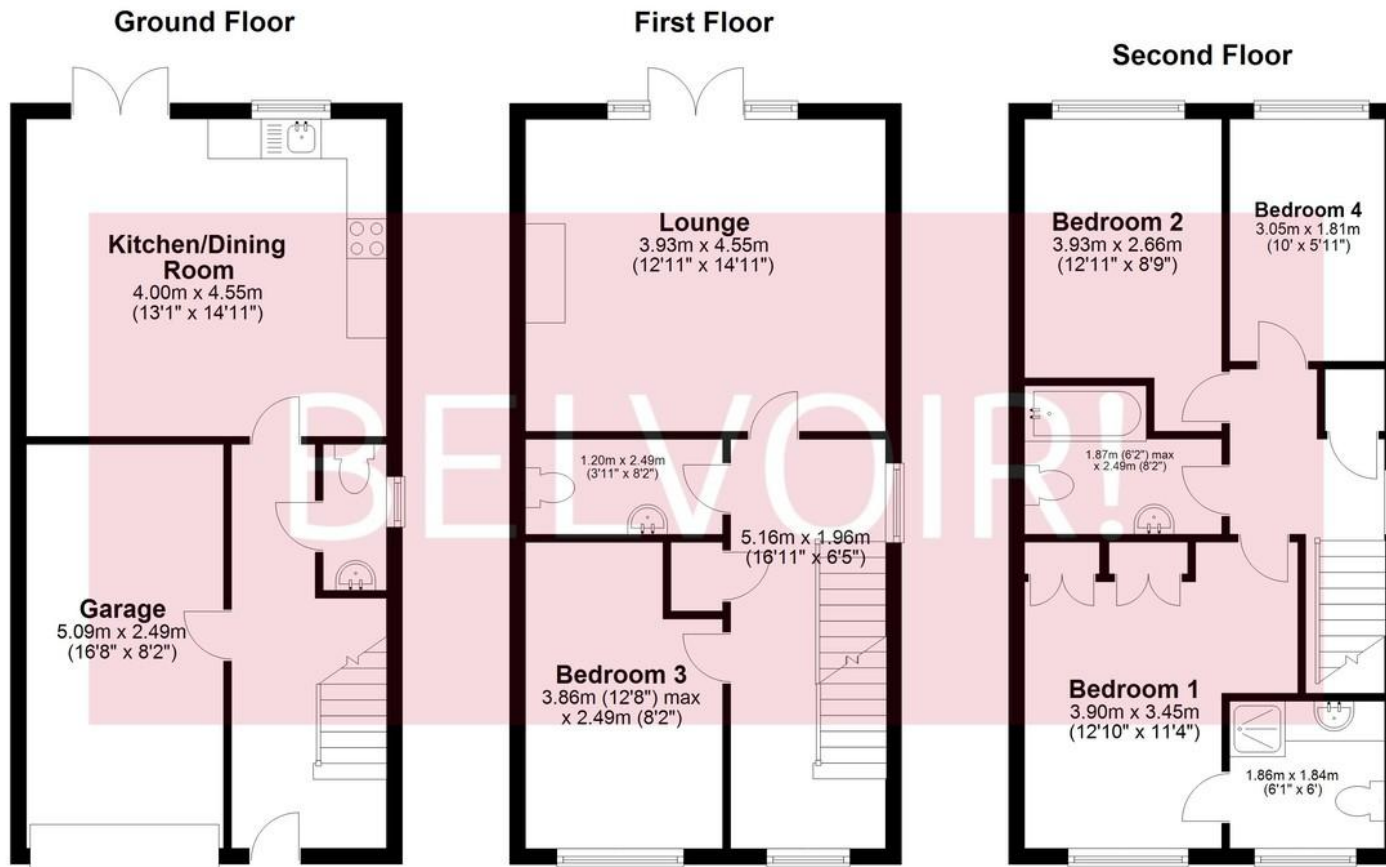

We endeavour to make our sales particulars accurate and reliable, however, they do not constitute or form part of an offer or any contract and none is to be relied upon as statements of representation or fact. Any service, system and appliances listed in this specification have not been tested by us and no guarantee as to their operating ability or efficiency is given. All measurements have been taken as a guide to prospective buyers only, and are not precise. If you require clarification or further information on any points, please contact us, especially if you are travelling some distance to view. Fixture and fittings other than those mentioned are to be agreed with the seller by separate negotiation.
Plan produced using PlanUp.