

LEASEHOLD



Purpose Built Flat
**BIRCHANGER ROAD,
SOUTH NORWOOD,
LONDON,
SE25 5DE**

£199,950

FEATURES

Ground Floor Purpose Built Flat

Modern Kitchen and Bathroom

Double Glazed Windows

Gated Off Street Parking

Council Tax Band B

EPC Rating E

Lease is 125 years from 29/09/1986

Ground Rent £64 p.a.

Maintenance Charges are £1,034 p.a.

Call Now to View!



1 Bedroom Purpose Built Flat located in South Norwood

Superbly presented Ground floor purpose built studio flat arranged as a One Bedroom Flat. Situated within easy access to Woodside Green with its popular Croydon Tramlink, Norwood Junction Overground Station, Tesco Express and The Country Park. Features; Lounge, Modern fitted kitchen, Modern bathroom, Bedroom, Double glazed windows, Electric heating, Communal gardens and Gated off street parking. Lease is 125 years from 29th September 1986. Council Tax Band B. EPC Rating E. View Now!

Ground Rent is £64 p.a.

Maintenance Charges are £1,034 p.a. (variable)

The Buildings Insurance is £360 p.a. (variable)

ENTRANCE HALL

LOUNGE

MODERN FITTED KITCHEN

MODERN FITTED BATHROOM

BEDROOM

COMMUNAL GARDEN

GATED OFF STREET PARKING

LEASEHOLD INFORMATION:

Lease is 125 years from 29th September 1986

BENSON & PARTNERS | 4 – 6 STATION ROAD, LONDON, SE25 5AJ

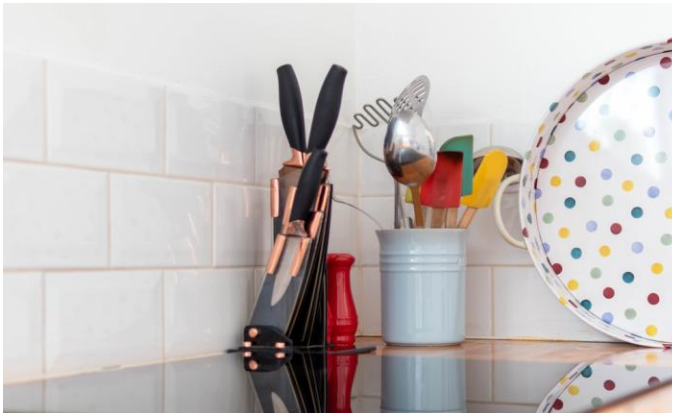

BENSON & PARTNERS | 4 – 6 STATION ROAD, LONDON, SE25 5AJ

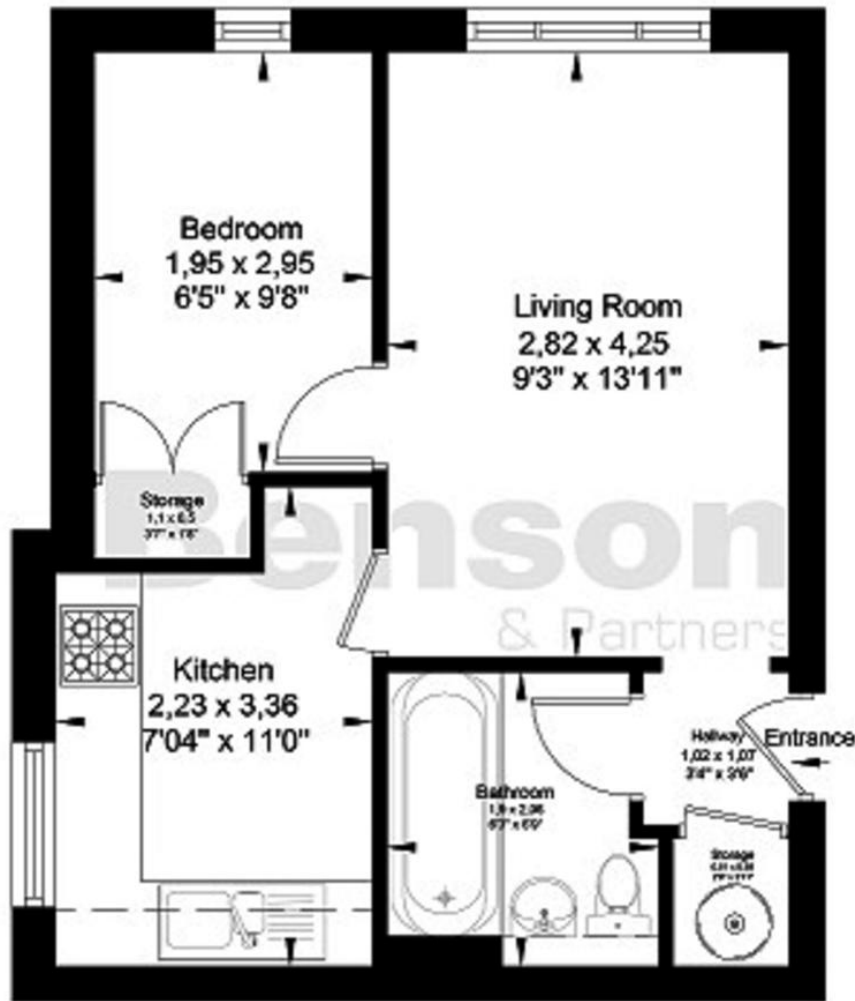

Ground Floor Flat

Total Internal Area
31.96m² (344 sq.ft.)

FOR ILLUSTRATIVE PURPOSES ONLY



Contact Us On:

020 8653 3444

southnorwood@benzonpartners.co.uk

www.bensonpartners.co.uk

Council Tax Band: B

Energy Efficiency Rating			
Score	Energy rating	Current	Potential
92+	A		
81-91	B		
69-80	C		75 C
55-68	D		
39-54	E	47 E	
21-38	F		
1-20	G		

Agents Note: Whilst every care has been taken to prepare these particulars, they are for guidance purposes only. All measurements are approximate and are for general guidance purposes only and whilst every care has been taken to ensure their accuracy, they should not be relied upon and potential buyers are advised to recheck the measurements.