



**79 White Horse Road**  
Asking price of £410,000

**mcfarlane**  
property.com



# White Horse Road Marlborough

- Master bedroom with en-suite
- Three further bedrooms
- Tandem Garage

A traditionally built brick semi-detached house, with double glazed windows. The spacious accommodation is arranged over two floors with a fully equipped kitchen with a slate tiled floor and ample space for a dining table. The sitting room which sits across the width of the house benefits from French doors giving access to the landscaped rear garden. Stairs rise from the entrance hall to the first floor master bedroom with en-suite shower room, three further bedrooms and a family bathroom. The house offers ideal family living in a quiet location yet within easy distance of Marlborough town centre





# Marlborough

Marlborough is an historic and thriving market town providing an extensive range of quality independent and well known retailers, public houses, restaurants and cafes along with plenty of amenities including the famed Marlborough College, a sports centre and an excellent state secondary school, St. Johns. The town is sited along the M4 corridor close to J15 and has nearby rail links offering access to London and the west country. The countryside surrounding Marlborough is within the North Wessex Downs AONB and includes the historic world heritage site of nearby Avebury and Savernake forest. St Johns park lies to the east of Marlborough and was constructed in 2010 by Crest Nicholson



We   
where you  
**LIVE**

Our team are friendly, experienced and are all local. They know it better than they do their own living rooms and can help you find what you're looking for because **we love where we live.**

We would be delighted to show you around this property.

**Because every home needs a personal touch.**

**If you would like to view this property then please get in touch.**

☎ 01672 514380

✉ [marlborough@mcfarlaneproperty.com](mailto:marlborough@mcfarlaneproperty.com)

[mcfarlaneproperty.com](http://mcfarlaneproperty.com)



### Ground Floor

Floor area 64.7 sq.m. (697 sq.ft.) approx

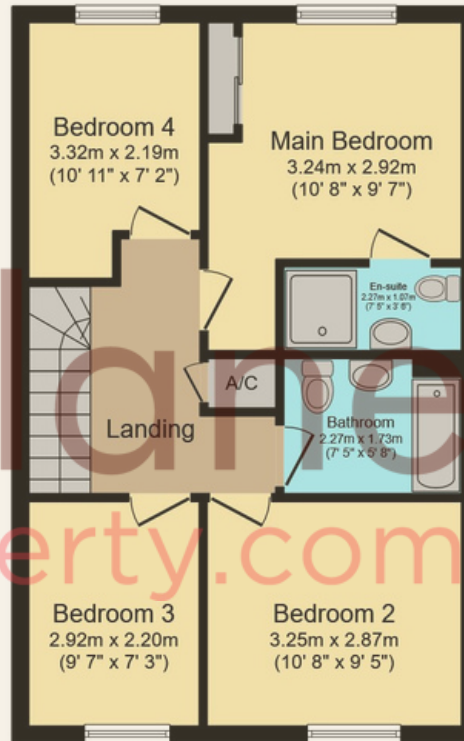

### First Floor

Floor area 49.7 sq.m. (535 sq.ft.) approx

area 114 sq.m. (1,226 sq.ft.) approx

Illustration purposes only and may not be representative of the property. The position and size of doors, windows are approximate. Unauthorized reproduction prohibited. © PropertyBOX

**mcfarlane**  
property.com

**Cricklade.**  
102 High Street  
Cricklade SN6 6AA  
☎ 01793 751044

**Marlborough.**  
106 High Street  
Marlborough SN8 1LT  
☎ 01672 514380

**Old Town.**  
28-30 Wood Street  
Swindon SN1 4AB  
☎ 01793 296880

**Swindon.**  
The Village Centre,  
Redhouse SN25 2FW  
☎ 01793 296600

Agents Note: Whilst every care has been taken to prepare these sales particulars, they are for guidance purposes only. All measurements are approximate and for general guidance purposes only and whilst every care has been taken to ensure their accuracy, they should not be relied upon and potential buyers are advised to recheck the measurements