

Buy your next home with Next Home

Leading Perthshire Estate Agency

Sinclair Lodge Invertilt Road, Blair Atholl, Perthshire, PH18 5TE

Offers Over £69,950

NEXTHOME
ESTATE & LETTING AGENTS

Buying with Next Home

Sinclair Lodge River Tilt Leisure Park, Blair Atholl,
Perthshire, PH18 5TE

Many thanks for your interest with Sinclair Lodge River Tilt Leisure Park, Blair Atholl, Perthshire, PH18 5TE.

Next Home Estate Agents dedicate themselves to be available when you are, offering an unbeatable service 7 days a week until 9pm.

We have the largest sales team in Perthshire, operating from our 5 offices throughout Perthshire and delivering more sales than any other estate agent.

Not only are we Perthshire's Number 1 choice but we are also local. One of the reasons we know the local markets so well is because we live here. So let us guide you through the selling and buying process.

If you're a first time buyer we have incentives to help get you onto the property ladder - our consultants can advise you through the whole process.

We offer free, no obligation mortgage advice to all our buyers.

If you have a property to sell, contact us to arrange a valuation. We are renowned in getting our customers moving quicker and at a higher price than our competitors. Put us to the test and get your free valuation today, call 01738 444342.

If you would like to be kept informed of other great properties like this one please register on our hot buyers list, where we will email you of new property listings and property open days.

About the Area

The stunning village of Blair Atholl is set amidst the beautiful Perthshire countryside and a wide range of outdoor activities are available in and around the area including walking, fishing, bowling, golfing and horse riding.

There is a range of local amenities within the village including a post office, store, newsagent, hotel with restaurant, garage and Old Mill tearoom together with gift shops and a fish and chip shop/restaurant. The village is bypassed by the A9 trunk route providing quick access to the North and South. Blair Atholl is served with a railway station and the overnight Inverness to London sleeper stops in Pitlochry which is located approximately 6 miles to the South.



Property Summary

Next Home are delighted to bring to the market this THREE BEDROOM HOLIDAY LODGE situated in the renowned River Tilt Leisure Park in the picturesque Perthshire town of Blair Atholl. This five star award winning park is maintained to a very high standard and is ideally situated for a range of outdoor activities and has an onsite leisure centre.

This spacious lodge would be ideal for a family holiday home and can be accessed all year round. The lodge is being sold fully furnished offering ready to move into accommodation and comprises of; entrance hall, lounge/dining room, kitchen, family bathroom and three bedrooms with master en-suite.

There is electric heating and windows are double glazed. Externally the property boasts of stunning views and benefits from wooden decking and parking. Viewings are a must to appreciate the well-proportioned accommodation and scenic location on offer with the lodge.



Key property features

- ✓ 3 bedrooms
- ✓ En-suite
- ✓ Decked area
- ✓ Ideal holiday let
- ✓ Ideal Holiday home
- ✓ Immaculately presented
- ✓ Facilities on site
- ✓ Open all year
- ✓ Parking









An aerial photograph of a residential neighborhood, showing rows of houses with red brick walls and grey roofs. The image is overlaid with a semi-transparent blue filter. The houses are arranged in a grid-like pattern, with some featuring rear gardens and garages. The overall scene is a typical suburban housing estate.

Have a property to sell?

An expert from our local branch will provide you with the most accurate valuation.



NEXTHOME

ESTATE & LETTING AGENTS

Floorplans

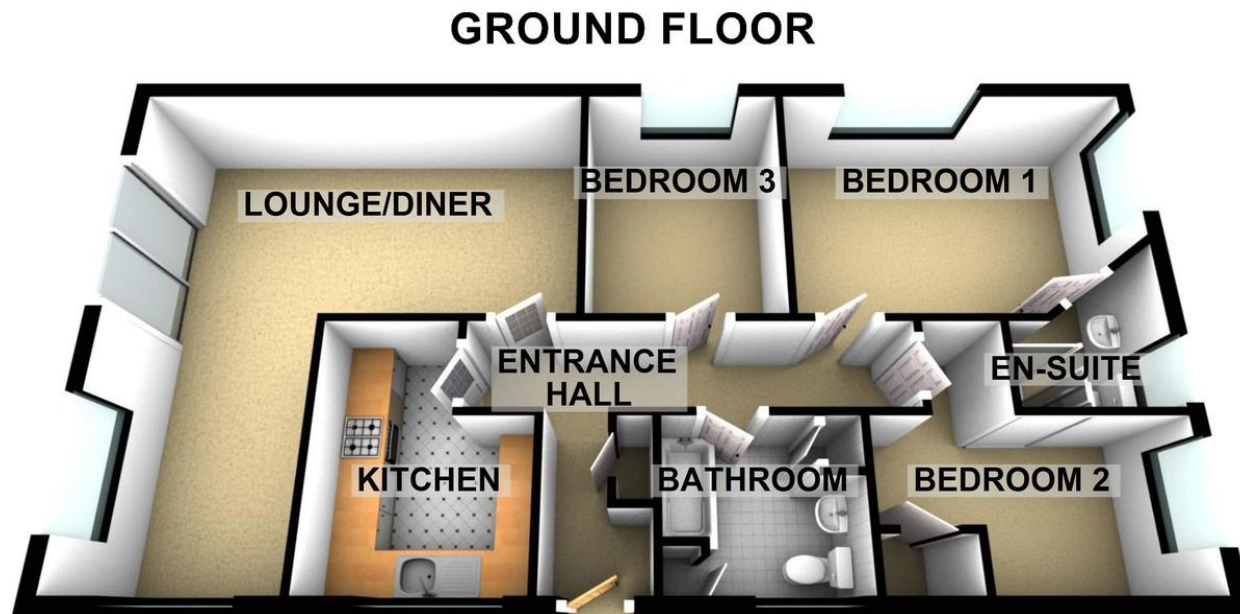

Property Room sizes

ENTRANCE HALL

16' 3" x 9' 8" (4.95m x 2.95m)

LOUNGE/DINING ROOM

19' 9" x 17' 10" (6.02m x 5.44m)

KITCHEN

9' 7" x 7' 11" (2.92m x 2.41m)

BEDROOM

13' 10" x 9' 7" (4.22m x 2.92m)

ENSUITE

6' 5" x 3' 4" (1.96m x 1.02m)

BEDROOM

8' 8" x 6' 10" (2.64m x 2.08m)

BEDROOM

9' 7" x 7' 8" (2.92m x 2.34m)

BATHROOM

6' 10" x 6' 6" (2.08m x 1.98m)

PLEASE NOTE: These particulars whilst believed to be accurate are set out as a general outline only for guidance and do not constitute any part of an offer or contract intending, purchasers should not rely on them as statements or representations of fact, but must satisfy themselves by inspection or otherwise as to their accuracy. No person in this firm's employment has the authority to make or give representation or warranty in respect of the property. All room sizes are approximate and for general guidance only. They cannot be relied upon for fitting carpets, furniture etc.



NEXTHOME
ESTATE & LETTING AGENTS

TO ARRANGE A VIEWING OF THIS PROPERTY PLEASE TELEPHONE YOUR LOCAL BRANCH BELOW:

63 – 65 George Street, Perth 01738 44 43 42

41 - 43 Allan Street, Blairgowrie..... 01250 39 80 02

47a Atholl Road, Pitlochry..... 01796 54 80 14

1a James Square, Crieff.....01764 65 00 44

211 High Street, Auchterarder.....01764 66 36 66

Email sales@nexthomeonline.co.uk

For more information about Next Home and our services please visit www.nexthomeonline.co.uk

The only Perthshire estate agent available 7 days until 9pm

PLEASE NOTE: These particulars whilst believed to be accurate are set out as a general outline only for guidance and do not constitute any part of an offer or contract intending, purchasers should not rely on them as statements or representations of fact, but must satisfy themselves by inspection or otherwise as to their accuracy. No person in this firm's employment has the authority to make or give representation or warranty in respect of the property. All room sizes are approximate and for general guidance only. They cannot be relied upon for fitting carpets, furniture etc.

Registered Office Argyll House, Quarrywood Court, Livingston, West Lothian EH54 6AX. Registered in Scotland No. SC264812. NEXTHOME (Scotland) Ltd is an appointed representative of Kinggate Law Limited, which is authorised and regulated by the Financial Conduct Authority for advising on and arranging mortgages and insurance, broking and debt counselling of consumer credit agreements.



Next Home are proud to be members of the Property Ombudsman Scheme