



Buy your next home with Next Home

Leading Perthshire Estate Agency

Jasmine Cottage , 103 High Street, Auchterarder, PH3 1BG

Offers Over £130,000

NEXTHOME
ESTATE & LETTING AGENTS

Buying with Next Home

Jasmine Cottage , 103 High Street, Auchterarder,
PH3 1BG

Many thanks for your interest with Jasmine Cottage , 103 High Street, Auchterarder, PH3 1BG.

Next Home Estate Agents dedicate themselves to be available when you are, offering an unbeatable service 7 days a week until 9pm.

We have the largest sales team in Perthshire, operating from our 5 offices throughout Perthshire and delivering more sales than any other estate agent.

Not only are we Perthshire's Number 1 choice but we are also local. One of the reasons we know the local markets so well is because we live here. So let us guide you through the selling and buying process.

If you're a first time buyer we have incentives to help get you onto the property ladder - our consultants can advise you through the whole process.

We offer free, no obligation mortgage advice to all our buyers.

If you have a property to sell, contact us to arrange a valuation. We are renowned in getting our customers moving quicker and at a higher price than our competitors. Put us to the test and get your free valuation today, call 01738 444342.

If you would like to be kept informed of other great properties like this one please register on our hot buyers list, where we will email you of new property listings and property open days.

About the Area

This property is located in the highly desirable town of Auchterarder which provides an abundance of local amenities and leisure facilities including an array of shops, hairdressers, restaurants, health centre, post office and golf course.

There are primary and secondary schools within the town and the nearby A9 makes it an ideal location for commuting to Perth, Stirling, Edinburgh and Glasgow. The town is also well serviced by Gleneagles train station.

The prestigious Gleneagles Hotel offers a host of unique leisure facilities and restaurants including the award winning Andrew Fairlie as well as three championship golf courses which are regarded among the best courses in the world.



Property Summary

Next Home are delighted to bring this beautifully kept 2 bedroom mid-terraced cottage to Auchterarder sales market.

The property is presented in walk-in condition and would make an ideal holiday home with accommodation comprising: Entrance hall, lounge/dining area, tastefully decorated kitchen with larder, 2 bedrooms and a modern shower room.

There is a communal drying green pertaining to the property. To the front there is a gravelled area that is ideal for a table and chairs in the summer months.



Key property features

- ✓ Ideal holiday home
- ✓ Modern shower room
- ✓ Quiet location
- ✓ Popular area
- ✓ Close to all local amenities
- ✓ Communal drying green
- ✓ Outbuilding
- ✓ Great investment
- ✓ Close to Gleneagles









An aerial photograph of a residential neighborhood, showing rows of houses with red brick walls and grey roofs. The image is overlaid with a semi-transparent blue filter. The houses are arranged in a grid-like pattern, with some featuring rear gardens and driveways. The overall scene is a typical suburban housing estate.

Have a property to sell?

An expert from our local branch will provide you with the most accurate valuation.



NEXTHOME

ESTATE & LETTING AGENTS

Floorplans

Ground Floor

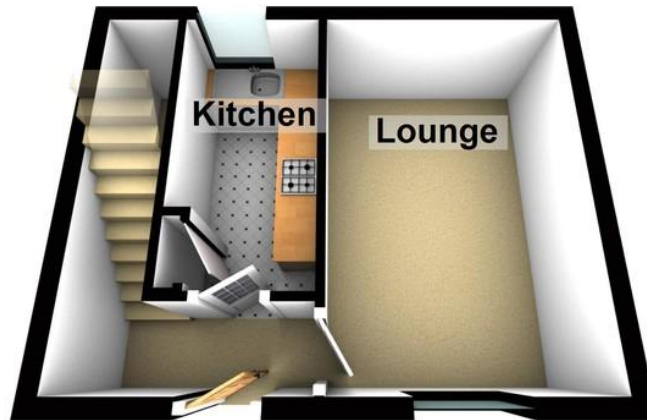

First Floor





Property Room sizes

ENTRANCE HALL

LOUNGE/DINER

15' 7" x 11' 9" (4.75m x 3.58m)

KITCHEN

11' 8" x 5' 8" (3.56m x 1.73m)

BEDROOM

13' 4" x 6' 2" (4.06m x 1.88m)

BEDROOM

13' 4" x 9' 2" (4.06m x 2.79m)

SHOWER ROOM

6' 2" x 4' 9" (1.88m x 1.45m)

PLEASE NOTE: These particulars whilst believed to be accurate are set out as a general outline only for guidance and do not constitute any part of an offer or contract intending, purchasers should not rely on them as statements or representations of fact, but must satisfy themselves by inspection or otherwise as to their accuracy. No person in this firm's employment has the authority to make or give representation or warranty in respect of the property. All room sizes are approximate and for general guidance only. They cannot be relied upon for fitting carpets, furniture etc.



NEXTHOME
ESTATE & LETTING AGENTS

TO ARRANGE A VIEWING OF THIS PROPERTY PLEASE TELEPHONE YOUR LOCAL BRANCH BELOW:

63 – 65 George Street, Perth 01738 44 43 42

41 - 43 Allan Street, Blairgowrie..... 01250 39 80 02

47a Atholl Road, Pitlochry..... 01796 54 80 14

1a James Square, Crieff.....01764 65 00 44

211 High Street, Auchterarder.....01764 66 36 66

Email sales@nexthomeonline.co.uk

For more information about Next Home and our services please visit www.nexthomeonline.co.uk

The only Perthshire estate agent available 7 days until 9pm

PLEASE NOTE: These particulars whilst believed to be accurate are set out as a general outline only for guidance and do not constitute any part of an offer or contract intending, purchasers should not rely on them as statements or representations of fact, but must satisfy themselves by inspection or otherwise as to their accuracy. No person in this firm's employment has the authority to make or give representation or warranty in respect of the property. All room sizes are approximate and for general guidance only. They cannot be relied upon for fitting carpets, furniture etc.

Registered Office Argyll House, Quarrywood Court, Livingston, West Lothian EH54 6AX. Registered in Scotland No. SC264812. NEXTHOME (Scotland) Ltd is an appointed representative of Kinggate Law Limited, which is authorised and regulated by the Financial Conduct Authority for advising on and arranging mortgages and insurance, broking and debt counselling of consumer credit agreements.



Next Home are proud to be members of the Property Ombudsman Scheme