

Elizabeth Gardens

Approximate Gross Internal Area = 71.1 sq m / 765 sq ft

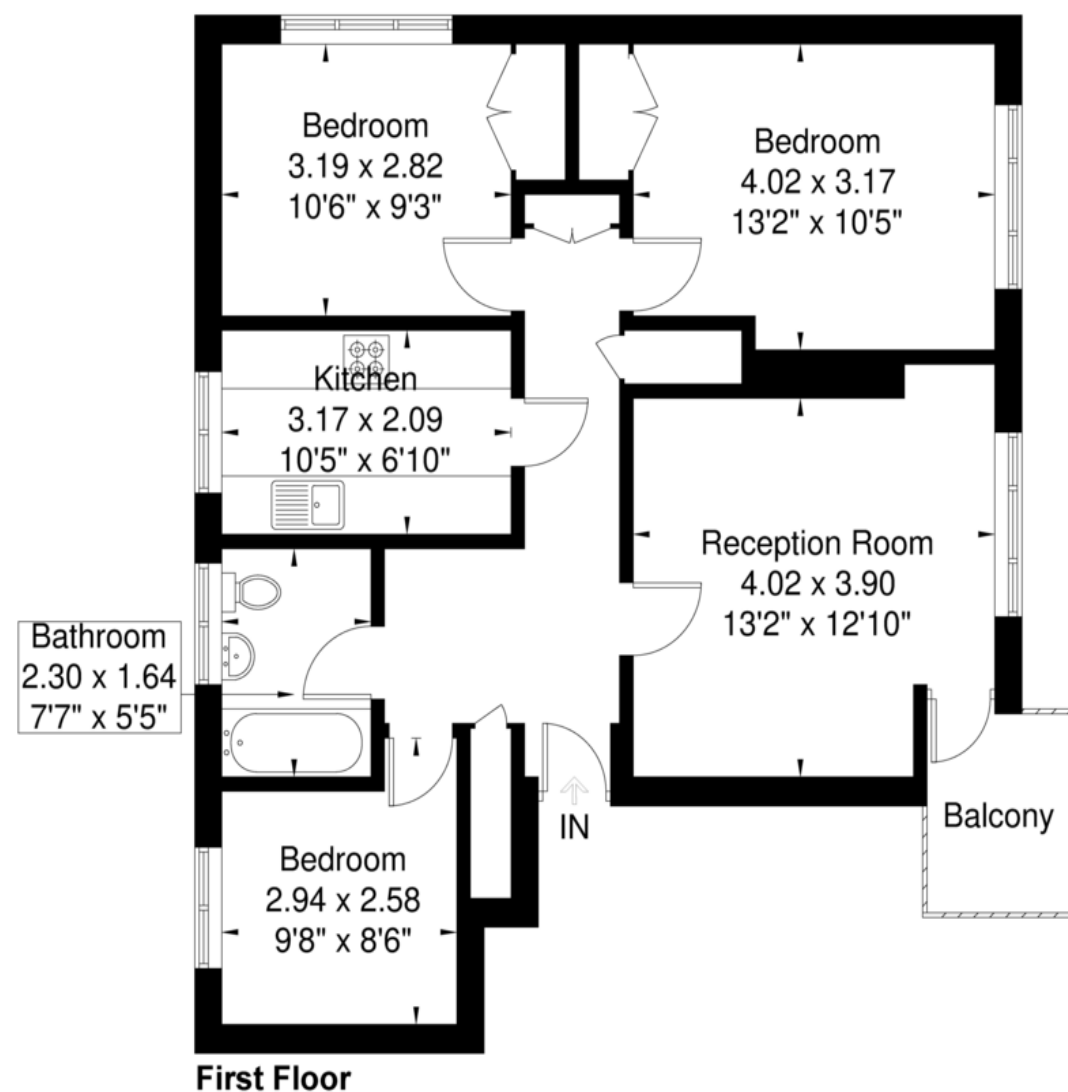

Although every attempt has been made to ensure accuracy, all measurements are approximate.
 The floorplan is for illustrative purposes only and not to scale.
 © www.perspective.co.uk



Elizabeth Gardens, London, W3 7SJ

£499,950 Leasehold

Key Features

- Three Bedrooms
- Private Balcony
- First Floor
- Separate Kitchen
- Private Parking
- Close To Amenities
- Well Kept Communal Gardens
- Good Ample Storage

Description

Hart and Co are pleased to present this Three-bedroom first floor flat with private Balcony overlooking communal gardens. The property comprises Three Bedrooms separate fully fitted kitchen family bathroom and reception room leading to a private balcony. The property further benefits a family bathroom good ample storage and comes with private parking. For commuters, the route options are endless. Via Acton Park, there is a pleasant walk to Acton Central over-ground station and residents can also catch the district line from Stamford Brook underground station. There are numerous bus stops that regularly accommodate trips to the Westfield Shopping Centre as well as Shepherd's Bush and East Acton stations for the Hammersmith and City and central lines and Turnham Green and Hammersmith for the district and Piccadilly lines

