



FOUR BEDROOM DETACHED HOUSE LOCATED IN BLUNSDON

6 FLORA CLOSE,
BLUNSDON, WILTSHIRE, SN26 8AE

FREEHOLD £525,000

**Ridgeway**

ENTRANCE HALL

Coir mat. Door to front with two side windows. Wooden effect laminate flooring. Fire alarm. Radiator. Alarm system and sensors. Under stairs storage space. Storage cupboard.

CLOAKROOM

Wooden effect laminate flooring. Low level WC. Wall mounted basin with splashback. Radiator.

STUDY/DINING ROOM

Window to front. Beige carpet. Oatmeal walls. Radiator. BT point with fibre into the house at 1 GB.

LIVING ROOM

Window to front. Double doors to conservatory/dining area. Beige carpet. Oatmeal walls with a leaf pattern feature wall. Two radiators. Wooden mantel piece housing a faux wood burner with light effects. TV and BT points.

KITCHEN

Window to rear. Wooden effect laminate flooring. Grey walls. Radiator. Integrated NEFF kitchen appliances, such as a dishwasher, fridge/freezer, double oven and proofing drawer with a further range of white floor and base units with a granite worktop. NEFF microwave. One and a half deep set sink unit with mixer tap and drainer.

CONSERVATORY

Patio doors to rear. Window to rear. Double doors to living room. Radiator. Wooden effect laminate flooring. Grey walls.

UTILITY

Door to driveway. Wooden effect laminate flooring. Grey walls. Space and plumbing for an automatic washing machine. Further utility space. Single bowl stainless steel sink and drainer inset into a grey worktop with cupboard below. Further range of wall and base units. Cupboard housing Ideal Logic boiler for domestic hot water and central heating. Temperature control panel below.

LANDING

Window to rear. Beige carpet. Grey walls. Radiator. Airing cupboard. Linen cupboard. Loft hatch. Doors to bedrooms.

MASTER BEDROOM

Window to rear. Beige carpet. Grey walls. Radiator. Two built in wardrobes. TV point. Thermostat control.



Off white tile. White walls. Obscure glazed window to side. Stainless steel and glass shower cubicle with multiple attachment overhead shower. Low level WC. Wall mounted wash basin with vanity unit below. Shaving point. Ladder radiator. Mirrored medicine cabinet. Grey tile splashback surround water sensitive areas.

BEDROOM TWO

Window to front. Beige carpets. Blue and cream walls. Radiator. TV point.

BEDROOM THREE

Window to front. Beige Carpet. Blue and cream walls. Radiator. TV point.

BEDROOM FOUR

Window to rear. Beige carpets. Grey walls. Radiator. TV point.

BATHROOM

Off white tile. White walls. Obscure glazed window to front. White panelled bath suit with multiple attachment overhead shower. Low level WC. Wall mounted wash basin with vanity unit below. Shaving point. Ladder radiator. Beige splashback surround water sensitive areas.

OUTSIDE REAR

Laid to patio at rear doors with path to garage side access door, decking and side access gate. Laid to lawn. Stone wall surround with timber fencing. Mature shrub and plant border. Stone courtyard to side. Decking to side of the garage. Outside tap. Door to garage. Side access gate.

GARAGE/DRIVEWAY

Electric garage door. Cameras to front and side of the garage. Electricity to garage. Partially boarded ceiling space. Security system. Space for two cars.

Double gate. Space for four cars. Block paved driveway. Electric door to garage. Side access gate to rear garden. Side access door to utility room.

Additional Information

Tenure: Freehold

Viewing: Strictly by appointment with Ridgeway Estate Agents.



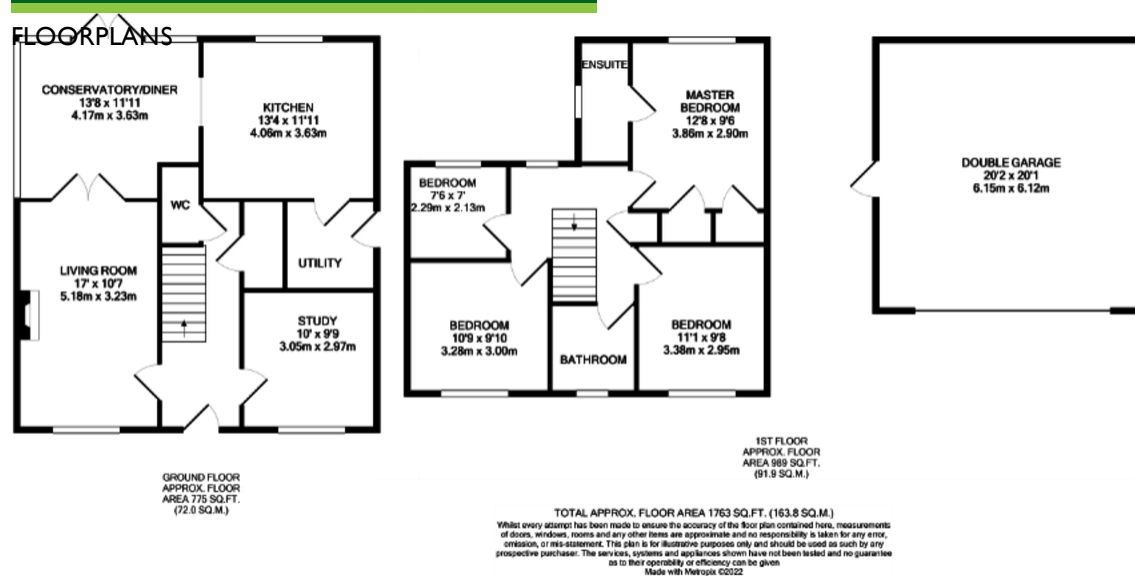

01367 712900 | lechlade@ridgewayestateagents.co.uk | www.ridgewayestateagents.co.uk

Ridgeway Fairford Office

Burford Street, Lechlade,
Gloucestershire, GL7 3AP

Agents Note: Whilst every care has been taken to prepare these sales particulars, they are for guidance purposes only. All measurements are approximate are for general guidance purposes only and whilst every care has been taken to ensure their accuracy, they should not be relied upon and potential buyers are advised to recheck the measurements.