



## Keswick

Offers over  
**£100,000**

Flat 12 Homethwaite  
House  
Eskin Street  
Keswick  
CA12 4DG

A one bedroom ground floor retirement apartment forming part of a private and secure purpose built complex most conveniently situated on a side street within walking distance of Keswick town centre.

Property Ref: KW0171





Living Room



Bedroom



Shower Room

Accommodation (with approximate measurements)

Ground Floor:

**Communal Entrance Hall**

With security intercom entrance system.

**Self Contained Entrance Hall**

With telecom entry system control, built in cupboard.

**Living Room**

18' 9" max x 10' 6" max (5.72m max x 3.2m max)

With electric fire with wooden surround and stone effect hearth and backpanel, electric economy heater, glazed door leading to external grounds, archway to

**Kitchen**

7' 2" x 5' 5" (2.18m x 1.65m)

With fitted base and wall units, stainless steel sink unit with mixer tap, ceramic wall tiling, extractor unit.

**Bedroom**

15' 11" x 8' 8" (4.85m x 2.64m)

With fitted wardrobe.

**Shower Room**

With WC, vanity wash hand basin, corner entry shower enclosure, heated towel rail, ceramic wall tiling, wall mounted electric heater.



Bedroom

#### Services

Mains water, electricity and drainage. Electric storage heating. Pull cord 24 hour emergency call system.

#### Tenure

Leasehold with a 125 year lease from 1987.

**Ground Rent** We are advised that the current ground rent payable is £246.87 every 6 months.

**Service Charge** TBC

#### Occupancy Conditions

Single residents must be aged 60 or over. A secondary resident must be aged 55 or over.

**Council Tax** Band B.

**Energy Performance Certificate** The full Energy Performance Certificate is available on our website and also at any of our offices.

**Viewings** By appointment with Hackney & Leigh's Keswick office.

**Directions** From Keswick town centre proceed from Station Street onto St John's Street and then continue onto Ambleside Road. Eskin Street is the first turning on the left after Acorn Street.

**Price** Offers over £100,000



Main Entrance



# Flat 12, Homethwaite House, Eskin Street, Keswick

Approximate Area = 486 sq ft / 45 sq m

For identification only - Not to scale

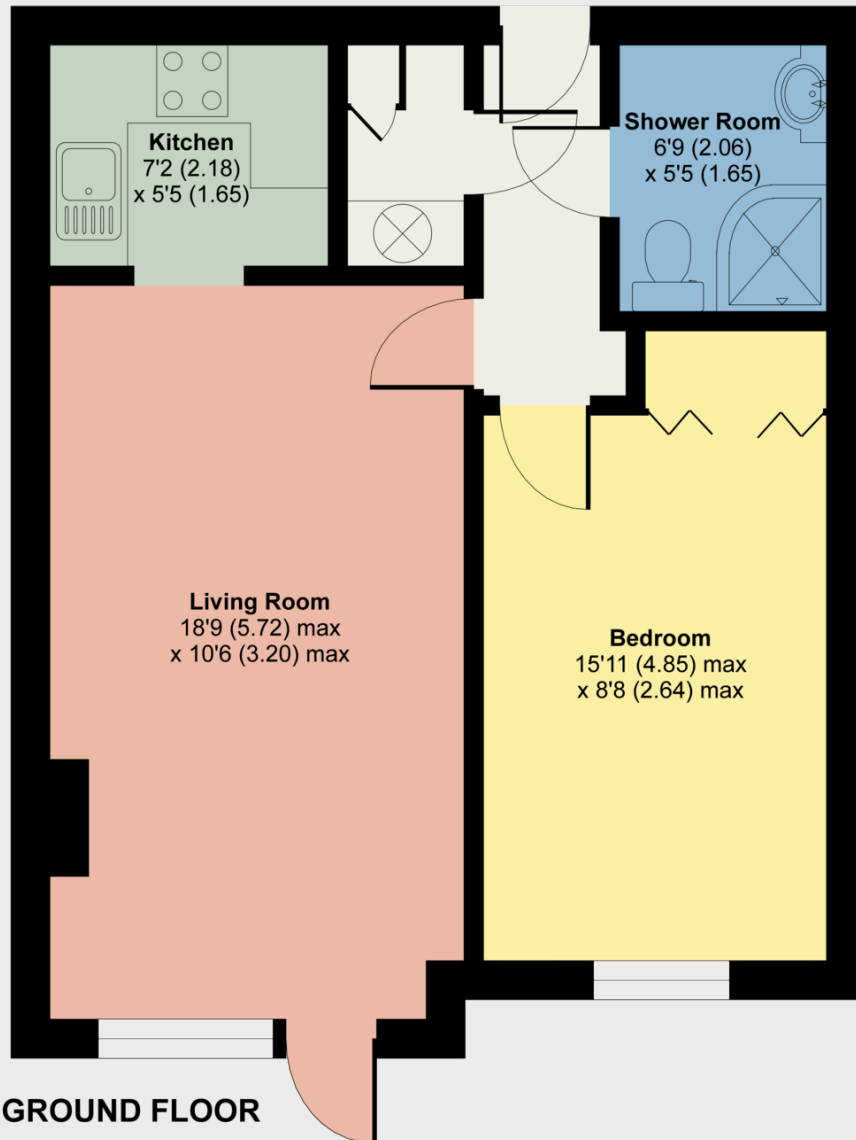

Floor plan produced in accordance with RICS Property Measurement Standards incorporating International Property Measurement Standards (IPMS2 Residential). © nichecom 2022. Produced for Hackney & Leigh. REF: 843474

All permits to view and particulars are issued on the understanding that negotiations are conducted through the agency of Messrs. Hackney & Leigh Ltd. Properties for sale by private treaty are offered subject to contract. No responsibility can be accepted for any loss or expense incurred in viewing or in the event of a property being sold, let, or withdrawn. Please contact us to confirm availability prior to travel. These particulars have been prepared for the guidance of intending buyers. No guarantee of their accuracy is given, nor do they form part of a contract.