



 **3**
Bedrooms

 **1**
Bathroom





*****THREE BEDROOM SEMI DETACHED PROPERTY*****

*****MANY ORIGINAL FEATURES*****

*****TWO RECEPTION ROOMS*****

*****NO CHAIN*****

Trading Places are proud to bring to the market this beautiful family residence. On entering this spacious accommodation there is an entrance hall, two reception rooms and a modern kitchen/diner. On the first floor there are three generous size bedrooms and a family bathroom.

External: - Gated front garden and to the rear is an enclosed garden with easy maintenance grass and separate. Gated access.

Location: - The property is situated in the heart of Stretford Situated on a highly desirable and sought-after tree-lined Kings Road, and within easy walking distance of Stretford Metrolink Station which gives you direct access into Altrincham, City Centre and Media City, and all being a five-minute walk to Longford Park.

Entrance Hall

Hardwood door opening to a light and airy hallway with high ceilings. Access to the 2 reception rooms dining room, kitchen and 1st floor. Double glazed window. Storage cupboard.

Reception One 4.22m x 3.94m

Double glazed bay window to front elevation. One radiator. Carpet.

Reception Two 5.18m x 3.63m

Double glazed window to rear elevation. PVC white door to access garden. Radiator.

Dining Room. 3.31m x 2.52m

Double glazed window to the side. Under the stairs storage cupboard. Radiator. Access to kitchen.

Kitchen 2.73m x 2.72m

Double glazed window to rear elevation. Fitted with a range of shaker style wall and base units with contrasting worktops incorporating a single drainer sink unit with mixer tap. Integrated gas hob with electric double oven. Space for fridge freezer. Radiator. Tiled floor. Access to garden with another white PVC back door.

Landing

Double glazed window. Loft access. 3 bedrooms, WC & Bathroom.

Bedroom One 4.28m x 3.29m

Double glazed bay window to rear. Large bedroom with fitted wardrobes. Carpet. Radiator.

Bedroom Two 4.31m x 3.65m

Double glazed window. Radiator. Carpet.

Bedroom Three 2.71m x 2.36m

Double glazed window. Radiator. Carpet.

Bathroom 2.69m x 1.57m

Double glazed frosted window. Blue bathroom suite comprising: - panel bath, with shower over. Pedestal wash hand basin. Radiator. Carpet.

Garden

Fencing All around. Grass to the rear. Detached garage.

GROUND FLOOR

1ST FLOOR

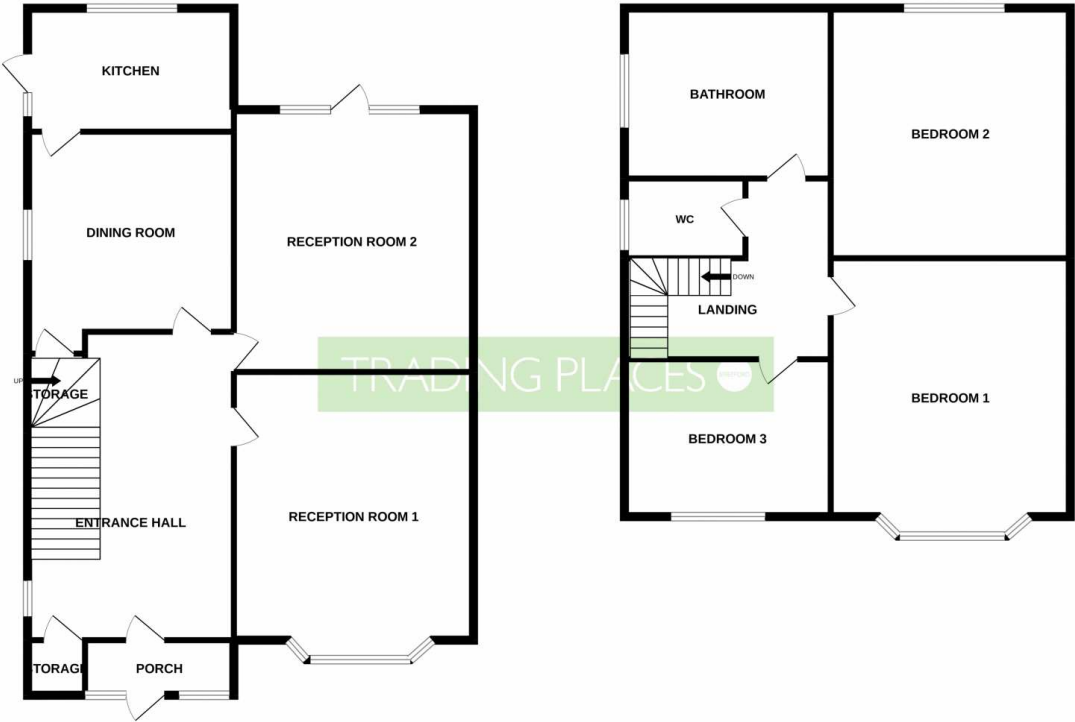

Whilst every attempt has been made to ensure the accuracy of the floorplan contained here, measurements of doors, windows, rooms and any other items are approximate and no responsibility is taken for any error, omission or mis-statement. This plan is for illustrative purposes only and should be used as such by any prospective purchaser. The services, systems and appliances shown have not been tested and no guarantee as to their operability or efficiency can be given.
Made with Metropix ©2022



Coming soon

