

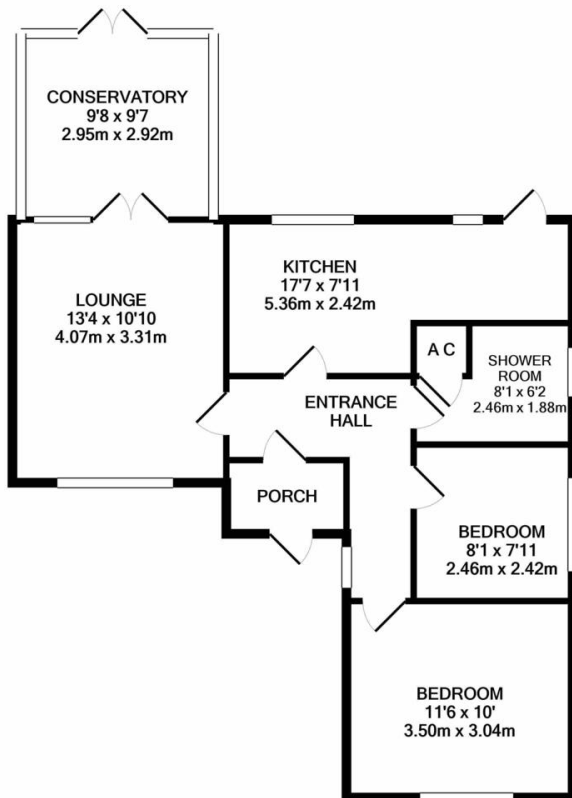

# Property Summary

Very well presented and well proportioned semi detached bungalow for sale in Wigston. The accommodation comprises porch, entrance hall, lounge, conservatory, kitchen, two bedrooms, shower room, front and rear gardens, driveway and detached garage. Bungalows in this condition don't come to the market often, don't miss out, book your viewing today!



FLOOR PLAN BY PHILLIPS GEORGE  
 TOTAL APPROX. FLOOR AREA 672 SQ.FT. (62.4 SQ.M.)

Whilst every attempt has been made to ensure the accuracy of the floor plan contained here, measurements of doors, windows, rooms and any other items are approximate and no responsibility is taken for any error, omission, or mis-statement. This plan is for illustrative purposes only and should be used as such by any prospective purchaser. The services, systems and appliances shown have not been tested and no guarantee as to their operability or efficiency can be given  
 Made with Metropix ©2022

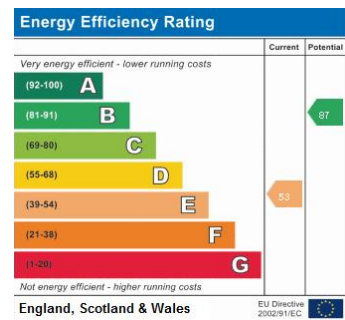

- Semi Detached
- Bungalow
- Well Presented Throughout
- Two Bedrooms
- Conservatory
- Shower Room
- Detached Garage
- Not Overlooked To The Rear

phillips george | sales & lettings

Agents Note: Whilst every care has been taken to prepare these sales particulars, they are for guidance purposes only. All measurements are approximate and for general guidance purposes only and whilst every care has been taken to ensure their accuracy, they should not be relied upon and potential buyers are advised to recheck the measurements

🏠 46 Long Street, Wigston, Leicestershire, LE18 2AH

✉ info@phillipsgeorge.co.uk  
 ☎ 0116 216 8178

