

IVY

PEEL STREET, PARTICKHILL, GLASGOW, G11 5LU

OFFERS OVER £225,000





LARGER STYLE TOP FLOOR 3 BEDROOM
BLONDE SANDSTONE TENEMENT FLAT WITH
SUPERB OPEN VIEWS OVER THE WEST OF
SCOTLAND CRICKET GROUNDS.

Located at the foot of Partickhill, this spacious property benefits from excellent local amenities at Hyndland and Partick with M&S, Sainsbury, Boots & Morrisons within easy walking distance. Partick interchange is a 2 minute walk offering tube, train, bus and taxi rank.

The accommodation comprises, reception hall with storage, large formal bay window lounge with feature fireplace with open views over the cricket grounds, modern, fitted kitchen, 3 double bedrooms -the master bedroom boasting similar open views over the cricket oval- and to complete the layout there is a 3 piece shower room.

The property is heated by a modern system of gas central heating and the communal front door is fitted with a security entry system.

To the rear there is a communal drying green and an access lane for refuse collection.

This larger style flat enjoys an excellent location with really quite special views.

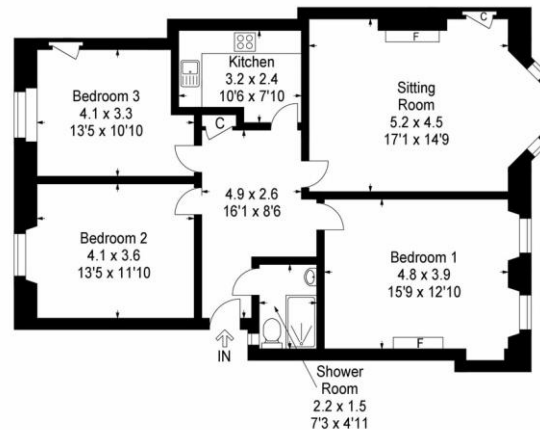

VistaBee IVY
PROPERTY CONSULTANTS

This plan is for layout guidance only and is not drawn to scale. Whilst every care is taken in the preparation of this plan, please check all dimension and shapes before making any decision reliant upon them. All room dimensions taken through cupboard/wardrobes to wall surface where possible or to surfaces indicated by arrow heads. (ID 110927)

© VistaBee 2021