



2 Bedroom Bungalow £180,000

Hebden Close, Redhouse , Swindon, Wiltshire , SN25 2LS

**m<sup>c</sup>farlane**  
property.com

## 2 Bedroom Bungalow

### North Swindon

- SEMI-DETACHED BUNGALOW
- TWO DOUBLE BEDROOMS
- DISABLED ACCESS
- TWO ALLOCATED PARKING SPACES

This is a beautifully presented, EXTREMELY UNIQUE home. Properties of this nature and build are very rare to find in this location and an internal viewing is paramount to appreciate the opportunity on offer. The extremely SPACIOUS and WHEELCHAIR FRIENDLY access comprises of; Large entrance hall, open plan kitchen / dining / living room with dual aspect windows, TWO DOUBLE BEDROOMS and an IMPRESSIVE MODERN BATHROOM suite. The property has TWO ALLOCATED PARKING SPACES within close proximity, bike store and a FANTASTIC LOFT SPACE. Viewings of this rare home are highly recommended.

Service Charge - £1197.95 PA.  
Ground Rent - £175 PA.  
Council Tax Band C  
Council Tax Estimate £1,954







## Ground Floor

Approx. 56.3 sq. metres (605.6 sq. feet)

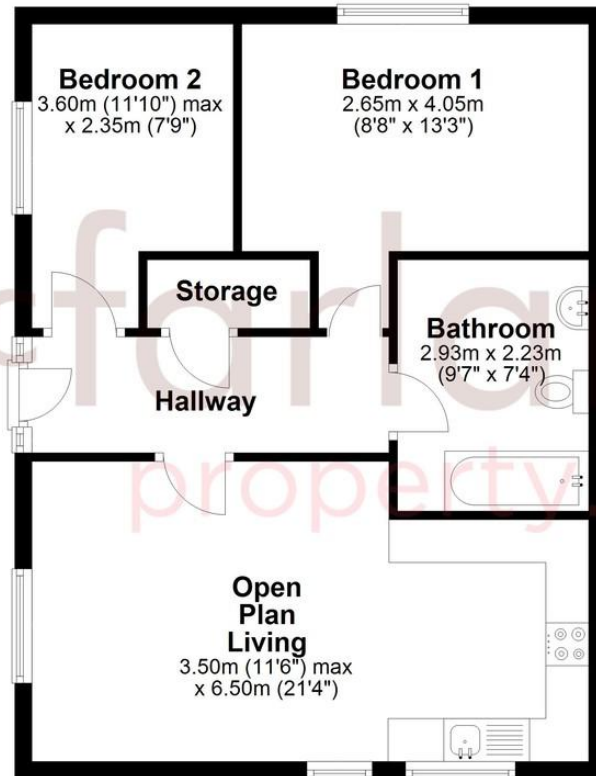

Total area: approx. 56.3 sq. metres (605.6 sq. feet)

We   
where you  
**LIVE**

Our team are friendly, experienced and are all local. They know it better than they do their own living rooms and can help you find what you're looking for because **we love where we live.**

We would be delighted to show you around this property.

**Because every home  
needs a personal touch.**

**If you would like to view this  
property then please get in touch.**

 01793 296600

 [swindon@mcfarlaneproperty.com](mailto:swindon@mcfarlaneproperty.com)

[mcfarlaneproperty.com](http://mcfarlaneproperty.com)

**mcfarlane**  
property.com

### **Cricklade.**

102 High Street  
Cricklade SN6 6AA

 01793 751044

### **Marlborough.**

106 High Street  
Marlborough SN8 1LT

 01672 514380

### **Old Town.**

28-30 Wood Street  
Swindon SN1 4AB

 01793 296880

### **Swindon.**

The Village Centre,  
Redhouse SN25 2FW

 01793 296600

Agents Note: Whilst every care has been taken to prepare these sales particulars, they are for guidance purposes only. All measurements are approximate are for general guidance purposes only and whilst every care has been taken to ensure their accuracy, they should not be relied upon and potential buyers are advised to recheck the measurements