







Hiltons Estates proudly presents this modern and spacious two-bedroom apartment set within a secure, gated residential development in Northolt. Designed for contemporary living, the property features two generous double bedrooms, a stylish bathroom, and a fully fitted open-plan kitchen leading to a bright and airy reception room with wood flooring.

Further benefits include gas central heating, double glazing throughout, and access to a well-maintained communal garden. Ideally positioned next to Northolt Park, the property offers excellent connectivity with both Northolt Park Railway Station and Northolt Underground Station just moments away, along with a wide range of local shops and amenities.

Perfect for first-time buyers, investors, or professionals, this attractive ho

Modern 2-bedroom apartment in a secure gated development

Spacious open-plan kitchen and reception with wood flooring

Two double bedrooms and a stylish bathroom

Double glazed with gas central heating throughout

Access to well-maintained communal gardens



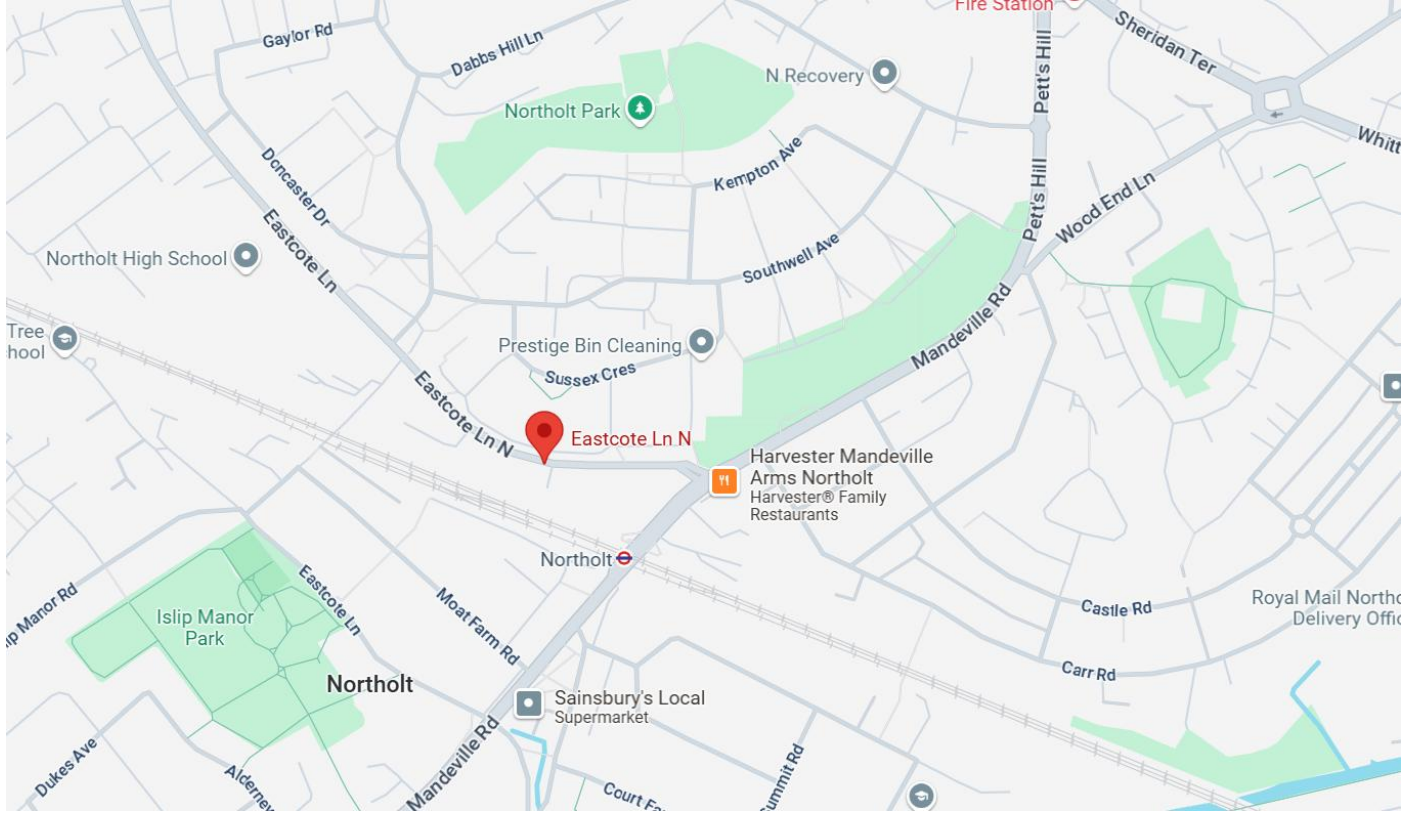



**Furlong House, Eastcote Lane North, Northolt, UB5 4AB**

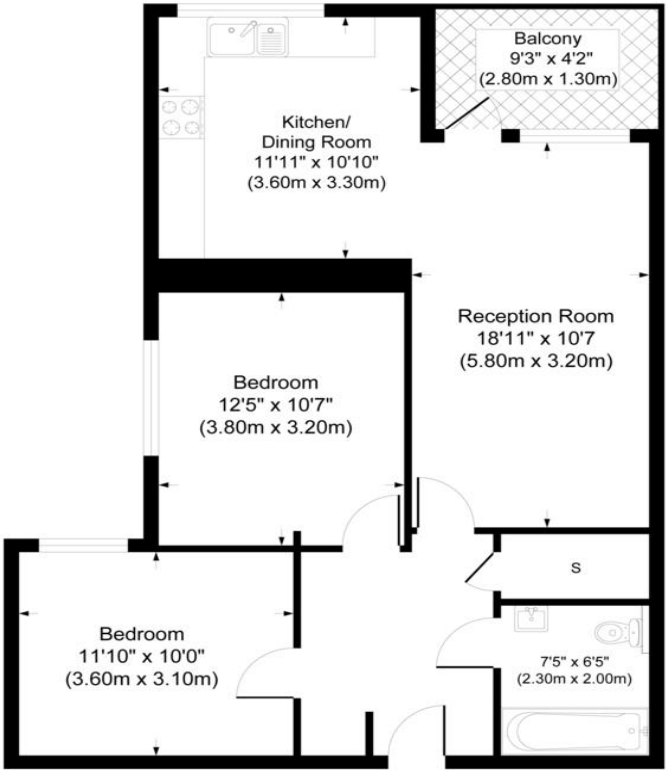

**Second Floor**

**Approx. Gross Internal Floor Area 768 sq. ft / 71.35 sq. m**

Illustration for identification purposes only, measurements are approximate, not to scale  
Produced by [www.Rahuljora.co.uk](http://www.Rahuljora.co.uk)



Score	Energy rating	Current	Potential
92+	<b>A</b>		
81-91	<b>B</b>	83   <b>B</b>	83   <b>B</b>
69-80	<b>C</b>		
55-68	<b>D</b>		
39-54	<b>E</b>		
21-38	<b>F</b>		
1-20	<b>G</b>		