



- Semi Detached House
- 4 Bedrooms
- Ground Floor Cloakroom
- Large "Garden Room"
- Available Immediately
- Electric Heating
- Large Private Drive
- Pet Premium - £20pcm
- EPC Rating: - 'E'

27 The Haven, Littlehampton BN17 6NU

£1,500 pcm

**HAWKE &
METCALFE** 
INDEPENDENT ESTATE AGENTS

Ground Floor

Approx. 43.2 sq. metres (465.5 sq. feet)

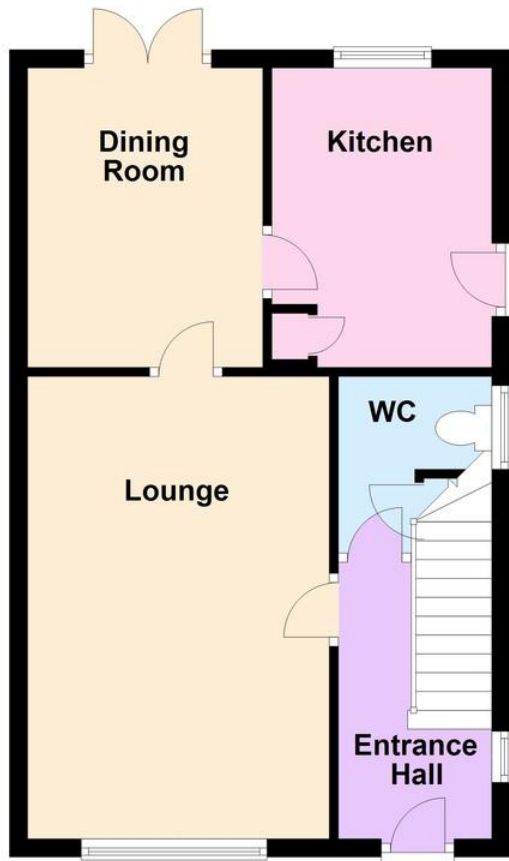

First Floor

Approx. 43.2 sq. metres (465.5 sq. feet)



Total area: approx. 86.5 sq. metres (931.0 sq. feet)

AVAILABLE IMMEDIATELY

A 4 bedroom semi detached house with off road parking for several vehicles and a large feature "garden room". Pets considered and enquiries now being taken.

ENTRANCE HALL

LOUNGE

16' 8" x 10' 10" (5.08m x 3.3m)

DINING ROOM

10' 9" x 8' 5" (3.28m x 2.57m)

KITCHEN

10' 2" x 8' (3.1m x 2.44m)

GROUND FLOOR CLOAKROOM

BEDROOM 1

14' 8" x 9' 2" (4.47m x 2.79m)

BEDROOM 2

10' 3" x 8' 2" (3.12m x 2.49m)

BEDROOM 3

8' 6" x 6' 6" (2.59m x 1.98m)

BEDROOM 4

11' 6 max" x 7' 9" (3.51m x 2.36m)

BATHROOM/WC

LARGE PRIVATE DRIVE

DETACHED "GARDEN ROOM"

19' 1" x 11' 7" (5.82m x 3.53m)

PAVED & LAWNED REAR GARDEN

The information and measurements contained within these details are for guidance only and do not form part of any contract.

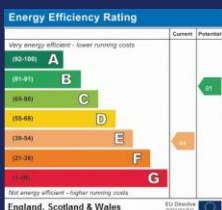

90 THE STREET, RUSTINGTON, WEST
SUSSEX, BN16 3NJ

lettings@hawkemetcalf.co.uk

www.hawkemetcalf.co.uk

01903 850450