



- Semi Detached House
- 4 Bedrooms
- Ground Floor Cloakroom
- Electric Heating
- Large Private Drive
- Available Mid February 2025
- Pet Premium - £20pcm
- Council Tax Band 'D'
- EPC Rating: - 'E'

27 The Haven, Littlehampton BN17 6NU

**£1,550 pcm**

**HAWKE &  
METCALFE**   
INDEPENDENT ESTATE AGENTS

## Ground Floor

Approx. 43.2 sq. metres (465.5 sq. feet)

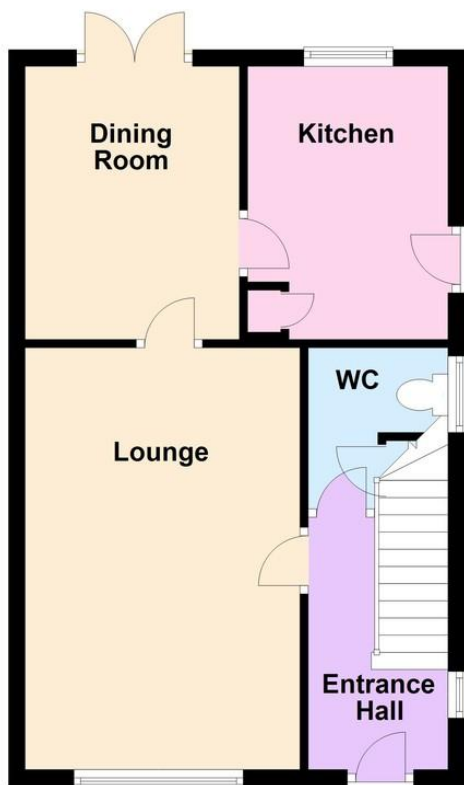

## First Floor

Approx. 43.2 sq. metres (465.5 sq. feet)



Total area: approx. 86.5 sq. metres (931.0 sq. feet)

A 4 bedroom semi detached house with off road parking for several vehicles and a large feature "garden room". Pets considered with a £20pcm pet premium. Available Mid February 2025.

### ENTRANCE HALL

### LOUNGE

16' 8" x 10' 10" (5.08m x 3.3m)

### DINING ROOM

10' 9" x 8' 5" (3.28m x 2.57m)

### KITCHEN

10' 2" x 8' (3.1m x 2.44m)

### GROUND FLOOR CLOAKROOM

### BEDROOM 1

14' 8" x 9' 2" (4.47m x 2.79m)

### BEDROOM 2

10' 3" x 8' 2" (3.12m x 2.49m)

### BEDROOM 3

8' 6" x 6' 6" (2.59m x 1.98m)

### BEDROOM 4

11' 6 max" x 7' 9" (3.51m x 2.36m)

### BATHROOM/WC

### LARGE PRIVATE DRIVE

### DETACHED "GARDEN ROOM"

19' 1" x 11' 7" (5.82m x 3.53m)

### PAVED & LAWNED REAR GARDEN

The information and measurements contained within these details are for guidance only and do not form part of any contract.

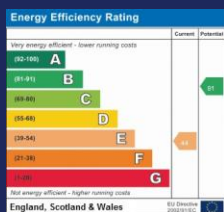

90 THE STREET, RUSTINGTON, WEST  
SUSSEX, BN16 3NJ

lettings@hawkemetcalf.co.uk

www.hawkemetcalf.co.uk

01903 850450