



Alta Vista Road, Goodrington, Paignton, TQ4 6DP

OIEO: £350,000

Tenure: Leasehold



Alta Vista Road, Goodrington, Paignton, TQ4 6DP

A Superb Penthouse Apartment Enjoying Panoramic Sea and Coastal Views

- Penthouse apartment overlooking the beach and coastline towards Brixham
- Presented in excellent order throughout with two double bedrooms
- Lounge with sea facing balcony, kitchen with sea views
- Contemporary fitted bathroom plus en suite shower room
- Garaged parking space and lockable storage facility
- Well tended communal gardens with direct access to the promenade
- Lift access to all floors and garage
- Secure intercom entryphone system
- Favoured location ideal for beach and promenade
- EPC rating - C. Council tax band - E



A unique opportunity to acquire a purpose built apartment in a prime coastal position with stunning coastal views, with a lift to all floors and secure intercom entry...

The apartment benefits from garaged parking space, lift to all floors and south facing balcony being perfect for taking in the views and with space for bistro set. Well presented throughout with tasteful decor, modern fitted kitchen, bathroom and en-suite shower room. There are two double bedrooms both enjoying sea views and views over the park.



Situated in the favoured residential area of Roundham overlooking North Sands beach and promenade, Youngs Park and along the coastline taking in the heritage steam railway line. Roundham offers fantastic amenities including beachside al fresco dining, watersports, bars and cafes. The picturesque harbourside is located over the headland via the South West coast path. The property would make a lovely permanent or second home.

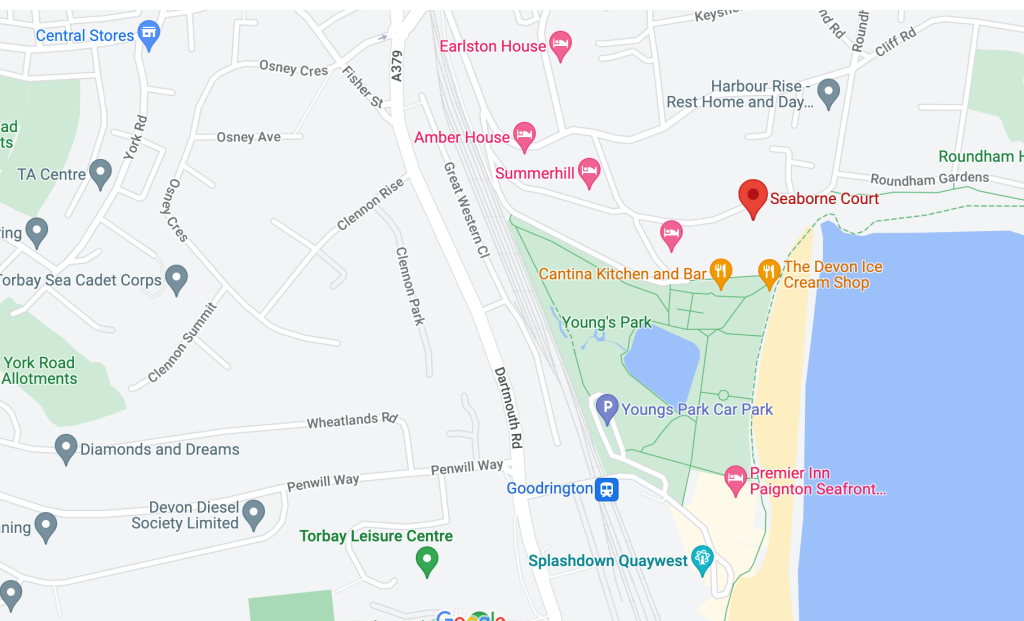

What3Words
 UPRN:
<https://w3w.co/coins.sleep.times>

agents notes:
 Leasehold
 999 year lease from 1988
 1/20th share of freehold
 Maintenance charge is £2,200 PA
 inc ground rent, water rates,
 maintenance of lifts and
 communal areas and buildings
 insurance
 No letting permitted (holiday lets
 or ASTs
 Pets permitted

Top Floor

Approx. 72.3 sq. metres (778.5 sq. feet)

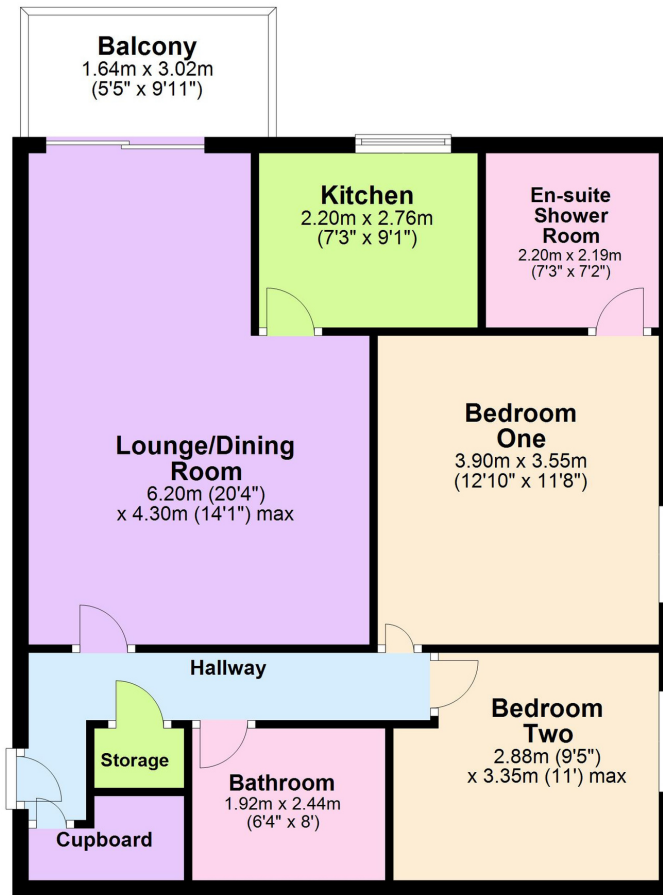

Total area: approx. 72.3 sq. metres (778.5 sq. feet)

Have a property to sell or let?

If you are considering selling or letting your home, get in contact with us today on 01803 214214 to speak with one of our expert team who will be able to provide you with a free valuation of your home.



We refer potential purchasers to Sheehan Legal for conveyancing, Greenlight Mortgages for mortgages, McCluskey Surveyors for surveying & Team Removals for removals. It is your decision if you choose to deal with any of these companies however should you choose to use them we would receive a referral fee from them for recommending you to them as follows: Sheehan Legal £150, Greenlight Mortgages £50 to £300, McCluskey Surveyors £50, Team Removals £50. We have carefully selected these associates for the quality of their work and customer service levels.

Consumer Protection Regulations: We have not tested any apparatus, equipment, fixtures and fittings or services and so cannot verify that they are in working order or fit for the purpose. References to the Tenure of a Property are based on information supplied by the seller. We have not had sight of the Title Documents. A buyer is advised to obtain verification from their solicitor or surveyor. Floorplans shown are for guidance only and should not be relied upon. Items shown in photographs are NOT included unless specifically mentioned within these details. They may however be able by separate negotiation. You are advised to check the availability of this property before travelling any distance to view. Particulars are produced in good faith to the best of our knowledge and are set out as a general guide only.

