



- Semi Detached House
- 3 Bedrooms
- En Suite Shower Room/WC
- South Rear Garden
- 2 Allocated Parking Spaces
- Available Immediately
- Pet Premium - £20 pcm
- Council Tax Band - 'C'
- EPC Rating: - 'B'

10 Kelen Gardens, Littlehampton BN17 7FS
£1,400 pcm



Ground Floor

Approx. 42.7 sq. metres (459.2 sq. feet)

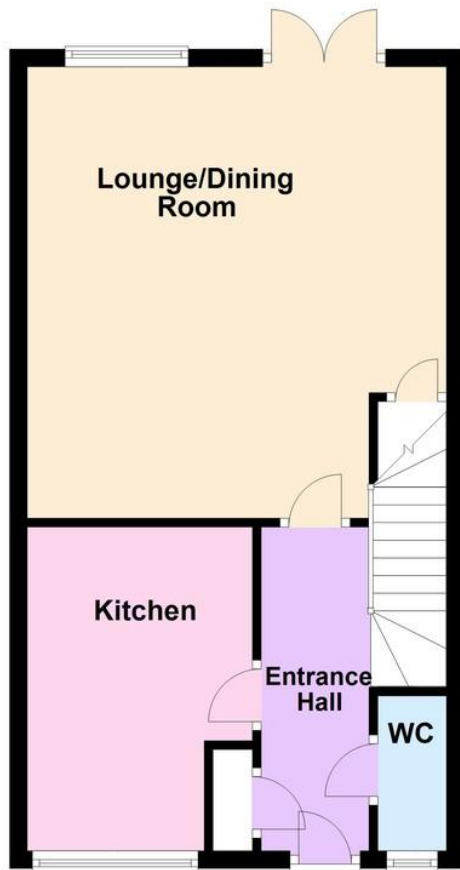

First Floor

Approx. 42.7 sq. metres (459.2 sq. feet)

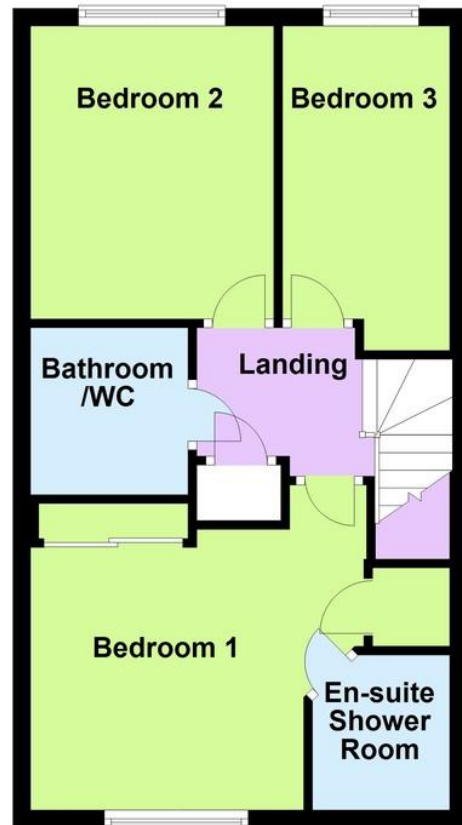

Total area: approx. 85.3 sq. metres (918.3 sq. feet)

Modern three bedroom semi detached house with en suite shower room/WC to bedroom one and an additional bathroom/WC. Features include gas central heating, ground floor cloakroom, double glazing, modern kitchen with some built in appliances, south facing rear garden and 2 allocated parking spaces. Pets considered. Council Tax Band 'C'

ENTRANCE HALL

GROUND FLOOR CLOAKROOM

KITCHEN

12' x 8' 5" (3.66m x 2.57m)

LOUNGE/DINING ROOM

16' 10" x 15' 8" (5.13m x 4.78m)

BEDROOM 1

10' x 8' 11 min" (3.05m x 2.72m)

EN SUITE SHOWER ROOM/WC

BEDROOM 2

10' 11" x 9' 1" (3.33m x 2.77m)

BEDROOM 3

12' 1" x 6' 2 max" (3.68m x 1.88m)

SOUTH REAR GARDEN

2 ALLOCATED PARKING SPACES

The information and measurements contained within these details are for guidance only and do not form part of any contract.

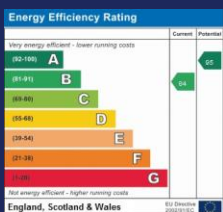

90 THE STREET, RUSTINGTON, WEST
SUSSEX, BN16 3NJ

lettings@hawkemetcalf.co.uk

www.hawkemetcalf.co.uk

01903 850450