

Julian Reid



84a Finsbury Park Road, London, N4 2JT

A two bedroom flat with further study arranged over the ground floor of a Victorian house. The property offers light and well proportioned rooms, with sole use of patio garden.. Available 20th September and offered unfurnished.

£2,350 per calendar month

- Two bedrooms
- Council Tax Band: D
- EPC Rating: 57
- Separate study
- Patio garden

ALL VIEWING SLOTS NOW TAKENA two bedroom flat with further study arranged over the ground floor of a large end of terrace Victorian house. The property offers light and well proportioned living space and has sole use of a patio garden. Well placed for excellent transport and local shops. Available 20th September and offered unfurnished.



Julian Reid
51 Stoke Newington Church Street London N16 0AR
jreid@julianreid.co.uk Fax: 020 7923 8651
+44 (0) 20 7923 8650

Finsbury Park Road, N4

Approximate Gross Internal Area
Ground Floor = 701 sq ft / 65.12 sq m
Total = 701 sq ft / 65.12 sq m

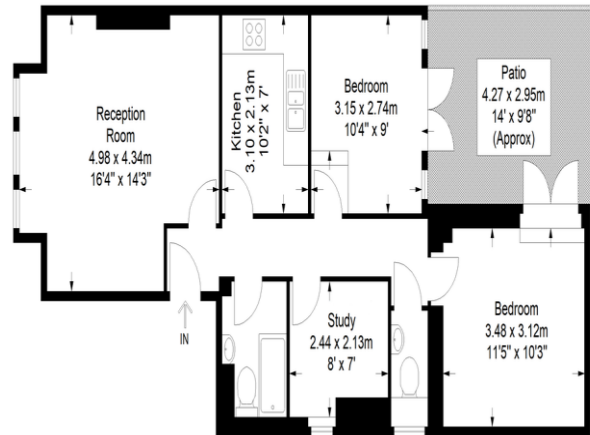

Ground Floor

JULIAN REID SPECIAL DISCLAIMER:-
For Illustration Purposes Only - Not To Scale
Floor plan For Julian Reid

Important notice: Julian Reid, their clients and any joint agents give notice that: 1: They are not authorized to make or give representations or warranties in relation to the property either here or elsewhere, either on their own behalf or on behalf of the client or otherwise. They assume no responsibility for any statement that may be made in these particulars. These particulars do not form part of any offer or contract and must not be relied upon as statements or representations of fact. 2: Any areas, measurements or distances are approximate. The text, photographs and plans are for guidance only and are not necessarily comprehensive. It should not be assumed that the property has all necessary planning, building regulation or other consents and Julian Reid have not tested any services, equipment or facilities. Purchasers must satisfy themselves by inspection or otherwise.



J352 Ravensworth 01670 713330