



Denham Court
Atherstone
£189,950

*** REFITTED MODERN END TERRACE - EDGE OF TOWN LOCATION - ALLOCATED PARKING ***. For sale with MARK WEBSTER estate agents is this very well situated property briefly comprising: Reception hall, lounge, re-fitted kitchen/diner, three bedrooms, re-fitted bathroom, enclosed rear garden and allocated parking.

ENTRANCE HALL

Having an opaque double glazed entrance door, laminated wooden effect flooring, stairs leading off to the first floor landing and a door to the lounge.

LOUNGE

15' 5" x 11' 4" (4.7m x 3.45m)

Double glazed bay window to front aspect, feature fireplace, laminated wooden effect flooring and a door to the kitchen/diner.

REFITTED KITCHEN/DINER

14' 5" x 10' 7" (4.39m x 3.23m)

Double glazed French doors leading out to the rear garden, single panelled radiator, tiled floor, door to an under stairs storage cupboard, double glazed window to rear aspect, wide range of re-fitted 'Shaker' style base and eye level units, tall unit housing the stainless steel electric oven and microwave, marble effect square edge work surfaces, integrated slim line dishwasher, stainless steel gas hob with a stainless steel extractor hood above, space for a fridge freezer, attractive tiling to splash back areas.

FIRST FLOOR LANDING

Access to the roof storage space and doors leading off to...

BEDROOM ONE

9' 5" x 12' 5" to the fitted wardrobes (2.87m x 3.78m)

Double glazed window to front aspect and fitted wardrobes with folding mirrored doors.

BEDROOM TWO

10' 9" x 7' 2" (3.28m x 2.18m)

Double glazed window to rear aspect, single panelled radiator and laminated wooden effect flooring.



BEDROOM THREE

7' 8" x 7' 0" (2.34m x 2.13m)

Double glazed window to rear aspect and a single panelled radiator.

REFITTED BATHROOM

7' 7" x 5' 6" (2.31m x 1.68m)

Recessed LED ceiling down lights, column style radiator with a chrome towel rail, low level WC, wash basin with useful storage beneath, traditional style bath with a chrome mixer shower over having a rainfall style shower head, attractive tiled floor and splash back areas.

FIXTURES & FITTINGS: Some items maybe available subject to separate negotiation.

SERVICES: We understand that all mains services are connected.

COUNCIL TAX BAND: B.

ANNUAL CHARGE: £95.00 payable to Denham Court Limited Service Charges.

TENURE: We have been informed that the property is FREEHOLD, however we would advise any potential purchaser to verify this through their own Solicitor.

DISCLAIMER: DETAILS HAVE NOT BEEN VERIFIED BY THE OWNERS OF THE PROPERTY AND THEREFORE MAY BE SUBJECT TO CHANGE AND ANY PROSPECTIVE PURCHASER SHOULD VERIFY THESE FACTS BEFORE PROCEEDING FURTHER.



131 Long Street
Atherstone, Warwickshire
CV9 1AD

www.markwebsterandco.co.uk
01827 720 777

Mon – Fri: 9:00am – 5:30pm
Sat: 9:00am – 4:00pm

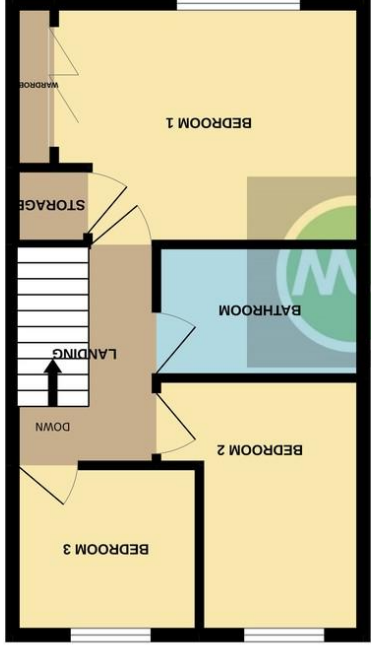
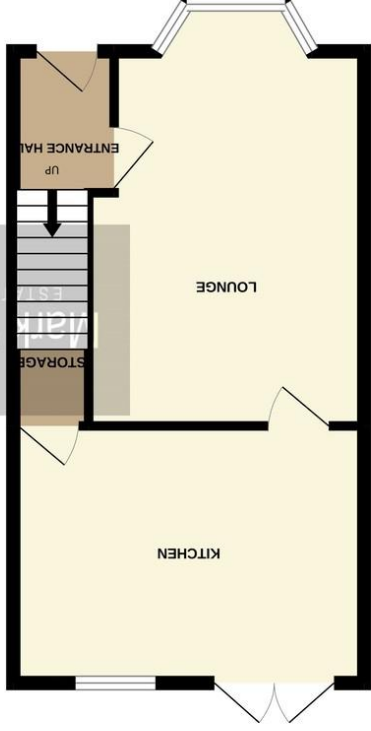

Whilst every attempt has been made to ensure the accuracy of the floorplan contained here, measurements of doors, windows, rooms and any other items are approximate and no responsibility is taken for any error, omission or mis-statement. This plan is for illustrative purposes only and should be used as such by any prospective purchaser. The services, systems and appliances shown have not been tested and no guarantee as to their operability or efficiency can be given.
Made with Metropix ©2022

Misrepresentation Act 1937 – These details are prepared as a general guide only and should not be relied upon as a basis to enter into legal contract or to commit expenditure. An interested party should consult their own surveyor, solicitor or other professionals before committing themselves to any expenditure or other information from the Agent, then a request should be made and upon any information provided. The agent will not be responsible for any specific written confirmation made by any member of staff, as only specific written confirmation should be relied on. The Agent will not be responsible for any loss other than when specific information has been requested.

Property Mis-description Act 1991 – The Agent has not tested any apparatus, equipment, fixtures or services and so does not verify they are in working order, fit for their purpose or within ownership of the sellers, therefore the buyer must assume the information given is incorrect. Neither has the Agent checked the legal status of the property or the validity of any guarantee. Buyers must assume the information is incorrect, until their own solicitors have verified it. The measurements supplied are for general guidance and as such must be considered incorrect. A buyer is advised to re-check the measurements themselves before committing themselves to any expense. Nothing concerning the type of construction of the condition of the structure is to be implied from the photograph of the property. The sales particulars may change in course of time, and any interested part is advised to make final inspection of the property prior to exchange of contracts.

COMPANY DISCLAIMER – All fixtures, fittings, appliances and services have not been tested and therefore no guarantee can be given that they are in working order. While we endeavour to make our sales particulars reliable and accurate, measurements quoted are approximate and for guidance only. Photographs are for illustration only and may depict items not included in the sale of the property.