

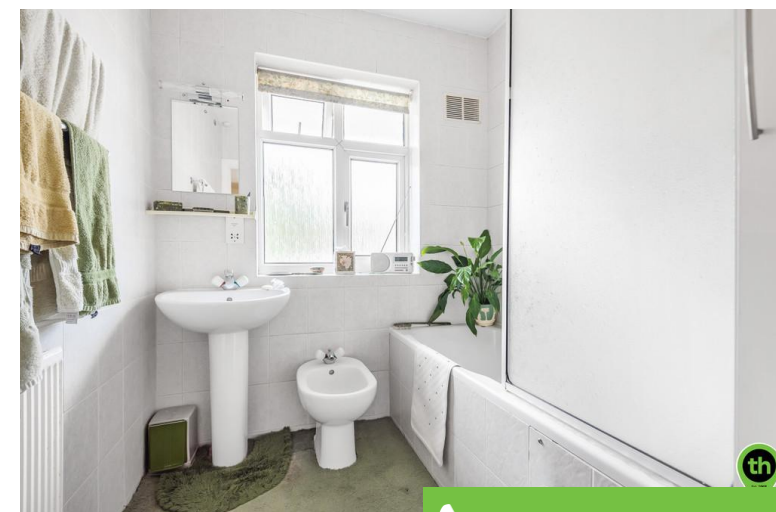

‘Sherwood’ Mill Ridge

Guide Price £925,000

'Sherwood' is a three bedroom detached family residence situated in this popular cul-de-sac just off Stonegrove. The property is within easy reach of Central Edgware (0.35M), Canons Park Jubilee Line Underground (0.7M), Stanmore Jubilee Line Underground (less than 1M) and Stonegrove Park (0.1M) as well as many local schools and places of worship.



 020 8958 2222

Sherwood, Mill Ridge, Edgware, HA8

Approximate Area = 1479 sq ft / 137.4 sq m (excludes boiler room)

For identification only - Not to scale

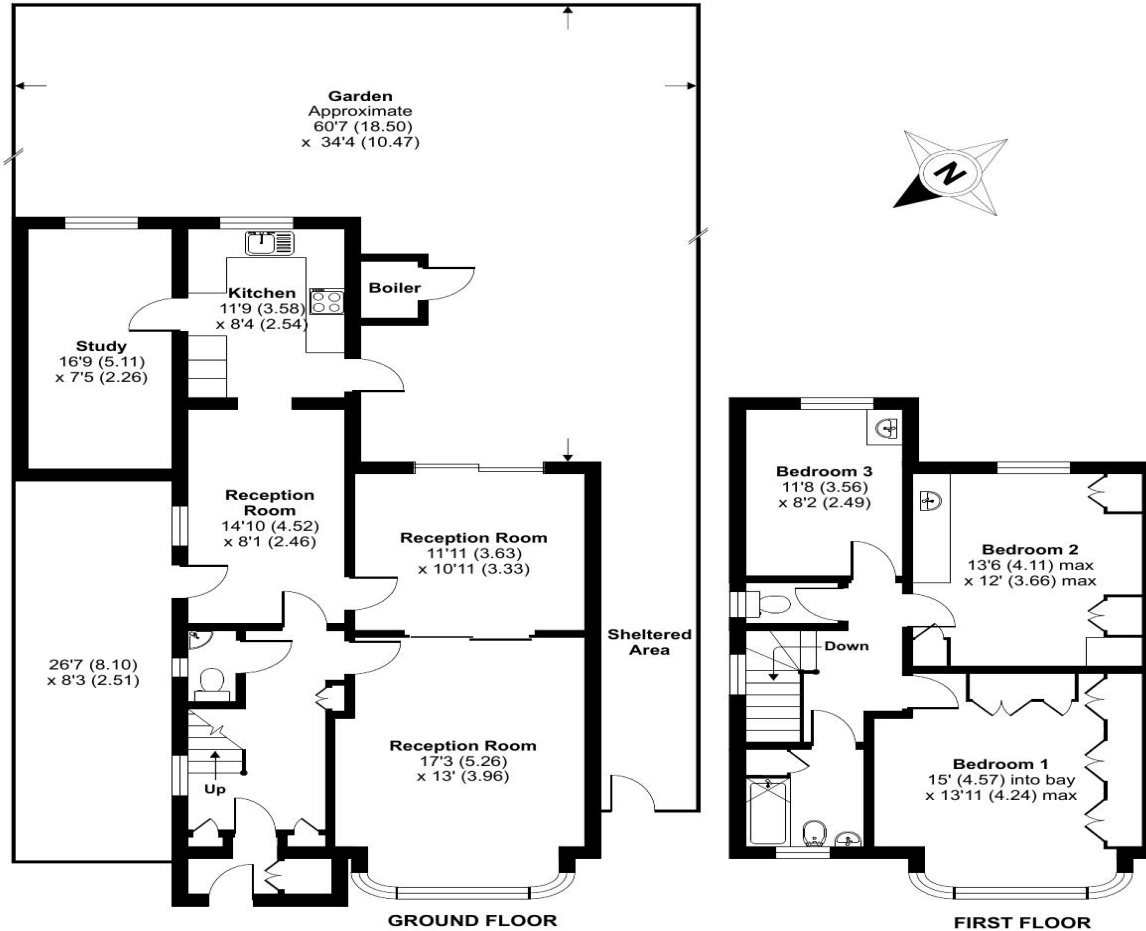

Score	Energy rating	Current	Potential
92+	A		
81-91	B		
69-80	C		78 c
55-68	D		
39-54	E	53 e	
21-38	F		
1-20	G		



Floor plan produced in accordance with RICS Property Measurement Standards incorporating International Property Measurement Standards (IPMS2 Residential). © n̄che.com 2022. Produced for Taylor Hawkins. REF: 865647

58 Edgware Way
Edgware
Middlesex
HA8 8DJ

www.taylorhawkins.net
property@taylorhawkins.co.uk
020 8958 2222

Agents Note: Whilst every care has been taken to prepare these sales particulars, they are for guidance purposes only. All measurements are approximate are for general guidance purposes only and whilst every care has been taken to ensure their accuracy, they should not be relied upon and potential buyers are advised to recheck the measurements