



- An Amazing First Floor Three Bedroom Purpose Built Apartment
- Stunning Contemporary Development With Fantastic Views Over The Cricket Ground
- Bathroom And En-Suite Shower Room

Palmeira Avenue, Hove, BN3 3GE

Asking Price Of £700,000

If you are looking for a flat that ticks all the boxes then look no further than this stunning three bedroom first floor apartment located in this fabulous contemporary building in the heart of Hove. The property offers fantastic views over the County Cricket Ground, has its own private terrace superb open plan living space as well as private allocated parking.



Property Description

This stunning contemporary development sits in the very heart of Hove and as hinted by its name overlooks Sussex County Cricket Ground. The development is only a couple of years old and so retains that very new feel that comes with new homes.

This superb apartment is on the first floor and has bright and spacious open plan living accommodation which would undoubtedly be the centre piece of the home and is the perfect place for entertaining family and friends. The kitchen has been custom made with feature quartz work surfaces, integrated appliances and built-in units with handleless soft close doors and drawers.

The master bedroom has built in wardrobes, a modern en-suite shower room and double doors leading to the private terrace. There are two further double bedrooms with the third bedroom having the flexibility to be used as a study or TV room if preferred. The private terrace is cleverly positioned to the rear of the apartment to take advantage of the views to the Cricket Ground and there is an allocated parking space in the secure underground car park exclusive to the block.

Innings House is located in the very heart of Hove and is within easy reach of the extensive shops, bars & restaurants in both Church Road and nearby Western Road. Hove railway station is also within just over half a mile, making this a great buy for commuters or for anyone from London looking for a second home.

Sussex County Cricket Ground is literally right on the doorstep and Hove seafront is also just a short distance away. This amazing apartment offers a very contemporary city centre lifestyle with all of the benefits that a cosmopolitan city such as Brighton & Hove has to offer.

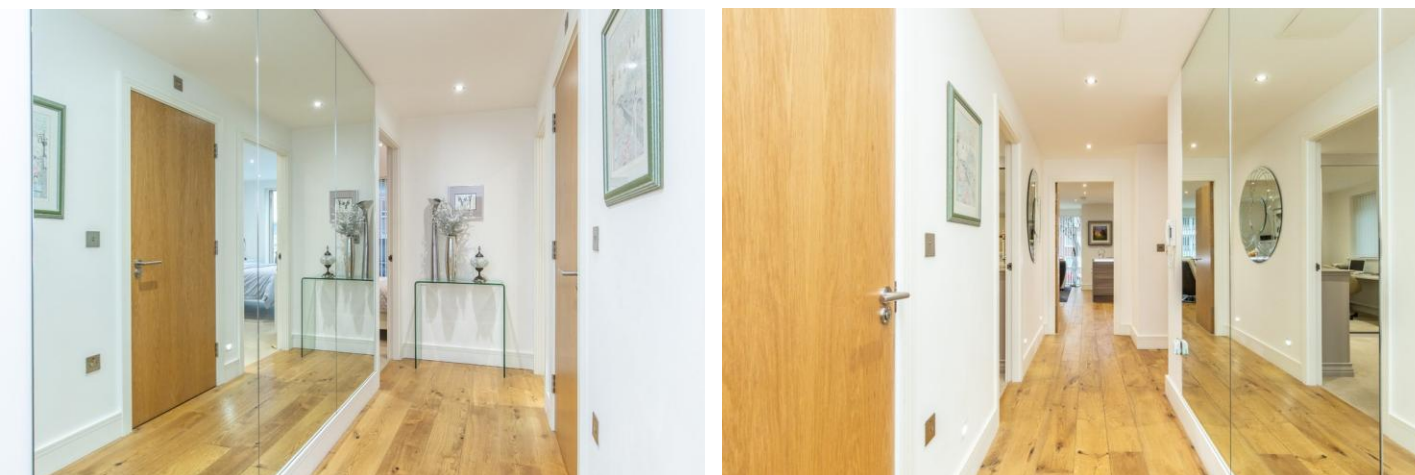

Accommodation

FIRST FLOOR

ENTRANCE HALL

STORAGE CUPBOARD

OPEN PLAN LIVING/DINING ROOM
19' 8" x 8' 10" (5.99m x 2.69m)

OPEN PLAN KITCHEN/BREAKFAST ROOM
19' 8" x 9' 10" (5.99m x 3m)

STUDY/BEDROOM 3
10' 6" x 8' 10" (3.2m x 2.69m)

BATHROOM

BEDROOM 2
15' 1" x 8' 10" (4.6m x 2.69m)

MASTER BEDROOM
13' 1" x 10' 2" (3.99m x 3.1m)

ENSUITE SHOWER ROOM

OUTSIDE

TERRACE
9' 11" x 9' 3" (3.02m x 2.82m)

ALLOCATED PARKING



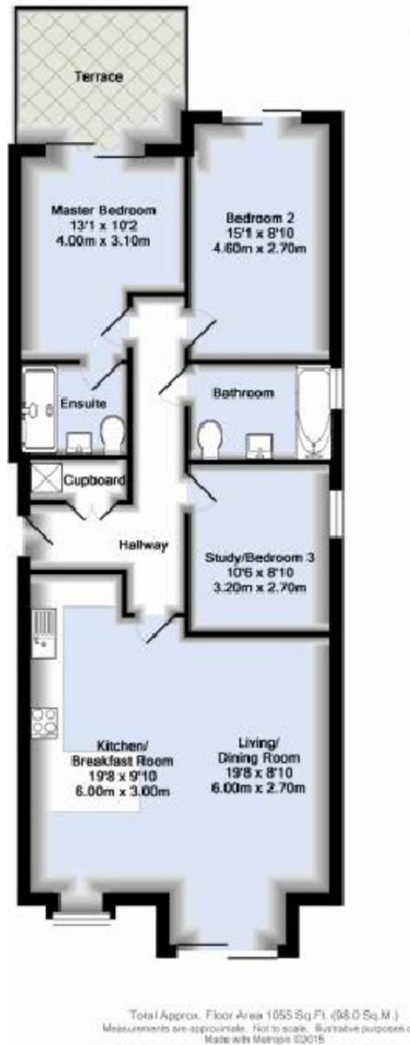

Picture this...

This location is all about the buzz and atmosphere of City living! You can either take a short stroll down to Adelaide Crescent to enjoy their gardens and throw down a rug and enjoy a picnic or pop along to Western Road and spend an afternoon shopping.

Alternatively, why not take a short walk to the seafront and watch the beautiful sunsets this City has to offer

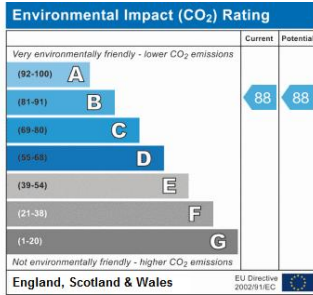
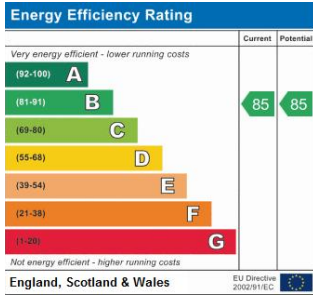

Agents Note: Whilst every care has been taken to prepare these sales particulars, they are for guidance purposes only. All measurements are approximate and for general guidance purposes only and whilst every care has been taken to ensure their accuracy, they should not be relied upon and potential buyers are advised to recheck the measurements

112 Western Road
 Brighton
 East Sussex
 BN1 2AB

www.phillipsandstill.co.uk
 01273 771111
 westernrd@phillipsandstill.co.uk

Mon-Fri: 8.30am – 5:30pm
 Sat: 9am - 4pm

