



**Singlewell Road, Gravesend, DA11 7PU**  
£275,000 Freehold House

**independent  
london.**   
Right place. Right people.

# Singlewell Road, Gravesend

£275,000 asking price

**Freehold House for sale**  
**A three-bedroom terraced house in**  
**Gravesend, Kent**

A three-bedroom terraced house. The house is located in Gravesend and is within walking distance of the train station and has good links to the A2 and the M25.

Affordable three beds are becoming harder to find in this area, so this property is well worth viewing.

Viewing is by appointment only and email enquiries are an essential first step in the process of arranging a viewing so please enquire online before you call.

EPC Rating E  
Council Tax Band C  
Gravesend Train Station  
Links with M25 and A2



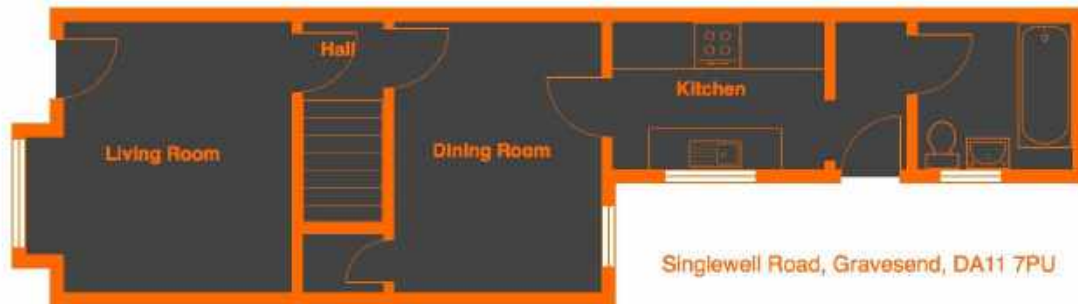

Asking Price: £275,000  
Age: Victorian  
Property Style: Terrace House  
Freehold: Yes  
Location: Gravesend  
Borough: Gravesham  
Bedrooms: 3  
Bathrooms: 1  
Council Tax Band: C  
EPC Rating: E  
Parking: Street  
Nearest Transport:  
Gravesend Train Station, A2 and M25

All rooms have been measured with electronic laser and are approximate measurements only. None of the services to the above property have been tested by ourselves, and we cannot guarantee that the installations described in the details are in perfect working order. Independent London Lettings for themselves, and for the vendors or lessors, produce these brochures in good faith, and are a guideline only. They do not constitute any part of a contract and are correct to the best of our knowledge at the time of going to press.

Independent London  
6-8 Cole Street, Trinity Village,  
London SE1 4YH  
t: 020 7099 6373  
e: hello@independentlondon.net

[independentlondon.co.uk](http://independentlondon.co.uk)  
Landlords ask for The 5% Let Only  
Service from Independent London

