

# THE PERIDOT

## A 4 BEDROOM HOUSE

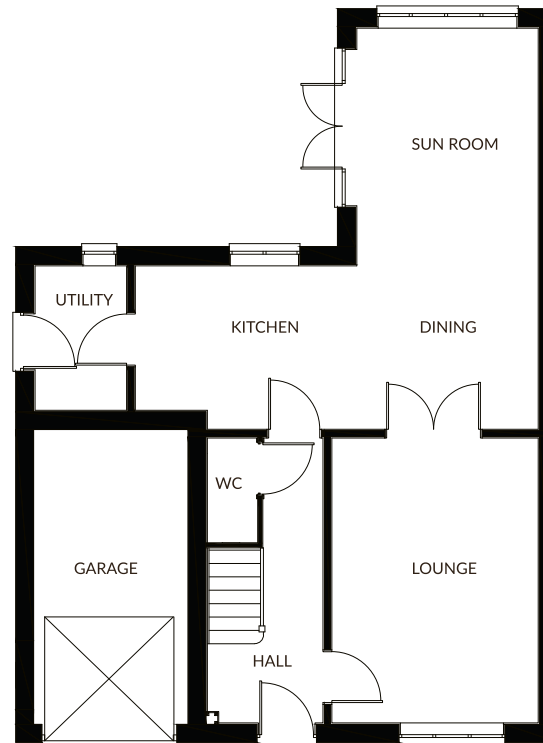

CYDENHOMES.CO.UK



### GROUND FLOOR

LOUNGE	4830 X 3500	15'10" X 11'5"
WC	1775 X 845	3'10" X 2'9"
DINING ROOM	2770 X 3076	9'1" X 10'1"
KITCHEN	2770(MAX) X 3754	9'1" X 12'3"
GARAGE	5000 X 2620	16'4" X 11'10"
UTILITY	2450 X 1550	8'0" X 5'1"
SUN ROOM	4030 X 3076	13'2" X 10'1"

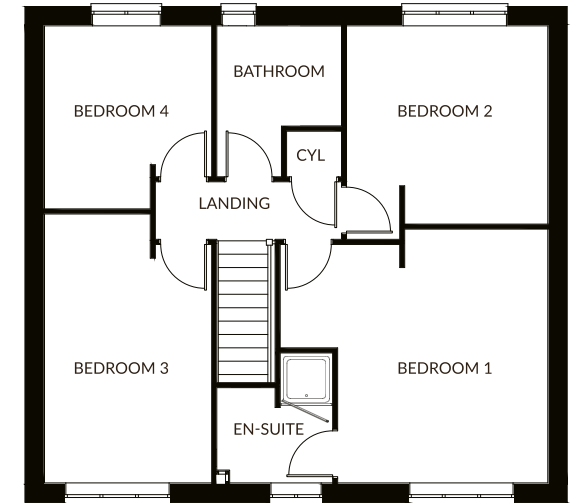

### FIRST FLOOR

BEDROOM 1	3653(MIN) X 3560(MIN)	11'11" X 11'8"
EN-SUITE	1280(MIN) X 1964	4'2" X 6'5"
BEDROOM 2	2711(MIN) X 3410	8'10" X 11'2"
BEDROOM 3	3810(MIN) X 2834	12'6" X 9'3"
BEDROOM 4	2355(MIN) X 2834	7'8" X 9'3"
BATHROOM	1700(MIN) X 2114	5'6" X 6'11"

**CONSUMER  
CODE FOR  
HOME BUILDERS**  
[www.consumercode.co.uk](http://www.consumercode.co.uk)

Whilst these particulars are prepared with due care for the convenience of the intending purchasers, the information contained therein is intended as a preliminary guide only. The photographs are of similar house types and may vary in terms of finish, detail and can be built in terraced, semi-detached or detached forms. Please ask your New Homes Sales Advisor for details. The right is expressly reserved by the company to amend or vary the same, and therefore nothing herein contained shall constitute or form part of any contract. The house type photograph is of a similar property.