



♥ 2 Bedroom Mid Terraced House **Offers In Excess Of £190,000**
Camden Close, Grange Park, Swindon, SN5 6BU

mcfarlane
property.com

2 Bedroom Mid Terraced House West Swindon

-
- **IDEAL INVESTMENT OR FIRST PURCHASE**
 - **TWO BEDROOM TERRACED HOUSE**
 - **POPULAR WEST SWINDON LOCATION**
-

- IDEAL INVESTMENT OPPORTUNITY - TWO DOUBLE BEDROOM TERRACED HOUSE - CUL-DE-SAC LOCATION IN WEST SWINDON - NO ONWARD CHAIN -

An excellent opportunity to acquire a two double bedroom terraced house which occupies a lovely position in a quiet cul-de-sac in West Swindon. The accommodation comprises: Lounge/Dining room, Fitted Kitchen with rear aspect over the garden, Landing, Two double Bedrooms and Bathroom. Additionally there is gas central heating and double glazing. Outside there are Enclosed Rear Gardens and Off Street Parking. No Onward Chain.





We 
where you
LIVE

Our team are friendly, experienced and are all local. They know it better than they do their own living rooms and can help you find what you're looking for because **we love where we live.**

We would be delighted to show you around this property.

**Because every home
needs a personal touch.**

Tim Stanley
Sales Manager, Cricklade



☎ 01793 751044

✉ tim@mcfarlaneproperty.com

mcfarlaneproperty.com

Ground Floor

Approx. 29.4 sq. metres (316.0 sq. feet)

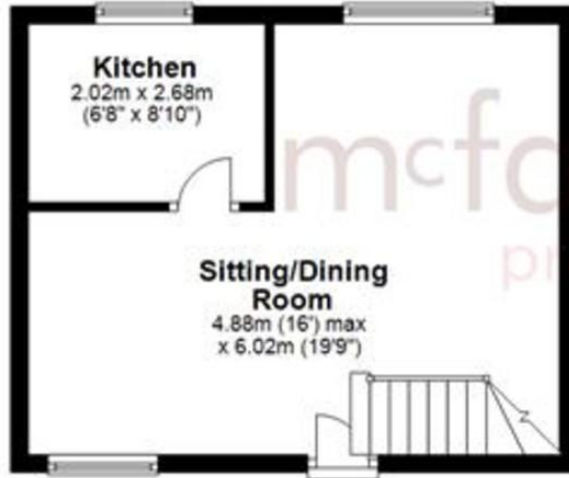

First Floor

Approx. 29.4 sq. metres (315.9 sq. feet)

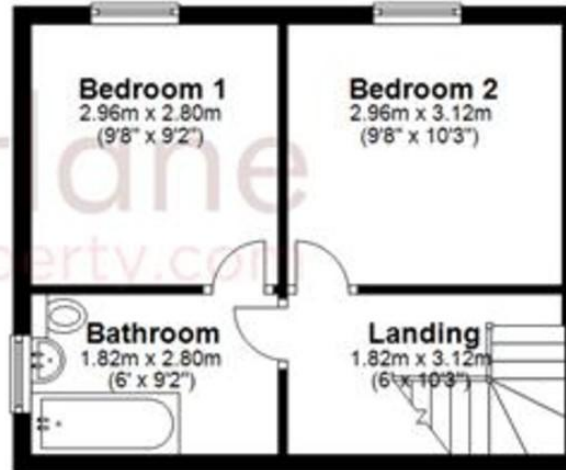

Total area: approx. 58.7 sq. metres (631.9 sq. feet)

mcfarlane
property.com

Swindon.
28-30 Wood Street
Swindon SN1 4AB
☎ 01793 611841

Cricklade.
102 High Street
Cricklade SN6 6AA
☎ 01793 751044

Marlborough.
106 High Street
Marlborough SN8 1LT
☎ 01672 514380

Agents Note: Whilst every care has been taken to prepare these sales particulars, they are for guidance purposes only. All measurements are approximate and for general guidance purposes only and whilst every care has been taken to ensure their accuracy, they should not be relied upon and potential buyers are advised to recheck the measurements