



Owen
Isherwood
CHARTERED SURVEYORS

TO LET

Industrial/Warehouse/Office
2.5-acre site

Lian Yard, Redhill Road, Cobham, Surrey KT11 1EG

Cars Parked on Truckpave Area
 This configuration: 236 cars or vans.

No.	Date	Revision
1	10 Mar 2022	Issue for tender

Client	Challenge Training Ltd enquiries@challengetraining.com 01462 224726
Site	LIAN YARD Redhill Rd Coburn KT11 1EG
SITE PLAN Car Park Study	
Scale	1:500 @ A3
Drawn by	WS-LY057

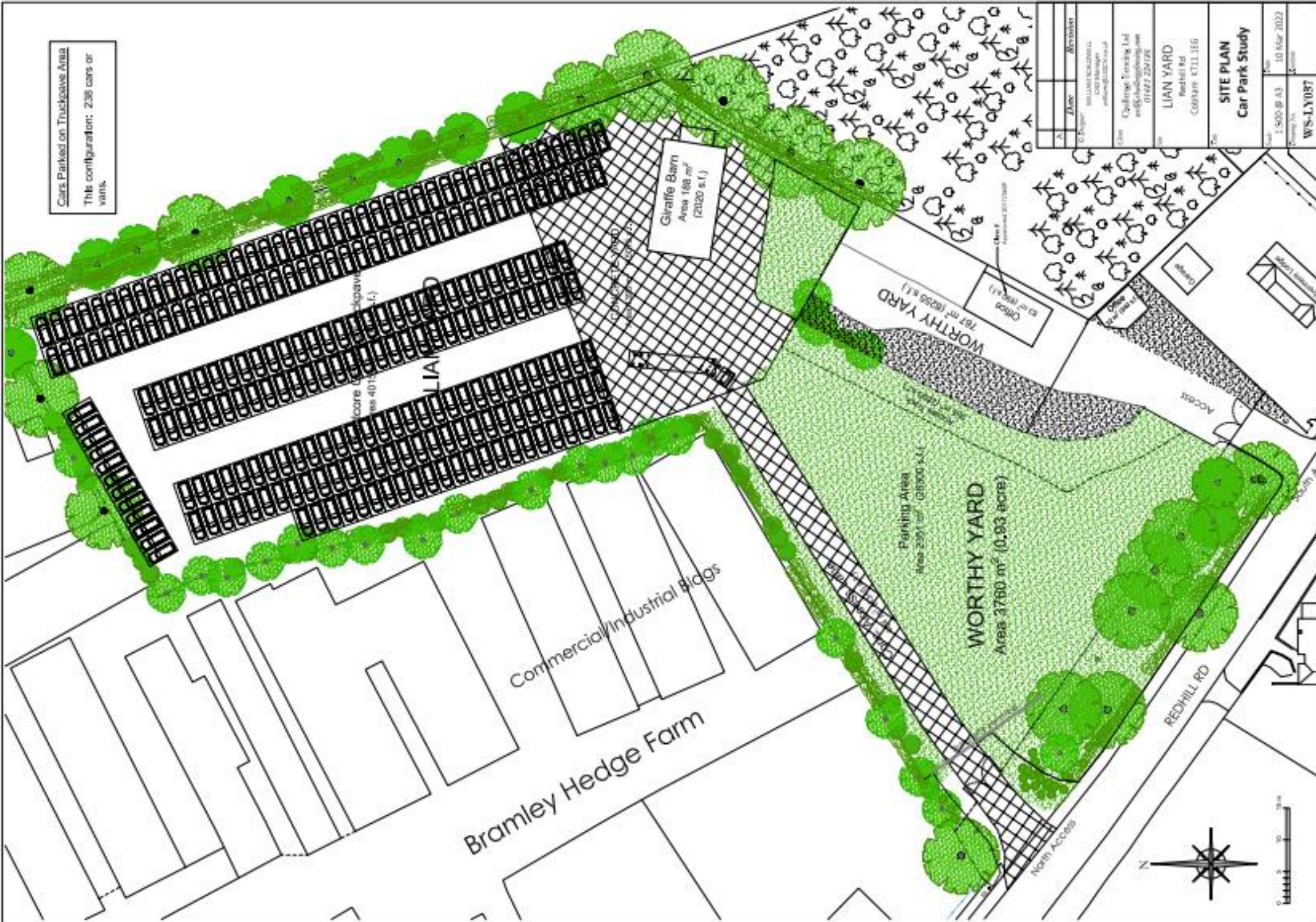

LOCATION

This is an exciting & unusual site that is found in one of the wealthiest parts of the UK. The site is situated next to A3 & M25 junction 10. It is Located at a 10 -15 minutes drive from Byfleet, Woking and Walton train stations. With the M25 just round the corner, there are excellent road connections to both Heathrow & Gatwick, both about a 20 minutes drive away.

DESCRIPTION

2.5-acre site with Industrial and Open Storage to Let as whole or as part. Close to A3/M25, Brooklands Industrial Park and St Georges hill Estate

If visiting the site is at the **end of Redhill Road** on the left-hand side just before Silvermere lodge which is the last white bungalow on the left-hand side.

ACCOMMODATION

- Nissen-style hut 2190 ft² with office, WC shower unit and associated concrete Yard.
- 23000 ft² hard standing for large number of mobile vehicles. Restrictions on storage.

RENT

Price on Application

TERMS

New leases are available with terms to be agreed.

RATES

To be assessed

LEGAL COSTS

Each party to bear their own legal costs incurred in the transaction.



These particulars do not constitute, or form any part of, any offer or contract, and whilst all the information given is believed to be correct, all interested parties must satisfy themselves of its accuracy. All prices and rents are quoted exclusive of VAT, unless otherwise stated.

T: 01483 300 176

www.owenisherwood.com

1 WEY COURT, MARY ROAD, GUILDFORD GU1 4QU

CONTACT

Kieran Morgan

T: 01483 300 176

M: 07904377405

E: kieran@owenisherwood.com