





Hiltons Estates brings to the market this Freehold detached 4 bedroom property located in TW5. The property comprises an entrance hallway, 3 well sized reception rooms, bedroom 4, fully fitted kitchen, and shower room on the ground floor. Upstairs, there are 3 well sized bedrooms and family bathroom. There is a paved driveway and a large rear garden with patio area. There is opportunity to extend (STPP). Close by to local shops, schools, amenities. Hounslow West and Hounslow Central Underground stations are within easy reach as are transport links. Brilliant opportunity for Families, Commuters and Investors! Call NOW for further details, not to be missed.

Spacious 4 bedroom Detached Property

Three Reception Rooms, 2 baths

Off road parking, large rear garden

Close to local shops, schools, transport links

Call NOW for further details not to be missed,
Viewings Available



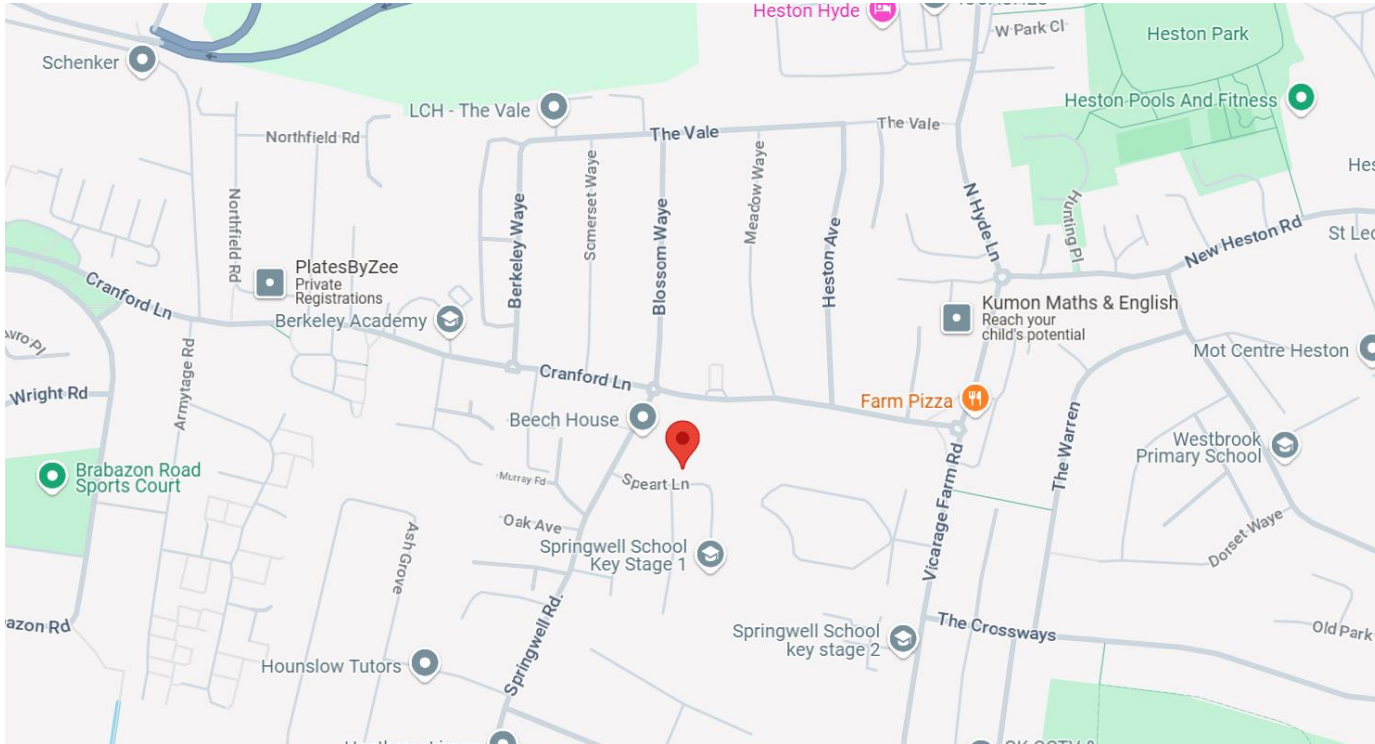

GROUND FLOOR
1090 sq.ft. (101.3 sq.m.) approx.

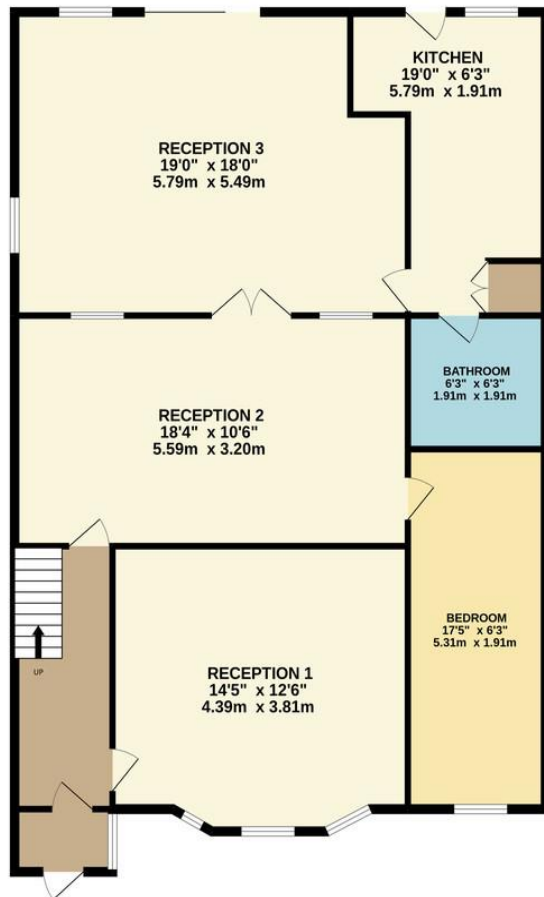

1ST FLOOR
556 sq.ft. (51.7 sq.m.) approx.

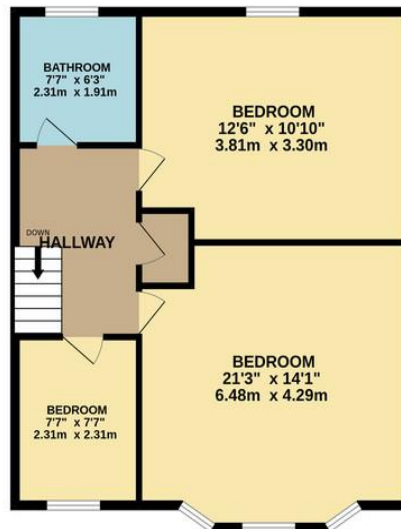

TOTAL FLOOR AREA: 1646 sq.ft. (152.9 sq.m.) approx.

Whilst every attempt has been made to ensure the accuracy of the floorplan contained here, measurements of doors, windows, rooms and any other items are approximate and no responsibility is taken for any error, omission or mis-statement. This plan is for illustrative purposes only and should be used as such by any prospective purchaser. The services, systems and appliances shown have not been tested and no guarantee as to their operability or efficiency can be given.
Made with Metropix ©2022

Energy Efficiency Rating		
	Current	Potential
Very energy efficient - lower running costs		
(92+) A		
(81-91) B		
(69-80) C		76
(55-68) D	59	
(39-54) E		
(21-38) F		
(1-20) G		
Not energy efficient - higher running costs		
England & Wales	EU Directive 2002/91/EC	

WWW.EPC4U.COM

Hiltons Estates, 137 Western Road
Southall, UB2 5HN

www.hiltons-estates.com
email: harvin@hiltons-estates.com
0208 867 9555 / 07961 527301

Agents Note: Whilst every care has been taken to prepare these sales particulars, they are for guidance purposes only. All measurements are approximate and for general guidance purposes only and whilst every care has been taken to ensure their accuracy, they should not be relied upon and potential buyers are advised to recheck the measurements.