

25
YEARS

SERVING
BEACONSFIELD
SINCE 1998



Flat 13, Lawnswood, Station Road, Beaconsfield

Guide Price £550,000

Ashington Page

An impressive two bedroom Penthouse apartment situated within a short walk to the amenities of Beaconsfield new town with train station, and half a mile from the centre of the bustling and historic Old Town. The property was built in 2008 to a high specification by Banner Homes and forms part of this small exclusive development of just 14 apartments.

Tenure: Leasehold 125 years from Jan 1st 2008 (110 years remaining) Service Charge: £2390.00 pa
EPC rating: C Council Tax Band: E
Sat Nav: HP9 1LW

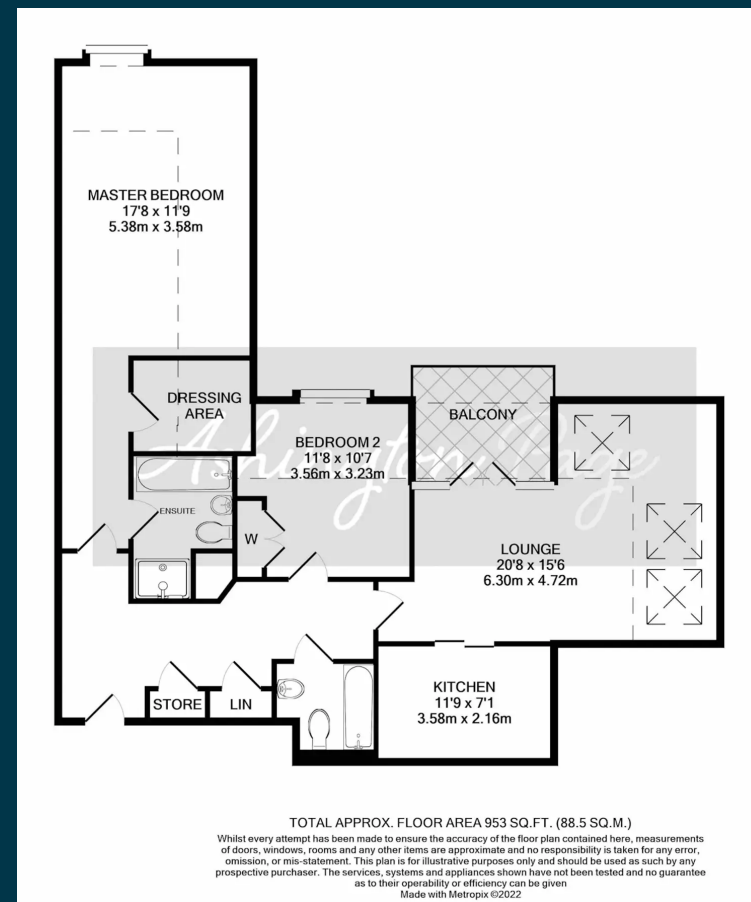

These particulars are for guidance only. They are prepared and issued in good faith and are intended to give a fair summary of the property. Any description should not be relied on as a statement or representation of fact or that the property, or its services, are in good condition. The photographs show only certain parts of the property at the time they were taken. Any areas, measurements or distance given are approximate only. Any reference to alterations to, or use of, any part of the property is not a statement that any necessary planning, building regulations or other consent has been obtained. These matters must be verified by an intending purchaser. All statements contained in these particulars in relation to the property are made without responsibility of Ashington Page or its clients. Neither Ashington Page (nor any joint agents) nor any of their employees has any authority to make or give any representation or warranty whatsoever in relation to the property



01494 680018
info@ashingtonpage.co.uk
www.AshingtonPage.co.uk

