

25  
YEARS

SERVING  
BEACONSFIELD  
SINCE 1998



36 Aylesbury End, Beaconsfield

Guide Price £425,000

*Ashington Page*



Nestled in the charming heart of Beaconsfield Old Town, this delightful 2-bedroom, 2 bathroom, mid-terraced house exudes character and charm. Boasting a perfect blend of modern comforts and historic allure, this well-presented property offers a cosy retreat for those seeking a quintessentially English living experience. The interior features two double bedrooms, with the principle bedroom benefiting from an en suite shower room, in addition to a family bathroom. Situated within walking distance to the station, this home is ideal for commuters looking for convenience without compromising on style. Freehold

EPC C

Council Tax Band D

These particulars are for guidance only. They are prepared and issued in good faith and are intended to give a fair summary of the property. Any description should not be relied on as a statement or representation of fact or that the property, or its services, are in good condition. The photographs show only certain parts of the property at the time they were taken. Any areas, measurements or distance given are approximate only. Any reference to alterations to, or use of, any part of the property is not a statement that any necessary planning, building regulations or other consent has been obtained. These matters must be verified by an intending purchaser. All statements contained in these particulars in relation to the property are made without responsibility of Ashington Page or its clients. Neither Ashington Page (nor any joint agents) nor any of their employees has any authority to make or give any representation or warranty whatsoever in relation to the property

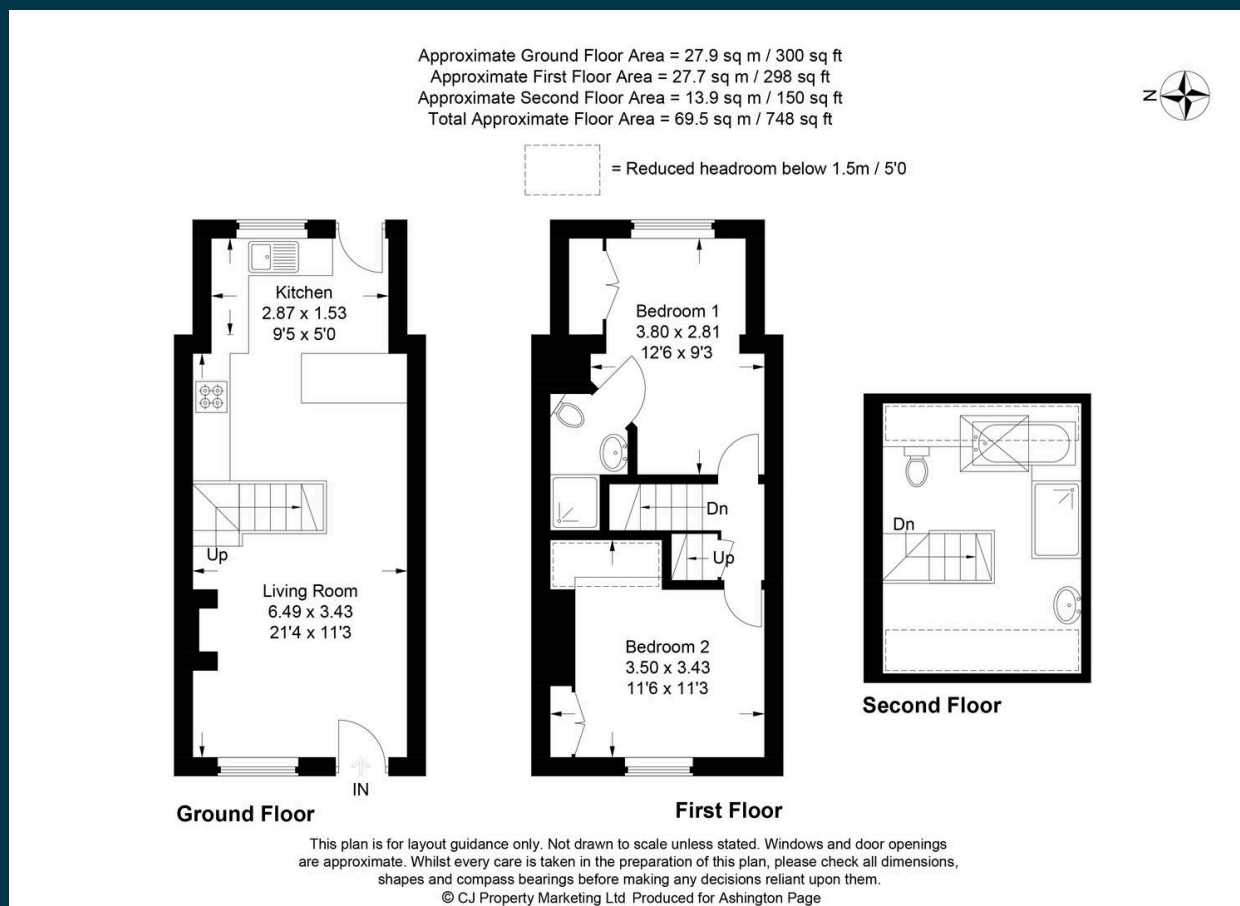

01494 680018  
[info@ashingtonpage.co.uk](mailto:info@ashingtonpage.co.uk)  
[www.AshingtonPage.co.uk](http://www.AshingtonPage.co.uk)

