



  
**Andrew Pearce**  
PINNER

HAZELDENE DRIVE, , HA5 3NH

£350,000



Andrew Pearce



This spacious 752sq.ft apartment is conveniently positioned off of the highly sought-after West End Lane and is just a few moments' walk from Pinner Village, Pinner Memorial Park and West Lodge School and therefore is ideal situated for family, first time buyers and investors.

Accommodation briefly comprises; security entry phone, stairs to the first floor, own front door, entrance hallway, newly fitted kitchen, spacious lounge, two double bedrooms and a newly fitted bathroom.

Situated off West End Lane, this property is just moments from Pinner high street and a vast selection of shopping facilities, restaurants, coffee houses and popular supermarkets. For commuters, Pinner station offers a frequent service into London via the Metropolitan line. There are also numerous local bus routes within the area.

The area is well served by local primary and secondary schooling, children's play area's and recreational facilities, including nearby Pinner Recreation Ground.



GROUND FLOOR  
752 sq.ft. (69.9 sq.m.) approx.

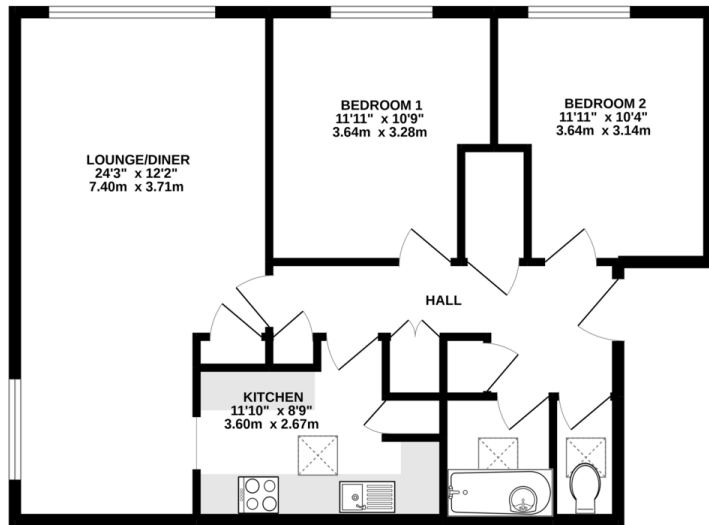

TOTAL FLOOR AREA: 752 sq ft. (69.9 sq.m.) approx.  
Whilst every attempt has been made to ensure the accuracy of the floorplan contained here, measurements of doors, windows, rooms and any other items are approximate and no responsibility is taken for any error, omission or mis-statement. This plan is for illustrative purposes only and should be used as such by any prospective purchaser. The services, systems and specifications shown have not been tested and no guarantee as to their operability or efficiency can be given.  
Made with Metropix ©2022



