



4 Bedroom Town House Offers In Excess Of £400,000

15 Maizey Road, Tadpole Garden Village, Swindon, SN25 2RP

mcfarlane
property.com

4 Bedroom Town House

Swindon, North Swindon

-
- Semi detached
 - Overlooking Allotments
 - Four Bedrooms
-

Overlooking the allotments in Tadpole Garden Village. If you're looking for flexible living this family home is perfect. The vendors have created on the ground floor a great living room/kitchen and double bedroom with en-suite perfect for an elderly relative or teenager. The living room and kitchen/dining room are on the first floor so no need to keep going downstairs to the kitchen. On the second floor there is the master bedroom with en-suite, two further bedrooms and a family bathroom. Externally there is an attractive low maintenance rear garden and garage with driveway tandem parking for two vehicles.

Tadpole Garden Village is a visionary development in North Swindon, Wiltshire, providing a variety of different character areas with traditional and contemporary quality new homes for a sustainable, healthy community.









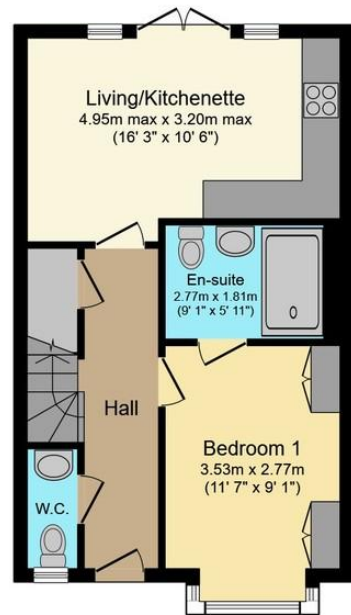

Ground Floor

Floor area 42.4 sq.m. (457 sq.ft.) approx

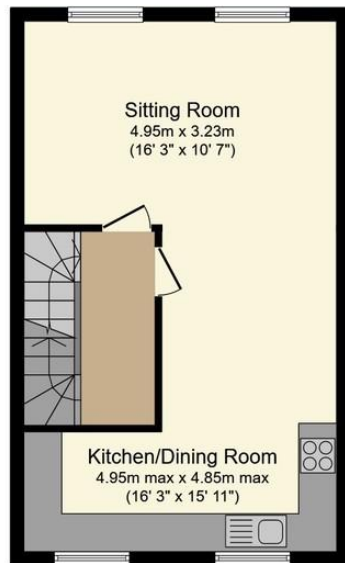

First Floor

Floor area 41.5 sq.m. (447 sq.ft.) approx

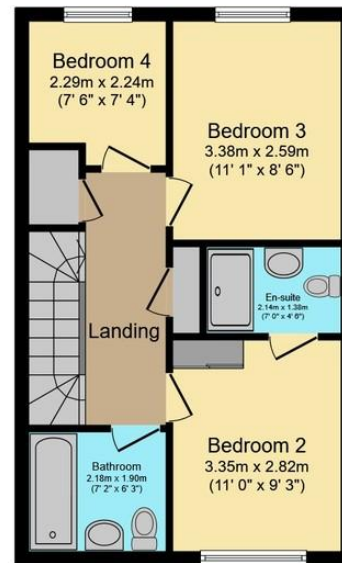

Second Floor

Floor area 41.5 sq.m. (447 sq.ft.) approx

Total floor area 125.5 sq.m. (1,351 sq.ft.) approx

This Floor Plan is for illustration purposes only and may not be representative of the property. The position and size of doors, windows and other features are approximate. Unauthorized reproduction prohibited. © PropertyBOX

We 
where you
LIVE

Our team are friendly, experienced and are all local. They know it better than they do their own living rooms and can help you find what you're looking for because **we love where we live.**

We would be delighted to show you around this property.

**Because every home
needs a personal touch.**

Paul Gregory
Sales Manager, Marlborough



☎ 01672 216057

✉ paul@mcfarlaneproperty.com

mcfarlaneproperty.com

mcfarlane
property.com

Marlborough.
106 High Street
Marlborough SN8 1LT
☎ 01672 514380

North Swindon.
The Village Centre,
Redhouse SN25 2FW
☎ 01793 296880

Old Town.
28-30 Wood Street
Swindon SN1 4AB
☎ 01793 296880

Cricklade.
102 High Street
Cricklade SN6 6AA
☎ 01793 751044

Agents Note: Whilst every care has been taken to prepare these sales particulars, they are for guidance purposes only. All measurements are approximate are for general guidance purposes only and whilst every care has been taken to ensure their accuracy, they should not be relied upon and potential buyers are advised to recheck the measurements

