



David Astburys



Stapleton Hall Road, Stroud Green N4
£475,000
Leasehold

15 Park Road, Crouch End, London, N8 8TE
davidastburys.com
0203 000 6787 | sales@davidastburys.com

15 Park Road, Crouch End, London, N8 8TE
davidastburys.com
0203 000 6787 | sales@davidastburys.com

- 710 Square Feet
- Split Level Top Floor Flat
- Victorian Conversion
- South Facing Terrace
- Panoramic Views of the City
- Eaves Storage
- Work From Home Space
- 0.4 miles of Crouch hill station



Stapleton Hall Road, N4

Approximate Gross Internal Area = 710 sq ft / 66 sq m

 = Reduced headroom below 1.5m / 5'0"

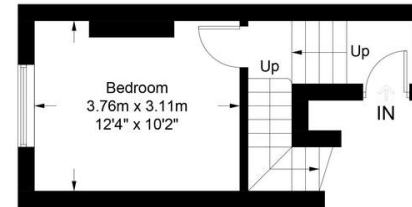

First Floor



Second Floor



This plan is for layout guidance only. Not drawn to scale unless stated. Windows and door openings are approximate. Whilst every care is taken in the preparation of this plan, please check all dimensions, shapes and compass bearings before making any decisions reliant upon them. (ID86744)

Agents Note: Whilst every care has been taken to prepare these sales particulars, they are for guidance purposes only. All measurements are approximate and are for general guidance purposes only and whilst every care has been taken to ensure their accuracy, they should not be relied upon and potential buyers are advised to recheck the measurements.

