



Property Summary

A beautifully presented two bedroom mid-terraced property ideally located within the sought after Wigston Harcourt location. The property comprises of entrance porch, kitchen, lounge, conservatory to the ground floor. The first floor lays host to two bedrooms as well as the family bathroom. Outside of the property benefits from a paved driveway and to the rear of the property is an easy-to-maintain rear garden. Call Phillips George on 01162168178 to book your viewing.



GROUND FLOOR
371 sq.ft. (34.5 sq.m.) approx.

1ST FLOOR
240 sq.ft. (22.3 sq.m.) approx.

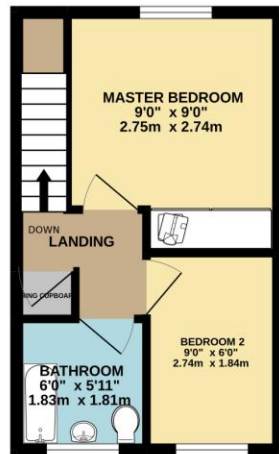
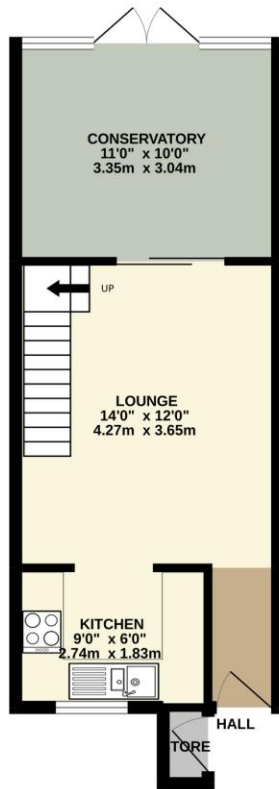

TOTAL FLOOR AREA: 611 sq.ft. (56.8 sq.m.) approx.

Whilst every attempt has been made to ensure the accuracy of the floorplan contained herein, measurements of doors, windows, rooms and any other items are approximate and no responsibility is taken for any error, omission or mis-statement. This plan is for illustrative purposes only and should be used as such by any prospective purchaser. The services, systems and appliances shown have not been tested and no guarantee as to their operability or efficiency can be given.
Made with Metropia ©2022

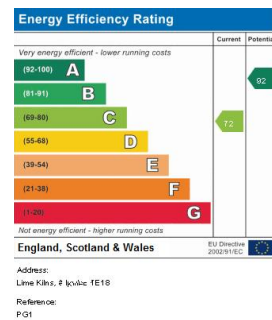

- Two Bedrooms
- Well Presented Throughout
- Quiet Cul-De-Sac Location
- Allocated Parking
- Perfect First Time Buy!
- Sought After Location
- Ideal Investment Opportunity
- Easy To Maintain Garden

phillips george | sales & lettings

Agents Note: Whilst every care has been taken to prepare these sales particulars, they are for guidance purposes only. All measurements are approximate and for general guidance purposes only and whilst every care has been taken to ensure their accuracy, they should not be relied upon and potential buyers are advised to recheck the measurements.

46 Long Street, Wigston, Leicestershire, LE18 2AH

info@phillipsgeorge.co.uk
0116 216 8178

