

## 22 St Marys Court | Plympton | Plymouth | PL7 4PE

£795 pcm

A first floor flat situated within a popular location.

This purpose built two bedroom flat is located within walking distance of Plympton's Ridgeway shopping area, offering a wide range of shops and facilities, there are local primary and senior schools also within a short walk.

Public transport and access to the A38 are easily achieved.

Accommodation comprises, entrance lobby, entrance hall, open plan living room, kitchen, double bedroom, single bedroom, shower room and outside there is allocated parking and communal gardens.

- Two Bedrooms
- Open Plan Living Room
- Purpose Built First Floor Flat
- Kitchen
- Shower Room
- Allocated Parking
- Close To Facilities
- Popular Location



GROUND FLOOR

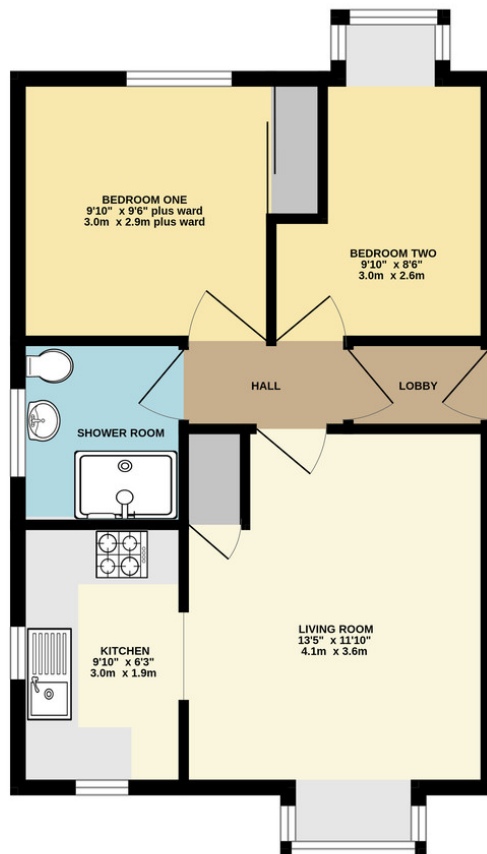

## Contact Details

48 Ebrington Street  
 Plymouth  
 Devon  
 PL4 9AD

www.athomelettings.com  
 info@athomeproperty.co.uk  
 01752 777070

Energy Efficiency Rating		Current	Potential
Very energy efficient - lower running costs			
(92+)	A		
(81-91)	B		
(69-80)	C	77	80
(55-68)	D		
(39-54)	E		
(21-38)	F		
(1-20)	G		
Not energy efficient - higher running costs			
<b>England &amp; Wales</b>		EU Directive 2002/91/EC	

Agents Note: Whilst every care has been taken to prepare these sales particulars, they are for guidance purposes only. All measurements are approximate are for general guidance purposes only and whilst every care has been taken to ensure their accuracy, they should not be relied upon and potential buyers are advised to recheck the measurements