



Charlestown Road, Paignton, TQ3 3FY
Guide Price: £285,000 Tenure: Freehold



Charlestown Road, Paignton, TQ3 3FY

Well presented modern family home, lovely landscaped rear garden and off road parking for two cars

- Smartly presented semi detached family home
- Located in quiet cul de sac within popular residential area
- Modern fitted kitchen/diner opening into garden
- Lounge to front
- Ground floor cloakroom and first floor family bathroom
- Three bedrooms, main bedroom with en-suite shower room
- Professionally landscaped rear garden
- Integral garage plus off road parking for two vehicles
- Remainder of NHBC guarantee
- EPC rating - B.



Semi detached house with many appealing features. Contemporary fitted kitchen/diner with patio doors opening into the rear garden which enjoys a good degree of privacy. Level gardens that have been carefully landscaped to include good sized patio area and low maintenance artificial lawn.

Entrance foyer opening into lounge, separate kitchen/diner with integrated appliances. Useful ground floor cloakroom. First floor arranged with three good sized bedrooms, the main bedroom has a contemporary fitted en-suite shower room. There is also a family bathroom and useful storage cupboard. Integral garage plus off road parking for two cars. Access to side of property and rear garden.



Located in a popular residential area within a quiet cul de sac. Easy access out of town the local area offers childrens play park, access to open countryside popular with dog walkers and regular bus service. The town centre and beach is approximately two miles distant. Paignton town centre offers a range of shopping plus cafes, bars and restaurants. There is a lovely sandy beach, pleasure green, pier and picturesque harbour.



What3Words

UPRN:

<https://w3w.co/fell.garden.arch>

agents notes:

annual service charge TBC

Ground Floor

Approx. 48.9 sq. metres (526.3 sq. feet)

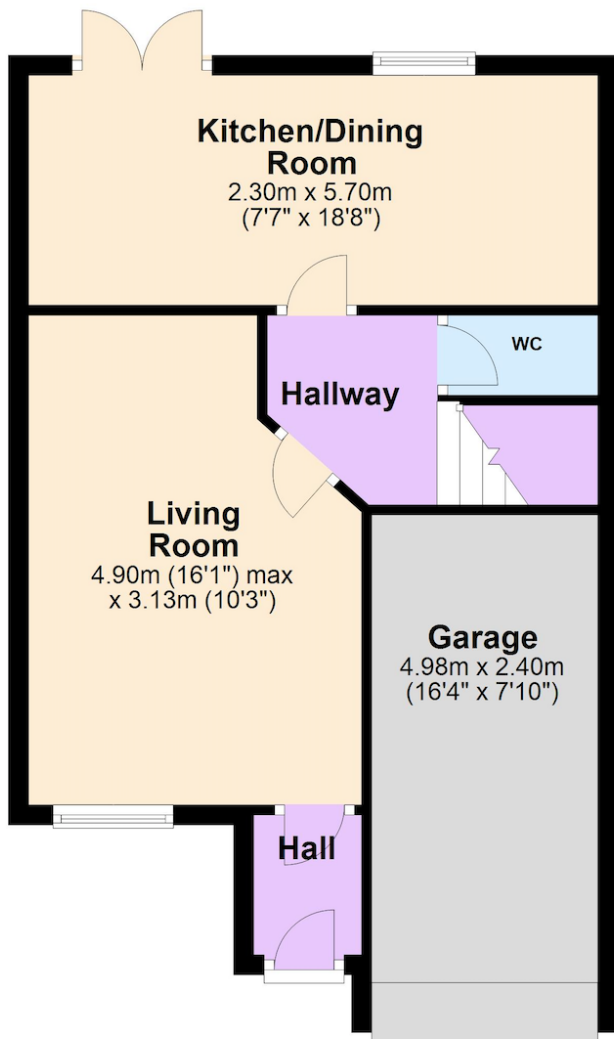

First Floor

Approx. 41.8 sq. metres (449.6 sq. feet)

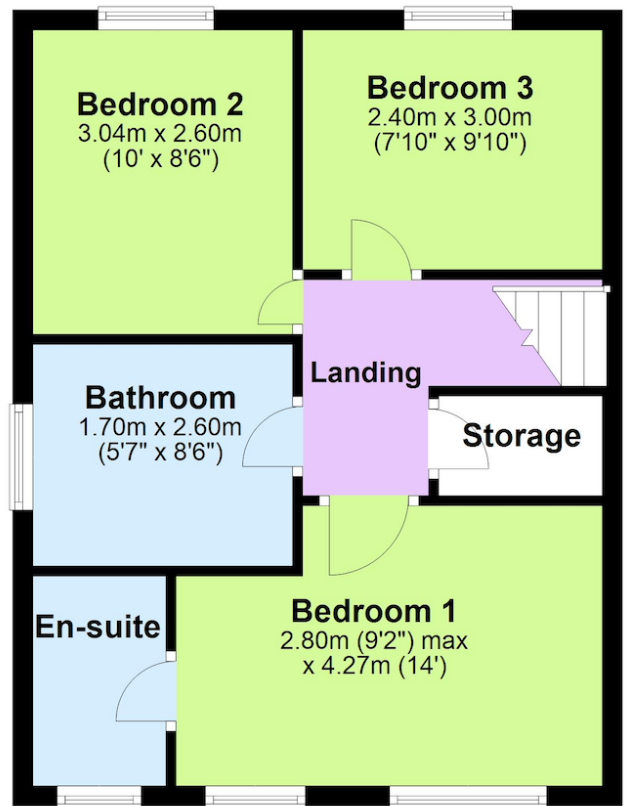

Have a property to sell or let?

If you are considering selling or letting your home, get in contact with us today on 01803 214214 to speak with one of our expert team who will be able to provide you with a free valuation of your home.



We refer potential purchasers to Sheehan Legal for conveyancing, Greenlight Mortgages for mortgages, McCluskey Surveyors for surveying & Team Removals for removals. It is your decision if you choose to deal with any of these companies however should you choose to use them we would receive a referral fee from them for recommending you to them as follows: Sheehan Legal £150, Greenlight Mortgages £50 to £300, McCluskey Surveyors £50, Team Removals £50. We have carefully selected these associates for the quality of their work and customer service levels.

Consumer Protection Regulations: We have not tested any apparatus, equipment, fixtures and fittings or services and so cannot verify that they are in working order or fit for the purpose. References to the Tenure of a Property are based on information supplied by the seller. We have not had sight of the Title Documents. A buyer is advised to obtain verification from their solicitor or surveyor. Floorplans shown are for guidance only and should not be relied upon. Items shown in photographs are NOT included unless specifically mentioned within these details. They may however be able by separate negotiation. You are advised to check the availability of this property before travelling any distance to view. Particulars are produced in good faith to the best of our knowledge and are set out as a general guide only.

