



Flat 18, Redvers House Union Road, Crediton, EX17 3AW

Guide Price £57,000

HELMORES
SINCE 1699



This south-facing retirement apartment is found on the 1st floor with access provided by a lift and 2 staircases serving all floors. Redvers House is centrally located with the High Street's shops and cafés and bus transport links both close to hand.

The flat itself includes a living room with an opening through to the kitchen, a double bedroom (which has built in wardrobes) and the bathroom. The property has uPVC windows to the front and electric radiators and is naturally warm and light due to its position on the front (south facing side) of the building.

There is a scheme manager regularly on site, emergency cords in most rooms, guest accommodation for family visits, a laundry area and limited parking to the rear. The property is leasehold and has a 125 year lease from 1985.

Please see the floorplan for room sizes.

Council Tax: A

Utilities: Mains electric, water, telephone & broadband

Fastest broadband speed within this postcode: Up to 67Mbps

Drainage: Mains drainage

Heating: Electric heating

Listed: No

Tenure: Leasehold - 125 years from 1985 Monthly service charge is approx. £235 and includes ground rent, insurance, warden, upkeep of communal areas (inc lift and laundry)

DIRECTIONS: Redvers House is located between Crediton High Street & the war memorial, on Union Road opposite the iron railings.



Ground Floor

Approx. 47.9 sq. metres (515.4 sq. feet)

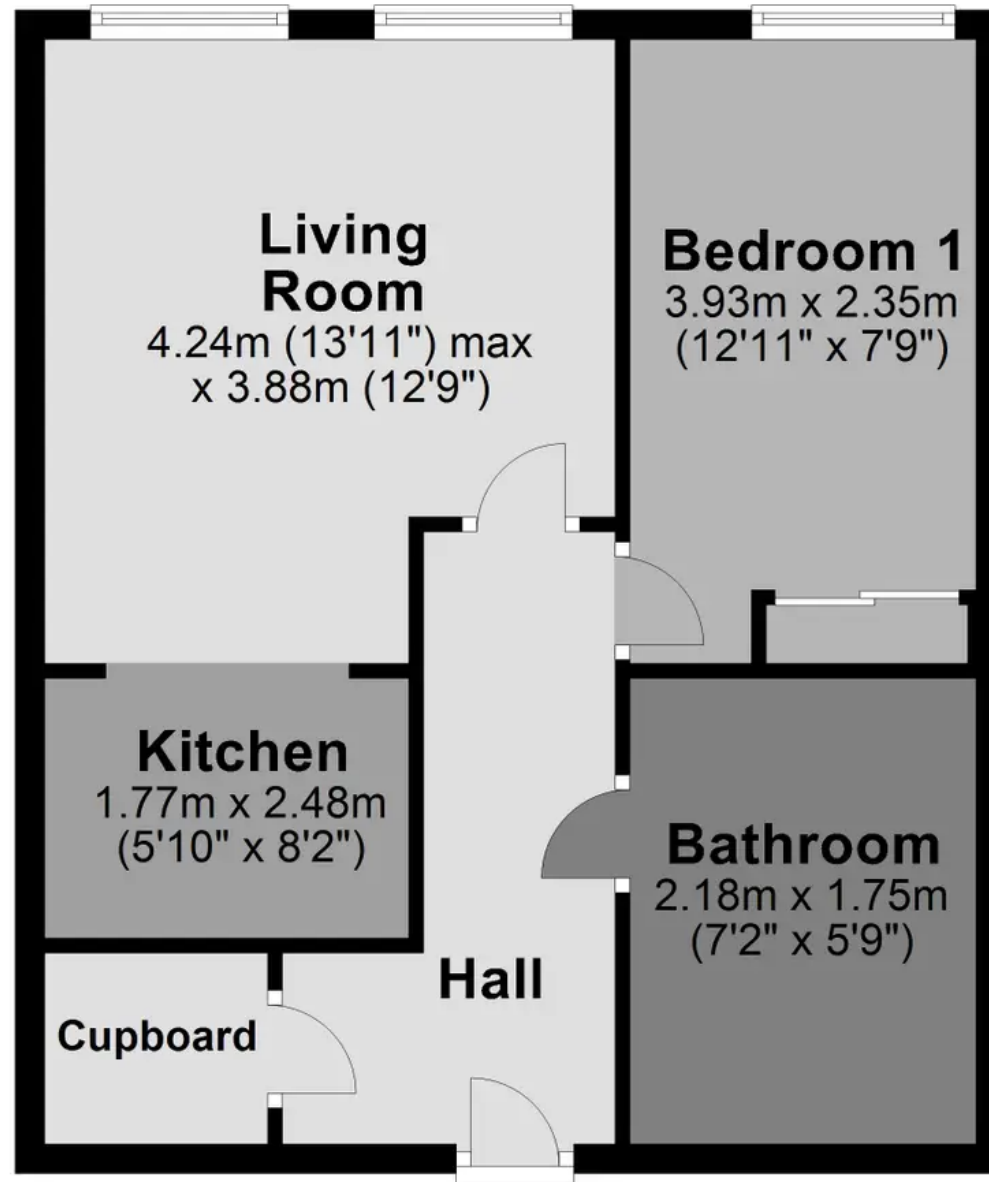

Total area: approx. 47.9 sq. metres (515.4 sq. feet)



Helmores

Helmores, 111-112 High Street - EX17 3LF

01363 777 999

property@helmores.com

<https://helmores.com/>

HELMORES
SINCE 1699

These particulars are intended to give a fair and reliable description of the property but no responsibility for any inaccuracy or error can be accepted and do not constitute an offer or contract. We have not tested any services or appliances (including central heating if fitted) referred to in these particulars and the purchasers are advised to satisfy themselves as to the working order and condition. If a property is unoccupied at any time there may be reconnection charges for any switched off/disconnected or drained services or appliances - All measurements are approximate.