



Cross Farm, Poughill

Guide Price £825,000

HELMORES
SINCE 1699

Cross Farm

Poughill, Crediton

A beautiful 2003/2004 built farmhouse style detached house, in a quiet village setting with stunning views, superb accommodation (200sqm/2,200sqft), plus south-facing gardens, enclosed paddock, double garage, ample parking & detached outbuilding.

Council Tax band: E

Tenure: Freehold

- Beautiful 2003/04 Built Farmhouse Style Home
- Large outbuilding - Scope for ancillary accommodation (STP)
- Ample parking for numerous vehicles & double garage
- Family bathroom, en-suite & GF shower room
- Sunroom, kitchen diner, larder & utility room
- Superb accommodation of 200sqm / 2,200sqft
- Paddock, south-facing gardens & views
- Four double bedrooms & study/5th bed
- Spacious living room with wood-burner
- Underfloor heating & no onward chain



HELMORES
SINCE 1699



GARDEN

Large Garden

GARAGE

Double Garage

OFF ROAD

3 Parking Spaces



HELMORES
SINCE 1699

GARDEN

Large Garden

GARAGE

Double Garage

OFF ROAD

3 Parking Spaces



Ground Floor

Approx. 115.6 sq. metres (1244.8 sq. feet)

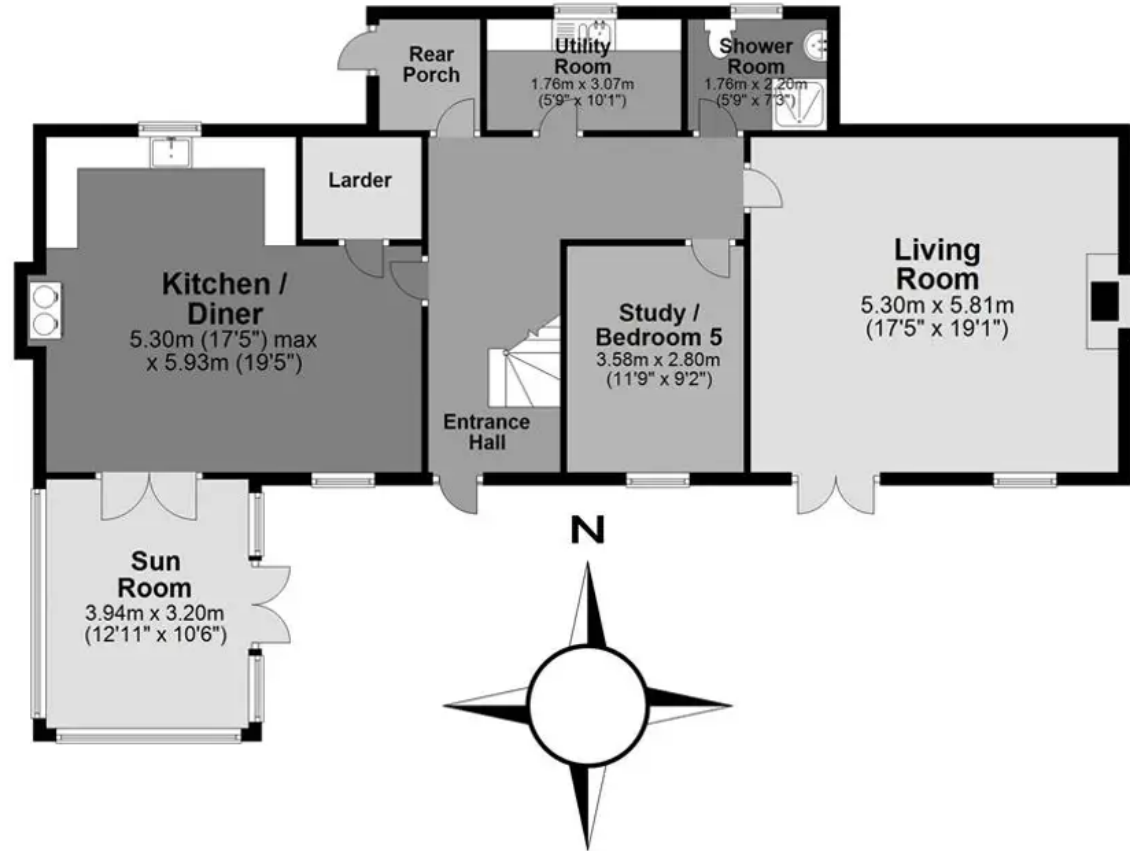

First Floor

Approx. 88.0 sq. metres (947.2 sq. feet)

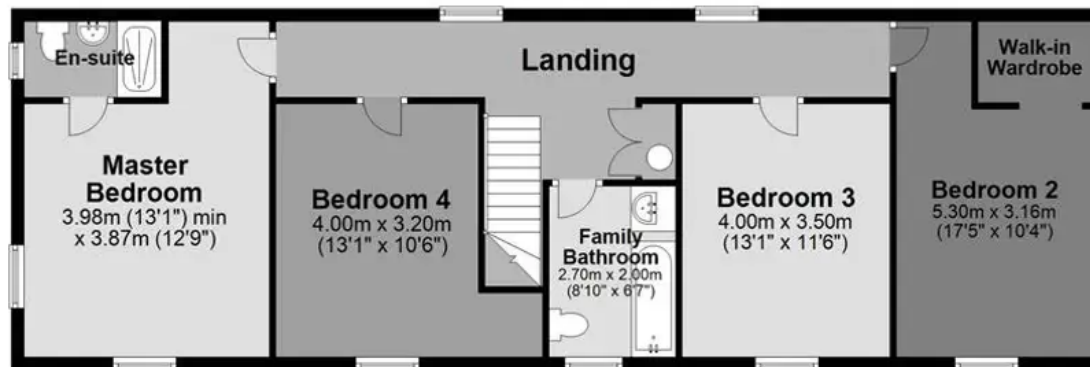

Total area: approx. 203.6 sq. metres (2192.0 sq. feet)

HELMORES
SINCE 1699



Helmores

Helmores, 111-112 High Street - EX17 3LF

01363 777 999

property@helmores.com

helmores.com/

HELMORES
SINCE 1699

These particulars are intended to give a fair and reliable description of the property but no responsibility for any inaccuracy or error can be accepted and do not constitute an offer or contract. We have not tested any services or appliances (including central heating if fitted) referred to in these particulars and the purchasers are advised to satisfy themselves as to the working order and condition. If a property is unoccupied at any time there may be reconnection charges for any switched off/disconnected or drained services or appliances - All measurements are approximate.