





Property Summary

New to the market is this desirable, two-bedroom top floor flat situated on Limes Grove, central SE13. Lewisham High Street and the great rail connections are on your doorstep. Available from Mid-December. Furnished.

Property Features

- TWO BEDROOMS
- MODERN FLAT
- LIVING ROOM
- SEPARATE KITCHEN
- BATHROOM
- TOP FLOOR
- FURNISHED
- LEWISHAM STATION & DLR 0.5 MILE
- LADYWELL STN & VILLAGE 0.5 MILE
- HITHER GREEN STN & VILLAGE 0.6 MILE





Tedman Court

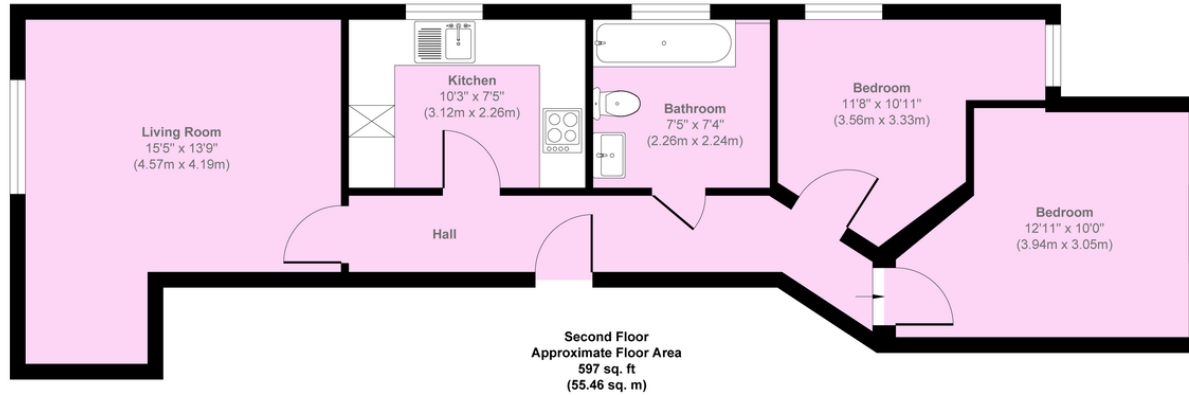

Approx. Gross Internal Floor Area 597 sq. ft / 55.46 sq. m

Illustration for identification purposes only, measurements are approximate, not to scale.
Copyright © markbeaumont.com
Produced by Elements Property

Score	Energy rating	Current	Potential
92+	A		
81-91	B		
69-80	C	78 c	78 c
55-68	D		
39-54	E		
21-38	F		
1-20	G		

197 South London Branch, Lewisham
High Street, London, SE13 6AA

www.markbeaumont.com
lettings@markbeaumont.com
020 8852 5000

Agents Note: Whilst every care has been taken to prepare these particulars, they are for guidance purposes only. All measurements are approximate and are for general guidance purposes only and whilst every care has been taken to ensure their accuracy, they should not be relied upon and we advise to recheck the measurements. All inclusive tenancy start-up fee £399. Includes: VAT, References, Administration Charge, Tenancy Agreement, (up to 2 tenants). Additional Tenants charged at £150 inclusive, per additional tenant. Guarantor fee's: £150 per guarantor. (Where necessary). Check out fee from £80 - £120 depending on the size of the property. Ask for a scale of charges in branch. Holding Deposit: £200